

FITTING INSTRUCTION FOR ALR LAP BELTS

INSTALLERS OF SEAT BELTS ARE SPECIALLY REQUESTED TO LEAVE THESE INSTRUCTIONS IN THE VEHICLE SO THAT THE OWNER MAY READ THEM.

Thank you for purchasing a APV Safety Product. All our industrial retractable lap belts have been tested and certified to AS/NZS 2664, ISO 6683, SAE J386 and FMVSS 302. This is your assurance of the quality and if installed in accordance with the enclosed instructions, will provide the required degree of protection to the wearer in most accidents. We are the major original equipment supplier of seat belts in Australia and strive to present to the Australian consumer the best products in quality and performance.

THE AUTOMATIC LOCKING RETRACTOR (ALR) SEAT BELT:

The Automatic Locking Retractor retracts the webbing to the body after the tongue and buckle are engaged. This type of seat belt automatically locks when the mechanism is activated after a certain amount of webbing is withdrawn from the spool.

A firm sharp tug on the webbing will lock the belt and testing can be carried out by this procedure.

No modifications or additions should be made by the user which will prevent the seat belt adjustment devices from operating to remove slack.

SPECIFICATIONS

WEBBING LENGTH:	1.2mtrs FULLY EXTENDED	
WEBBING WIDTH:	2 OR 3 INCH	
WEBBING COLOUR:	BLACK	
MOUNTING:	7/16 UNF BOLT	
ANGLE:	UNIVERSAL	
ELECTRIC BUCKLE:*	BLUE WIRE	NORMALLY CLOSED
	BLACK WIRE	NORMALLY OPEN
	RED WIRE	COMMON
LOAD RATING:	2A at 12V	

ALR LAP BELT INSTALLATION

1. Assemble Retractor side as shown in figure 1.
2. For vehicles or applications without an in-built anchorage, select an appropriate location clear of any obstruction and mount as per Figure 2 using APV Reinforcing kit part K2887 or equivalent.
3. Tighten all bolts securely to a torque of 25-30 lbft (35-40 Nm).

* See over page Figure 5

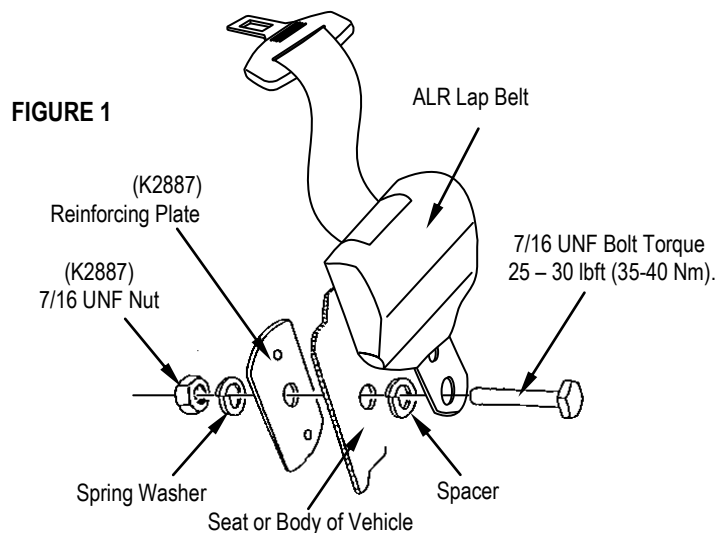

BUCKLE INSTALLATION

1. Assemble buckle as shown in figure 2, 3 & 4.
2. Ensure the buckle head is at the hip or below to prevent possible injury.
3. For vehicles or applications without an in-built anchorage, select an appropriate location clear of any obstruction and mount as per Figure 1 using APV Reinforcing kit part K2887 or equivalent.
4. Tighten bolts securely to a torque of 25-30 lbft (35-40 Nm).

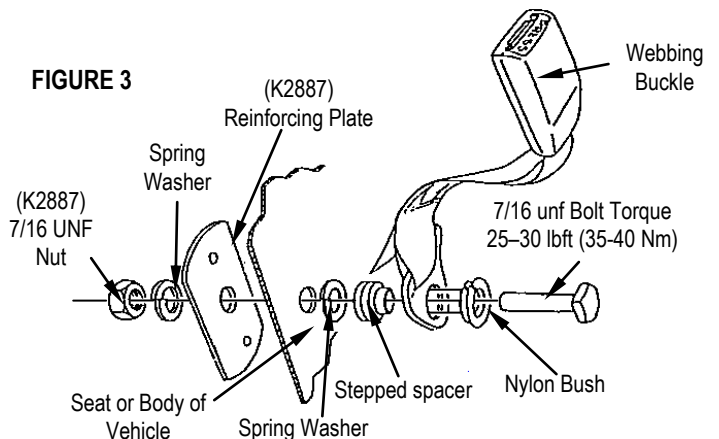
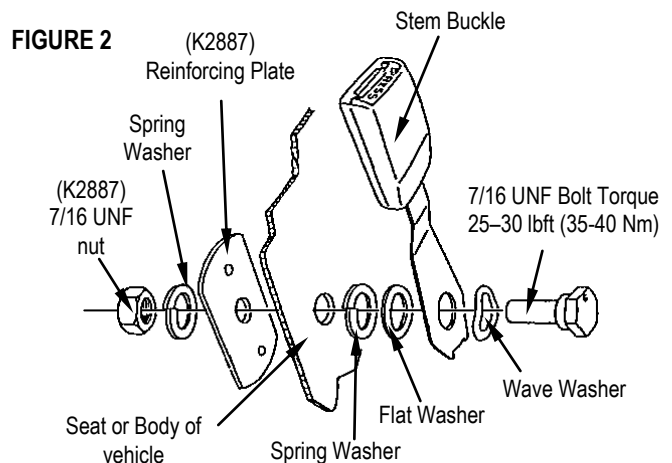

FITTING INSTRUCTION FOR ALR LAP BELTS

CONTINUED

FIGURE 4

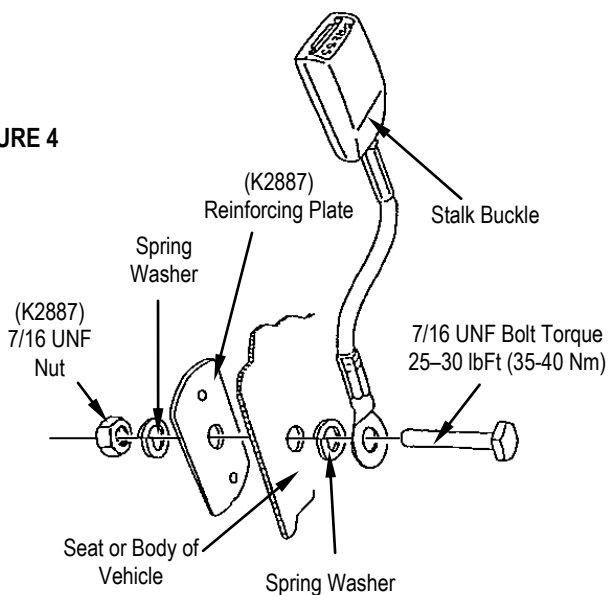

Fatal accidents can occur within short time frames and at low speeds. There is no doubt that seat belts, correctly worn, can reduce the incidence of fatalities and serious injury. Your seat belt will give you valuable protection, but IT IS YOUR RESPONSIBILITY IN THE INTERESTS OF YOUR OWN SAFETY TO OPERATE YOUR MACHINERY CAREFULLY AT ALL TIMES.

FIGURE 5

NOTE:
ELECTRICAL LOOM
OPTIONAL ON ONLY
STEM OR STALK
BUCKLES.

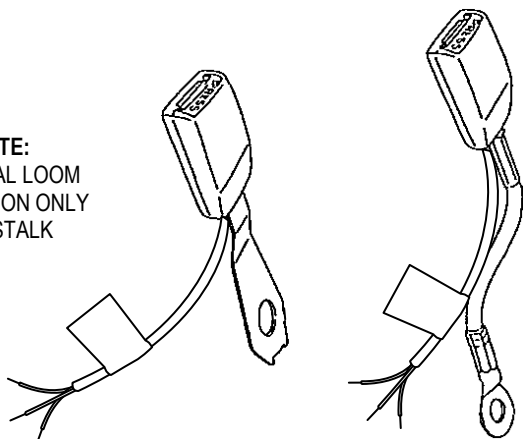

HOW TO WEAR YOUR SEATBELT CORRECTLY

Check that the buckle is correctly located at the hip point. Smoothly withdraw the webbing from the retractor and extend towards the buckle. It should pass across your pelvic area. Be comfortable, but "too tight" is better than "too loose". Wearing of the lap belt across the abdominal area must be avoided.

"Buckle Up" by sliding the tongue into the slot at the open end of the buckle. It is correctly engaged when you hear a positive "click".

The retractor should be locked but checking is required by pulling on the webbing. To release the belt, push the button in the centre of the buckle while applying a slight forward body pressure.

SEAT BELT STOWAGE: ALR LAP BELTS

The seat belt when not in use should be stowed away by allowing the tongue to retract fully towards the retractor.

Your seat belt has been designed and manufactured to very strict standards. In your own interests you should WEAR IT AT ALL TIMES when operating your machine, even for short periods.

WARNING!

- Where possible have the assembly installed by a competent mechanic at a fitting station.
- Do not make any alterations or additions to the belt.
- No excessive slackness in the belt should be evident.
- Webbing must not be allowed to chafe against sharp edges on seat or bodywork. Any fraying of webbing will reduce the strength and retraction performance of the seat belt and the seat belt assembly should be replaced.
- Do not drill additional mounting holes in vehicle with inbuilt anchorages.
- Do not attach the belt assembly to unsound metal or to wood or plastic structures.
- Do not bleach or dye under any circumstances.
- Avoid contamination of the webbing with polishes, oils and chemicals and particularly battery acid.
- Cleaning may safely be carried out using mild soap and water.
- Do not replace a stalk or stem buckle with a webbing buckle.
- Do not attach the seat belt assembly to a vehicle seat or seat mounting bolts, unless the vehicle manufacturer has provided seat belt anchorages in the seat, or uses the seat anchor bolts for this purpose.
- After installation, please ensure that bolts are securely tightened and there are no apparent loose or ill-fitting parts present. Also check that the webbing in the ALR Lap belt will pay out and retract fully.
- Belts should not be worn with straps twisted.
- Each seat belt assembly must be worn by only one occupant; it is dangerous to put a belt around a child being carried on an adult's lap.
- It is essential that the entire assembly be replaced if it has been worn during a severe impact, even if damage to the assembly is not obvious.
- The belt should be replaced if webbing becomes frayed, contaminated or damaged.

**NOTE: THERE MAY BE MORE FITTINGS THAN NEEDED.
PLEASE DISCARD UNUSED FITTINGS.**