



# Hipac

We're here for life



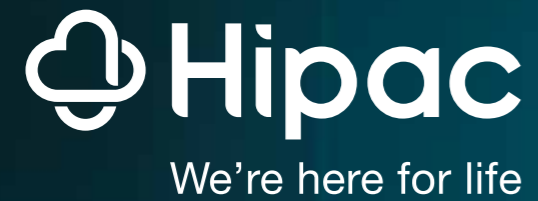

## AT RISK PATIENT PROTECTION PRODUCTS

### PRODUCT CATALOGUE





#### Leaders in:

-  Operating tables and accessories
-  Lights, booms and integration
-  Clinical stainless steel furniture
-  **At risk patient protection products**
-  Clinical consumables

## AT RISK PATIENT PROTECTION PRODUCTS

At Hipac we're here to protect the lives of the most vulnerable in our communities, as well as those who care for them.

We offer a unique range of At Risk Patient Protection Products, designed to prevent and reduce the risks of ligature and barricade scenarios within mental health facilities.

Our supplier and product development network encompasses the whole globe to ensure our portfolio contains the best and most innovative solutions available at any given point in time.

So, if you are looking for advice regarding high quality, market tested anti-ligature and anti-barricade products, make contact today by phone on 1800 75 93 93 or email us via [info@hipac.com.au](mailto:info@hipac.com.au).

## CONTENTS

- 4** About Hipac
- 6** Safe Mental Health Environments
- 8** Guide to Locksets & Handles
- 12** Guide to Hinges & Removable Stops
- 14** Bedroom Door Products
- 38** Bathroom/En-suite Door Products
- 54** Locksets for Other Applications
- 60** Bedroom & Bathroom Products
- 80** Ancillary Hardware Items
- 82** Keys, Tools & Fasteners
- 84** Index
- 90** How Can We Help?
- 91** General Information



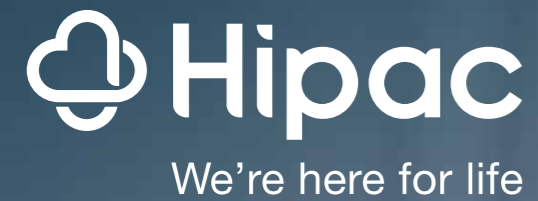

## MINIMISING THE RISK AND HELPING YOU BEST DELIVER YOUR DUTY OF CARE

At Hipac we believe that every sentinel event in a healthcare facility and the inevitable review that follows, is one too many. This is why we have made it our charter, to do everything within our capabilities to reduce the possibility of these incidents occurring in Australia.

Why? Because at Hipac, **we're here for life.**

In fact, according to the Clinical Excellence Commission of NSW<sup>1</sup>, national inpatient unit suicides have significantly reduced year-on-year since 2013-14. While we don't attribute this solely to innovations in the market, we are confident that our products are directly affecting improved patient outcomes.

For over 14 years, our consultants have been working closely with key personnel from public, private, and not for profit healthcare organisations, their development teams and all other related stakeholders, to bring industry and healthcare providers together, to deliver the very best healing, normalised, mental health environments.

We facilitate this through the development and promotion of engineered solutions that offer an additional layer of protection to what can be provided by clinical oversight and risk management systems and procedures. We do this while remaining intelligent and considerate of architectural challenges and the need to respect the rights and privacy of every individual.

We offer a suite of products and services which include:

- Anti-ligature consulting
- Site audits
- Anti-ligature/anti-barricade products
- Mental Health specific installation, fitout and construction services

Our consultants are highly skilled and trained, with specific expertise around anti-ligature and anti-barricade challenges in mental health environments.

So if you are looking for assistance to help you bring your facility in line with international best practice, make contact today on 1800 759 393 or via email at [info@hipac.com.au](mailto:info@hipac.com.au).

## Hipac at risk patient protection products

- ✓ Market leading products, sourced from globally recognised leaders of anti-ligature and anti-barricade solutions
- ✓ Made or sourced, using high quality, robust materials, to withstand the rigours of mental health environments
- ✓ Where possible, products are manufactured in-house, here in Australia, by Hipac.
- ✓ Designed with ease of use in mind for patients and clinicians in Mental Health environments
- ✓ Covered by Hipac's unwavering guarantee to stand behind all our medical products.

If you're looking for proven, high quality, market tested products, speak with one of our consultants today.

P. 1800 75 93 93  
E. [info@hipac.com.au](mailto:info@hipac.com.au)  
W. [hipac.com.au](http://hipac.com.au)

## A Safe Environment

Providing a safe and aesthetically pleasing environment in a Mental Health Facility has always been a design and clinical challenge. This has been made more difficult given the demand for 'normalisation' - the need to create a homely, less institutional environment, yet still providing a high level of staff and patient safety. Traditionally safety has taken precedence over aesthetics and the appearance has been somewhat abandoned. In recent years, it has been proven that the normalisation of patient surroundings, including the provision of a substantial level of privacy and dignity, is essential for a faster recovery.

## What are the Risks?

Areas within mental health facilities that offer the greatest risk of injury, self-harm or suicide are doorways, window openings and their associated fixtures and hardware. This especially applies to closed rooms such as a bathroom or bedroom which may be out of the sight of carers. Statistics have demonstrated that the most frequent method of suicide is by hanging or strangulation. According to the Australian Bureau of Statistics this method accounts for over half of deaths by suicide in Australia. The most prominent risks within patient areas is the presence of ligature points and the ability for a patient to barricade themselves (with or without hostages) away from staff access and assistance.

## Minimising the risk

It remains a duty of care to ensure that patients are cared for and accommodated in the safest environment possible. The unique range of Hipac solutions which have been designed exclusively for Mental Health Facilities, Rehabilitation and Detention Centres, adds style and character without compromising safety, functionality or quality. Hipac door hardware products integrate to offer the most comprehensive Anti-Ligature, Anti-Barricade Override System available internationally. This allows staff complete access through locked or barricaded doorways. Hipac solutions do more than just remove the risk - they provide improved levels of emergency access in time-critical situations.

At Hipac we are committed to providing market leading products to suit every application. We carry an extensive range of established products in stock, however we have the ability to modify, adapt, source or create a solution for your unique situation.

Hipac is your partner in care.

## Features of At Risk Patient Protection Products

The nature of design and innovation in global mental healthcare, is developing regularly to meet the changing needs and demands of Department Managers along with advancement in the understanding of best practice, for delivering on clinical duty of care. Detailed below, along with a brief description, are the features pertaining to products that can be used within mental health facilities;

### Load Release Anti-Ligature

Load release anti-ligature systems are a simple yet effective way of reducing or eliminating ligature risks and can be used for a range of fixtures within patient areas. There are several mechanisms now available that can achieve the load release function, however the basic principle remains the same; when an abnormal load is applied, such as an attempted ligature, the fixture will release, negating the risk of ligature. This is useful for fixtures that by their very nature would provide a ligature risk e.g. curtain tracking, towel rails, coat hooks, etc. When considering load release products, it is important you consider what implications the product might have once released. In a low acuity environment these products can be ideal however should be used with caution in a high acuity area as the release product could potentially be used as a weapon or projectile. It is also important to consider how easy it is for released products to be reattached. With the systems Hipac offers, it is as simple as pushing the product back into the holding bracket until it clicks into place or until the magnets take hold.

### Fixed Anti-Ligature

These items are generally items that are required to bear weight or strain such as a grabrail, or a door handle. As it is not an option for these products to release under an abnormal load, the ligature risk is eliminated by designing it in such a way that it is not possible for a cord-like object to be looped or tied around it.

### Weaponry Deterrent

Items that can be removed from their intended location by force, such as a curtain rail, could potentially be used as a weapon for a patient to harm themselves or others. Whilst staff members are trained to overcome confrontation with violent patients, it is ideal to further minimise this risk through innovative product design.

A range of solutions, particularly load release products, are now available in lightweight and flexible materials to deter patients and reduce the potential harm that could be caused by them, if they are used for purposes other than that for which they have been designed.

### Anti-Barricade

One of the most prominent risks within patient areas are those behind closed doors, where the patient has the ability to barricade themselves, and/or others away from staff, visibility, access and assistance.

A range of anti-barricade solutions has been developed to enable staff to quickly and easily overcome barricaded doors and obtain access to the patient. There are several levels of barricade over-ride from doors that swing outward in an emergency, through to mechanisms built into door locks that overcome tampering and attempts to prevent staff from being unable to unlock the door.

### Abuse/Durability Rating

Fixtures and fittings in a mental health environment are often subjected to, and should be able to withstand, the rigours of targeted abuse with the intention of causing damage. It is critical that if a product is damaged, it will not pose a risk of self-harm, harm to others, or prevent it from functioning correctly, if it forms part of a critical safety mechanism.

### TS001 Standard

At time of publication, the Door Hardware Federation Technical Standard [DHF TS001] is the most relevant and recognised independent guideline available internationally to test and grade the ligature capabilities of hardware products. Testing with this standard varies depending on the nature of the product and how it is to be installed. Products are classified into categories [A,B, or C] to determine which test is to be applied and are then graded according to ligature resistance from 1 through 4, with 4 being the highest/safest grade. The testing method and grade can then be combined [e.g. A4], and this rating applied to individual products. It may be represented in a format similar to the icons below:



Scan below to view & download the TS001 Standard Online:



## Locksets and Handles - Important Considerations

### Is it Anti-Ligature?

This can sometimes be a little difficult to determine as some products appear to be anti-ligature and can even be marketed as such but may have significant ligature risks. The best way to be sure is to confirm if the product has been tested and classified according to DHF TS001 which is a technical standard that assesses door hardware for ligature resistance. This standard is freely available online for review. When reviewing products, look for an icon similar to that featured in figure 8.1 to confirm the classification.



Figure 8.1

**Helpful Tip:** Avoid any type of lever handle. These fail DHF TS001 testing as a ligature can be achieved by looping something under or around the lever[s]. Refer to figure 8.2 and 8.3.



Figure 8.2



Figure 8.3

### Safety Should Not Compromise Functionality - Can you live with it?

Often in the process of selecting an anti-ligature handle or lockset, the question of how easy or comfortable it is to use is overlooked. Ease of use can have a significant impact on both patients and staff and there are several factors to consider when deciding on a suitable lock;

- **Size of the handle/snib:** this is typically the easiest aspect to compare. For most locks/latches to operate they require the user to rotate some form of handle. Comparing anti-ligature snibs/handles is as simple as comparing the distances from the pivot point to the furthestmost point of the handle. The further the handle extends from the pivot point, the more leverage it will have and the less force it will require to operate. For circular type handles as per the examples below, the greater the diameter, the more leverage you will have to operate the lock.
- **Grasp-ability:** a second factor to consider for ease of use is how easily the handle can be grasped - not just to operate the lock but also to pull the door open or closed. To better understand this, compare the below examples. Consider how easy it would be to grasp the handles, factor in potentially wet hands or dexterity issues, consider where you can place your fingers and what you have to grasp when turning the handle and pulling the door closed.

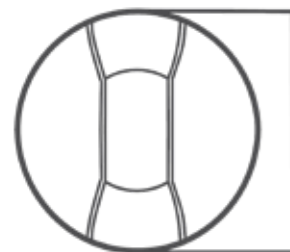

Figure 8.4



Figure 8.6

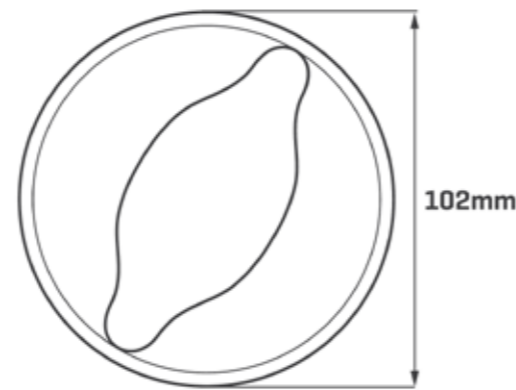

Figure 8.8

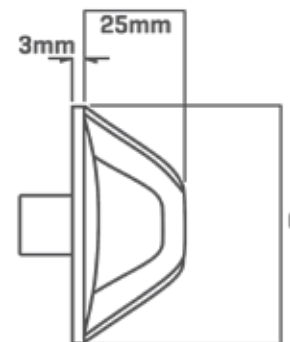

Figure 8.5

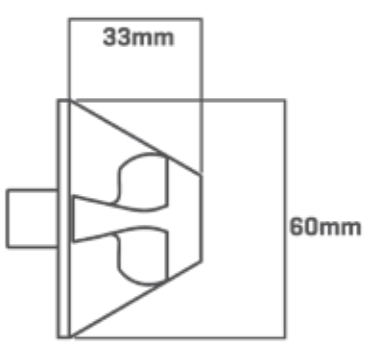

Figure 8.7

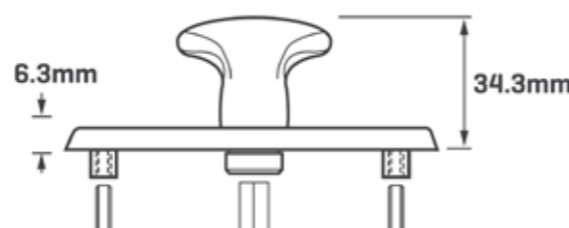

Figure 8.9

Whilst diagrams are helpful, we strongly recommend assessing a physical sample, of any handle, before purchasing.

- **Orientation and distance of rotation:** The third factor to consider for ease of use, is how you would need to rotate your wrist, to operate the handle. If the handle requires you to rotate your wrist into an uncomfortable position, repeated use may result in a repetitive strain injury [RSI]. The best way to assess this, is to actually operate a physical sample of the handle you are considering, to confirm how comfortable it feels to lock/unlock. Detailed in figure 9.1, is the orientation of rotation, for the internal handle design we recommend. To emphasise this point, stand this page upright, line your fist up with the handle position, and rotate it from left to right, between the lock and unlock positions. This rotation should be comfortable for most users.

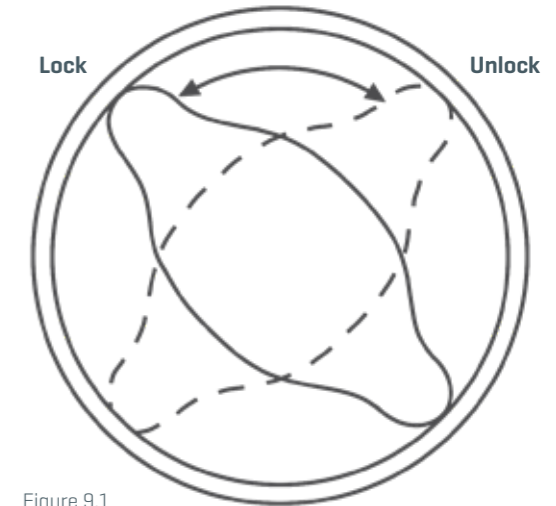

Figure 9.1

### What function is required?

When choosing a door lock, the lockset function is a critical element to consider. The following questions should help determine what will work best for you and guide you to the relevant option from our product range:

1. Will the door need to lock, or can it remain unlocked at all times?
  - Some factors to consider when deciding this are as follows;
    - Does the room have an en-suite and will this be lockable or does privacy need to be achieved by locking the bedroom door?
    - Do patients need the ability to lock themselves in their room to ensure that unauthorised persons or other patients can't enter?
2. If locking is not required, you may consider our range of push/pull handles (refer page 24-25) in conjunction with a roller or magnetic catch that will hold the door in place but not lock it.
3. If locking is required, the following questions should be considered:
  - Does the door need to lock automatically when it is closed, or should it only be locked manually by staff or patients?
  - A manual lock is most common as it allows free access to the bedroom however also has the ability to allow patients to lock themselves in their bedroom when required for privacy and security. If this is the requirement, you may consider the 46 Bedroom Lockset (refer pages 16-17).
  - Automatic locking is normally used in conjunction with some form of electronic access control such as a swipe card or wristband. If this is the requirement, you may consider either of the following options;
    - Latching lockset, 66 Latch-Lock Lockset (refer pages 18-19) or
    - Passport Electronic lockset (refer pages 20-23)
4. If the door can be locked it is important to ensure that you have a quick and reliable way to override the lock, if the lock is jammed or a patient is trying to lock or barricade themselves away from staff. Avoid clutching locks and coin slot overrides. These are common in standard door hardware however are a risk and are unsuitable for mental health facilities.
  - Avoid Clutching Locks
    - Clutching locks/cylinders typically have an inbuilt mechanism that works by disengaging the internal handle/snib when a certain level of torque is applied, for example when a patient may be holding the internal handle in the locked position in an attempt to prevent entry by staff. This can become an issue if a door or door frame distorts or moves over time, which can cause friction between the latch and strike plate. This friction can be sufficient to disengage the internal handle, effectively locking a patient in their room. This is not conducive to maintaining a calm environment and can be highly dangerous in the event of an emergency, where there is a genuine need for the patient to leave the room urgently, for example in the event of a fire.
  - Avoid Coin Slot Overrides
    - Coin slot overrides are common in domestic use where a coin or similar tool can be inserted into a slot, and used to unlock the door from the external side. Two significant issues when they are installed in a mental health facility are:
      1. They can easily be manipulated by unauthorised persons or other patients, to gain entry into the room, utilising items as simple as a coin, fingernail, or similar tool which is likely to be readily available.
      2. They tend to be fiddly and provide limited leverage, making it easy for patients to hold the internal handle/snib in the locked position, whilst staff struggle with operating the slot from the outside.

Continued over

## So what are some good override options to consider?

Within the Hipac range of locksets, there are three different types of override available. These are as follows;

### 1 Way Staff Override System (Figure 10.1)

- This is the minimum level of override required for any mental health facility. In simple terms, it means that staff will be able to use their key to unlock the door.
- The handle and key operate independently so the key will always dominate even if the patient is attempting to hold the internal handle in the locked position.
- It is a direct mechanical override so there is no geared cylinder to disengage the turn/pull and no clutch mechanism involved.
- An optional slide-over emergency pull handle can be utilised to enable more than one person to assist in pulling the door open, if there is resistance from the patient side of the door. [Refer figure 10.2]

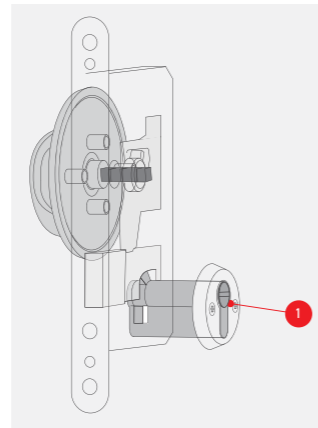

Figure 10.1

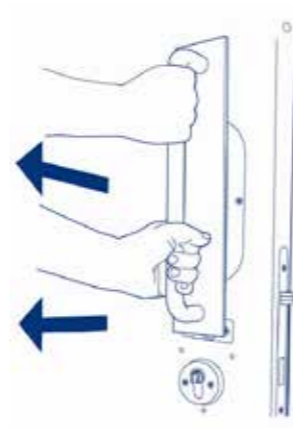

Figure 10.2

### 1 Way Staff Override System with Lifeline Key (Figure 10.3)

- This option operates in the same way as the standard 1 Way Staff Override System where the key always dominates the internal handle.
- Rather than a traditional master keyed cylinder however, it incorporates a unique key mechanism called a Lifeline key. This is a closed keyway system that minimises the probability of keyway tampering.
- Using five spring-loaded forward-facing pins, the keyway is automatically closed off when the Lifeline key is removed from the lock. This key system can also be used on other Hipac products such as vision panels, detachable door stops and locking bolts.



Figure 10.3

### 5 Way Staff Override System (Figures 10.4, 10.5, 11.1 and 11.2)

- This system is the most comprehensive override system currently available. In addition to the staff key always dominating the internal handle, this override system has an emergency override method if the normal keyway has been damaged or tampered with [e.g. paper or chewing gum inserted into keyway].

**In total there are 5 override features and functions to overcome even the most determined barricade attempts.**

## 5-Way SOS Emergency Override Procedure

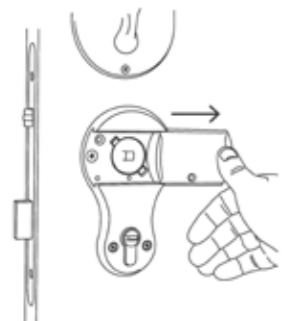

Figure 10.4

**1.** Remove the single anti-tamper screw and slide the cover plate to reveal the spindle.

Note: On electronic locks there are two anti-tamper screws.

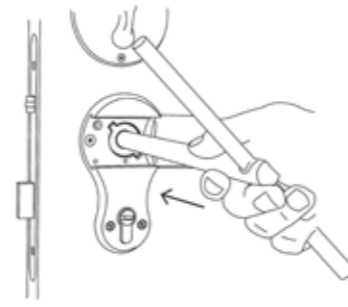

Figure 10.5

**2.** Slide the emergency tool over the spindle until it stops.

Continued Over

From Previous Page

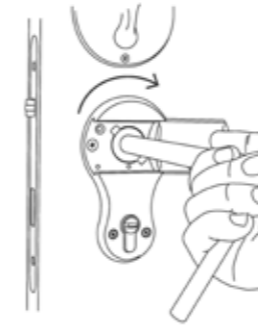

Figure 11.1

**3.** Rotate the emergency tool clockwise to unlock the door.

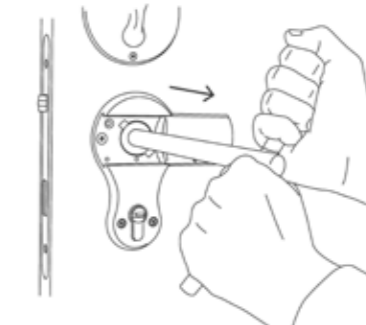

Figure 11.2

**4.** The T-bar can also be used to pull the door outwards, overcoming resistance by the patient.

**While we trust they are rarely used, in an emergency situation, they may be the critical elements that save a life. The 5 methods are set out below in figure 11.3;**

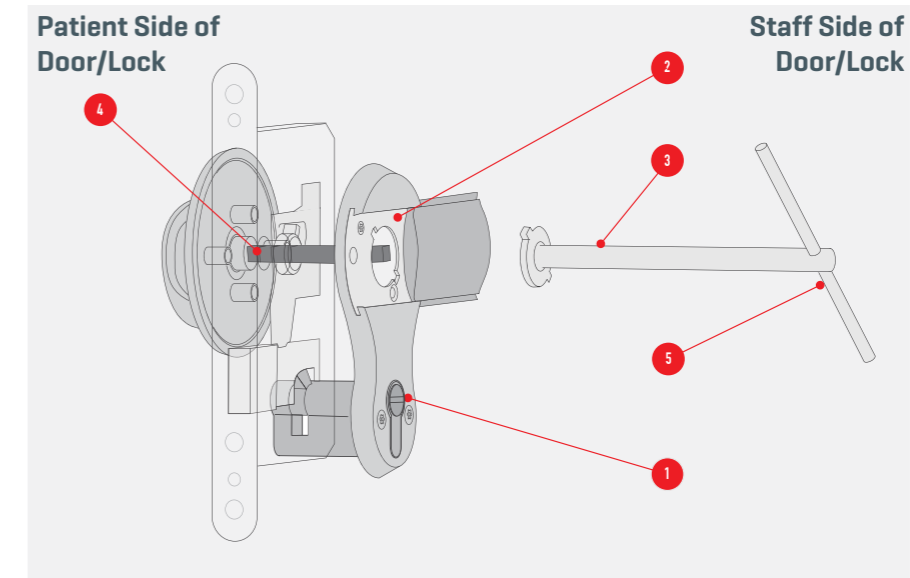

Figure 11.3

### 1. Key

- The key and lockcase operate independently of the internal handle. Therefore in a barricade situation, if accessible, the key always dominates.

### 2. Keyway

- If the visible keyway is blocked with foreign objects, like chewing gum or paper, the concealed backup override directly turns the spindle, allowing entry.

### 3. Turn Leverage (T-Bar)

- The T-bar emergency tool provides superior leverage to rotate the handle, even if the patient is stronger than the clinician.

### 4. Spindle

- Under heavy resistance, the safety spindle shears on the patient side of the door, ensuring entry if the handle is immobilised. Even in the most serious barricade attempts, where the patient attempts to jam the handle with their bed or body, swift access is achieved without lockcase damage.

### 5. Pull Advantage (T-Bar)

- The T-bar provides a significant power advantage to pull the door open, offering better grip than an anti-ligature handle, foiling attempts by a patient to hold the door shut using their body weight.

## Hinges and Stops - Important Considerations

- Confirm it has been tested to DHF TS001 and complies with a level of B4, which means that it has been tested for vertical ligature resistance and a test wire of 0.5mm cannot obtain a ligature.
- Ensure that the hinge runs the full length of the door in patient areas and is a geared hinge. Unless the hinge runs the full length of the door, leaf ligature points will appear as soon as the door is opened. For example refer figures 12.1 and 12.2. When these are in the open position, there are easily accessible gaps between door and frame and a ligature can be easily achieved, by inserting something in through this gap and then around the hinge or pivot components. Most piano style hinges [refer figure 12.3] also open up gaps in the hinge itself when the door is opened which can be accessed to form a ligature. This risk is avoided with a geared hinge such as the Securahinge [refer page 28]. Please note that some butt hinges and pivots can be used, however only on doors where these would be locked and closed, hence limiting patient access to potential ligature risks. Refer to page 80 for butt hinges suited to locked doors [e.g. cupboards, storage rooms].



Figure 12.1 - Butt hinge



Figure 12.2 - Pivot hinge



Figure 12.3 - Piano hinge

- Hinges can be used to prevent or overcome patient barricades. There is an inherent risk that patients can barricade doors closed to prevent staff access, which is potentially life threatening if a patient can self-harm without intervention by staff. Other patients or staff can also become trapped or held hostage. There are a number of ways in which the hinging configuration can be used to minimise or overcome these barricade risks. These are as follows;

- Outward Swinging Doors** – The simplest way to minimise or prevent a barricade risk is to swing the door outwards. This means that the door would swing away from the attempted barricade and allow easy access. This is ideal for doors where an outward swing is possible such as en-suite doors that swing into bedrooms however may not be suited to bedroom doors where an outward swinging door would potentially block a corridor or if swung outward at speed could potentially strike and injure anyone within the arc. Refer Figure 12.4.

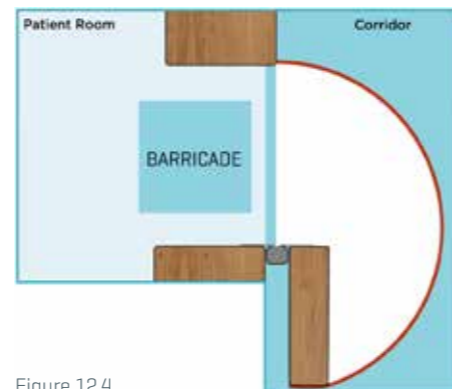

Figure 12.4

- Dual Swinging Door with Detachable Stop** – This is where a single leaf door is installed with a double swinging hinge. During normal use the hinge allows the door to swing inwards however the detachable stop mounted on the frame prevents the door from swinging outward. If a barricade is attempted the stop can be detached which then allows the door to swing outward, enabling staff access to the room. Refer Figures 12.5, 12.6 and 12.7.

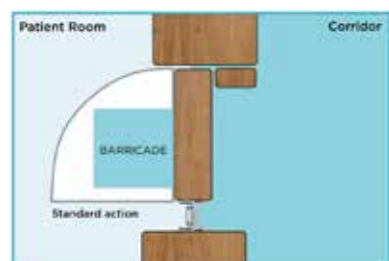

Figure 12.5 - Door barricaded by patient

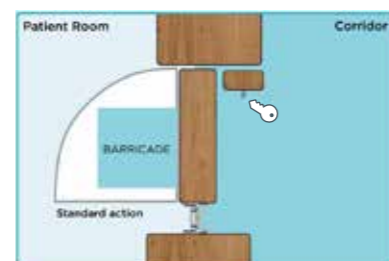

Figure 12.6 - Unlock/detach stop



Figure 12.7 - Swing door outwards

- Considerations when selecting a detachable door stop:
  - Ensure it requires a staff key – without which there is potential for patients to operate the stop and compromise the privacy and security of the room
  - Ensure it does not create ligature risks – ideally ensure it complies to DHF TS001 B4 testing, and does not have any levers or components that can be accessed by patients without a staff key
  - Avoid push-in style stops – these are designed to be operated by pushing in the protruding stop with your fingers. If pressure is applied from the inside of the door, the stop itself can become jammed, and as the stop is being operated, the fingers can become jammed or injured, refer figure 13.1.

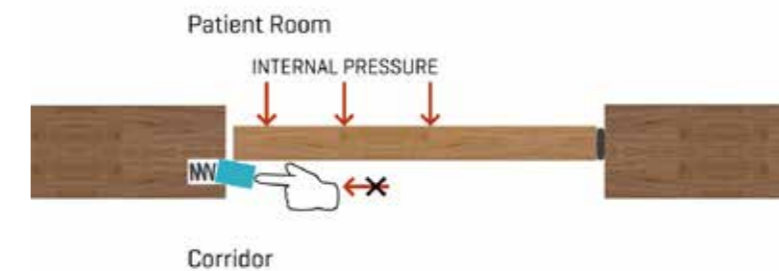

Figure 13.1

- Cat & Kitten Doors** – This is a relatively common way of achieving a normally inward swinging door and yet still have the capacity to overcome an attempted barricade from the inside. During normal use, the larger leaf [Cat] swings inward and the smaller leaf [Kitten] is locked into position with some form of bolt [refer page 33 for recommended options]. If a barricade is attempted, the smaller leaf can be unlocked allowing it to swing outward and allow access to the room. With this system there are two main hinging options to consider;

- Single Swing Doors** – This is where the larger leaf swings inward and the smaller leaf swings outward, refer figure 13.2. It is important to consider the width of the kitten door when evaluating this option. The smaller leaf is there to allow access during a barricade, however if it is too narrow to allow a staff member to enter safely, it may be ineffective in overcoming the barricade.

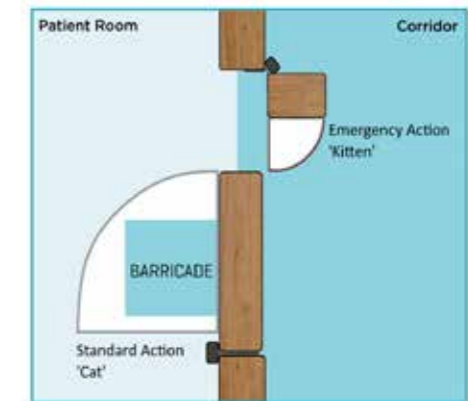

Figure 13.2

- Dual Swinging Door(s)** – this is where the larger leaf (or potentially both leaves) are installed with a double swinging hinge, refer figures 13.3 and 13.4. During normal use the larger leaf would swing inward only, with the smaller leaf (when locked in position) acting as a stop to prevent the larger leaf swinging outward. If a barricade is attempted, the smaller leaf can be unlocked allowing both doors to swing outward [refer figure 13.4] and away from the barricade, meaning that the full width of the doorway is available for staff access.

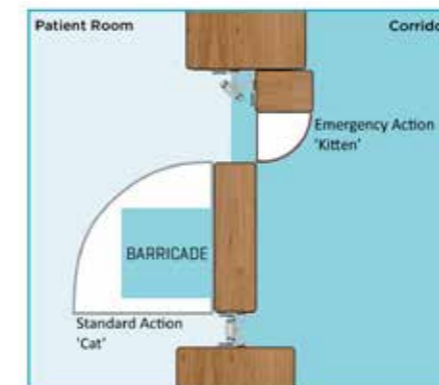

Figure 13.3

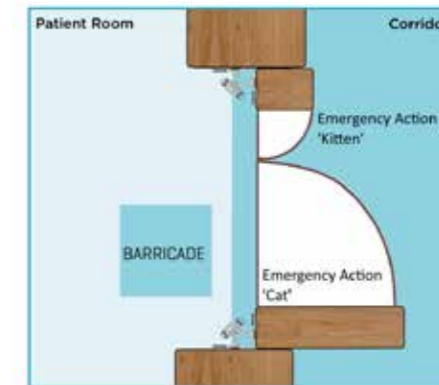
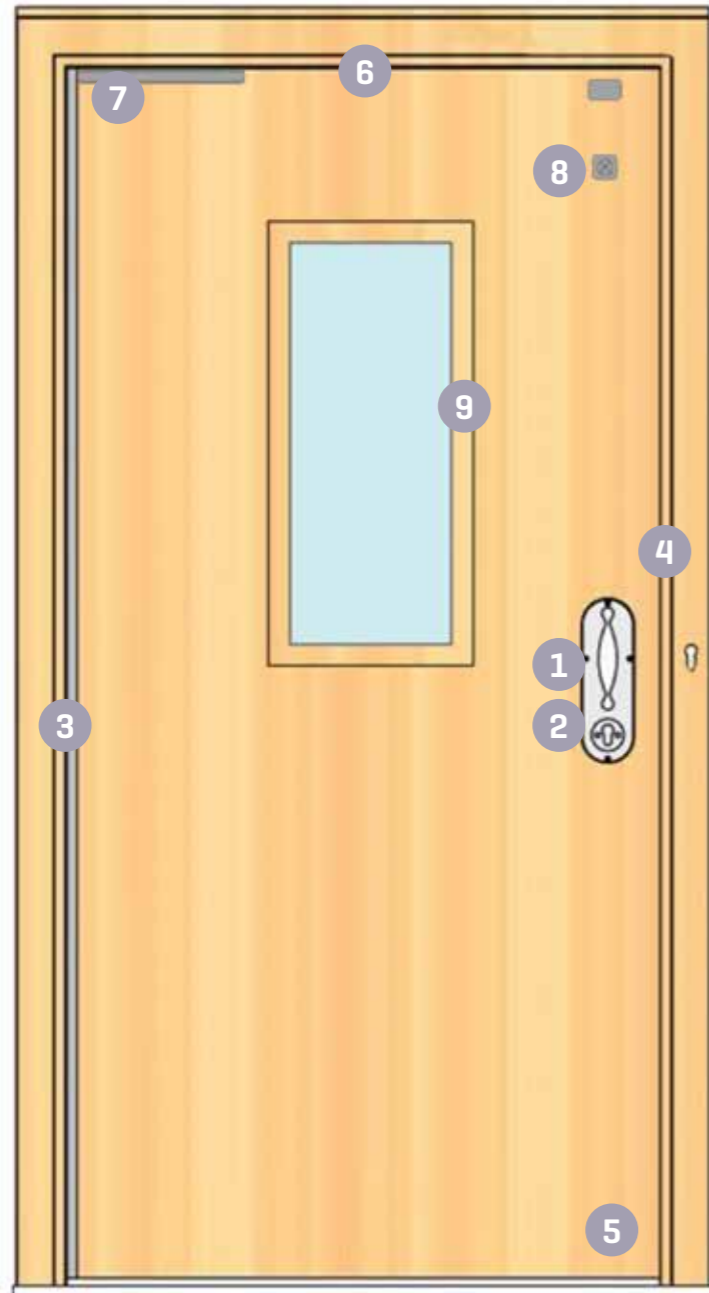

Figure 13.4



01. Locksets	16
02. Handles	24
03. Hinges	26, 28
04. Removable Door Stops	27
05. Door Stops	29
06. Door Top Alarm	30
07. Door Closers	32
08. Locking Bolts	33
09. Vision Panels	34



# Bedroom Door Products

## Locksets

### PR-1-46 BEDROOM LOCKSET







Level A4  
TS001 Grade



1 Way  
Override



Euro Profile  
Key Cylinder

TO LOCK		TO UNLOCK	
 Internal Handle	 External Key	 Internal Handle	 External Key

### PR-3S-46 BEDROOM LOCKSET



Level A4  
TS001 Grade



5 Way  
Override



Euro Profile  
Key Cylinder

TO LOCK		TO UNLOCK	
 Internal Handle	 External Key	 Internal Handle	 External Key

### PR-LL-46 BEDROOM LOCKSET



Level A4  
TS001 Grade



1 Way  
Override

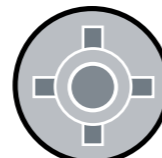

Lifeline  
Key Cylinder

TO LOCK		TO UNLOCK	
 Internal Handle	 External Key	 Internal Handle	 External Key

### COMMON HANDLE OPTIONS

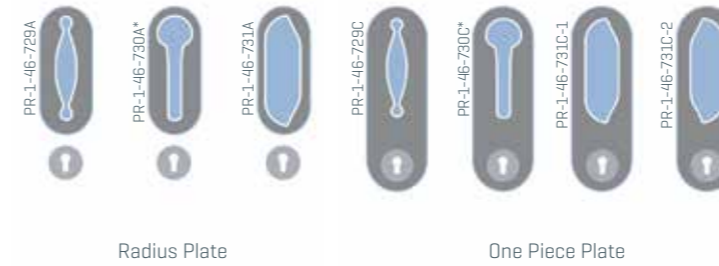

Square plate options available to order.  
\*All 730 Elephants Trunk Handles become TS001 Level B4, rather than A4.

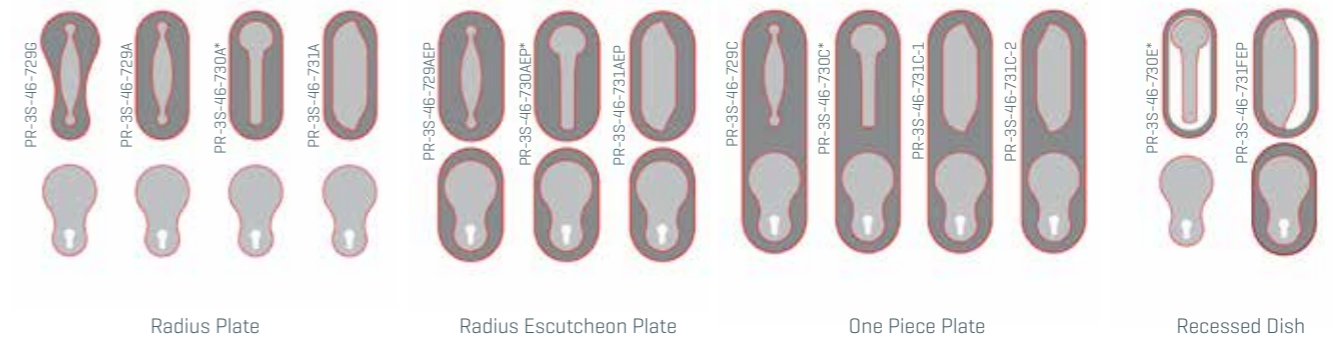

Square plate options available to order, for some handles.  
\*All 730 Elephants Trunk Handles become TS001 Level B4, rather than A4.

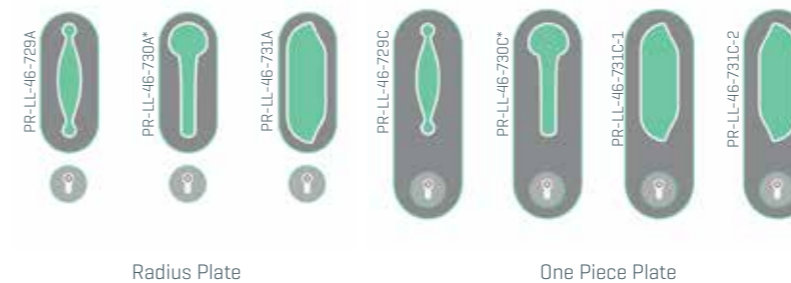

Square plate options available to order, for some handles.  
\*All 730 Elephants Trunk Handles become TS001 Level B4, rather than A4.

# Bedroom Door Products

## Locksets

### PR-1-66 LATCH-LOCK (KEY/TURN) LOCKSET



Level A4  
TS001 Grade



1 Way  
Override



Euro Profile  
Key Cylinder

TO LOCK		TO UNLOCK	
Internal	External	Internal	External
Close Door	Close Door	Handle	Key/Swipe*

\*If used in conjunction with electric strike 114086 - refer page 81.

### PR-3S-66 LATCH-LOCK (KEY/TURN) LOCKSET



Level A4  
TS001 Grade



5 Way  
Override



Euro Profile  
Key Cylinder

TO LOCK		TO UNLOCK	
Internal	External	Internal	External
Close Door	Close Door	Handle	Key/Swipe*

\*If used in conjunction with electric strike 114086 - refer page 81.

### PR-LL-66 LATCH-LOCK (KEY/TURN) LOCKSET



Level A4  
TS001 Grade



1 Way  
Override

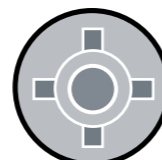

Lifeline  
Key Cylinder

TO LOCK		TO UNLOCK	
Internal	External	Internal	External
Close Door	Close Door	Handle	Key/Swipe*

\*If used in conjunction with electric strike 114086 - refer page 81.

### COMMON HANDLE OPTIONS

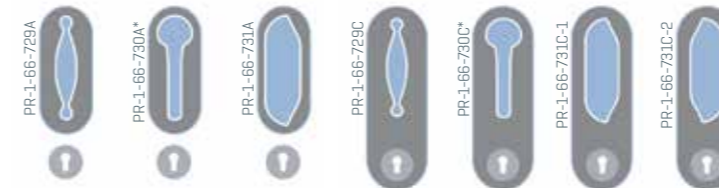

Radius Plate

One Piece Plate

Square plate options available to order.

\*All 730 Elephants Trunk Handles become TS001 Level B4, rather than A4.

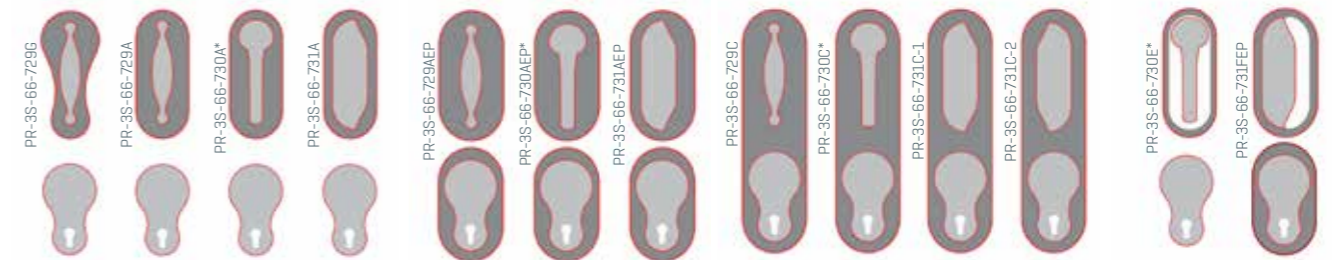

Radius Plate

Radius Escutcheon Plate

One Piece Plate

Recessed Dish

Square plate options available to order, for some handles.

\*All 730 Elephants Trunk Handles become TS001 Level B4, rather than A4.

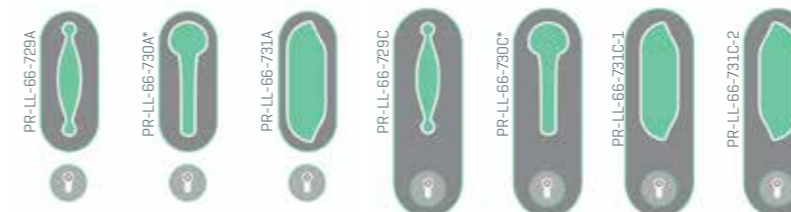

Radius Plate

One Piece Plate

Square plate options available to order, for some handles.

\*All 730 Elephants Trunk Handles become TS001 Level B4, rather than A4.

### PASSPORT PROXIMITY LOCKSET SOLO



- Patient empowering
- Visual and audible signaling
- Simple to operate and program
- Stand-alone, battery-powered
- Non-volatile memory
- Designed to DHF TS001:2013
- Robust and impact resistant
- Bolt through fixings
- External battery access
- Concealed emergency override mechanism
- Automatic dead-locking function
- No cylinder required

PASSPORT is a stand-alone, battery-powered proximity access control lockset that has been designed specifically to meet the special requirements of a mental healthcare setting. It allows patients independent access to their own space whilst being completely programmable by staff. Built for safety and durability, it also includes all important anti-ligature and five-way anti-barricade features.



Level A4  
TS 001 Grade



5 Way  
Override



Swipe/  
Wristband



TO LOCK		TO UNLOCK	
Internal	External	Internal	External
Close Door	Close Door	 Handle	 Swipe

**Specification:**  
PASSPORT Solo - Proximity Access Lockset V2 - With user credentials [wristbands/cards/fobs] as required.



### THE PASSPORT CONCEPT

The PASSPORT concept is simple. Allowing patients to control access to their own space can be hugely beneficial. Not only is demand on staff time reduced, but the locking system allows patients the essential privacy and dignity required. It also allows them to protect their possessions and gives them a safe haven in what can be an alien environment. PASSPORT operates without mechanical keys, using fobs, wristbands or cards to unlock the door. Compared to keys, all of these options reduce the opportunity for self-harm or injury to staff. Furthermore, increased levels of independence, privacy and personal security can help avoid confrontations and flash-points, contributing to a calmer, more peaceful and therapeutic environment.

#### In the event of an emergency

Unlike conventional access control products, the electronic control equipment included in the PASSPORT lockset is fitted on the outside of the door. This significantly reduces the opportunity for patients to tamper with the device without clinical staff intervention.

PASSPORT comes fully equipped with a concealed and independent barricade override mechanism which ensures clinical staff can gain access at any time, even in the event of an electronic failure. This eliminates the need for mechanical locking cylinders which are prone to wear and often the target of abuse.

#### Override Procedure

1. Remove the two anti-tamper screws using the screwdriver in the emergency tool kit.
2. Lift out cover plate
3. Line up the emergency tool and slide it over the spindle until it stops.
4. Rotate the emergency tool to unlock the door. Note: in the case of double action, anti-barricade doors, the tool can also be used to pull the door open in the outward direction, overcoming any resistance by the patient from inside.

### PASSPORT PROXIMITY LOCKSET AMADEO



#### PASSPORT Amadeo - a flexible friend and powerful ally.

PASSPORT Amadeo is the next generation of access control system. It works with the same trusted hardware as the existing PASSPORT Solo system and for patients, familiar with its easy card, fob or wristband operation, it works in exactly the same way. But behind the scenes, it's gathering information. Amadeo can keep track of the movements of any number of 'key' holders. It knows the dates, the times, who went where and, as it's a WI-FI enabled system, it's entirely safe for use in challenging environments.

**PASSPORT Amadeo incorporates all the features of the PASSPORT Solo lockset detailed on the previous page, along with the following additional capabilities:**

- Wi-Fi enabled
- NFC (Near field communications)
- Real-time access changes
- Temporary keys
- Audit trail
- Time zones



#### Software

Software available for PC, tablet or mobile  
Web-based technology  
User friendly windows  
Time zones, master cards and users  
Variety of card privileges  
Suite and sub-suite configurations

#### Hand held programmer

Mobile data transfer unit  
Initialise and program PASSPORT locks  
Transmit data from locks to software and vice versa  
Stand alone application to manage a system without PC software  
Emergency opening

#### Card encoder/writer

For encoding and reading user ID cards  
USB connection to PC software  
Easy to operate contactless encoding  
Network encoder  
NFC compatible  
Space saving, compact design



Level A4  
TS001 Grade



5 Way  
Override



Swipe/  
Wristband



TO LOCK		TO UNLOCK	
Internal	External	Internal	External
Close Door	Close Door	Handle	Swipe



A significant benefit of this model is how quick and simple it is to program. Instead of going to each individual door, everything can be programmed from one central computer. With Internet access, a door can be programmed remotely and a virtual key issued from just about anywhere via a mobile app.

The amount of control and recording can be tailored to different user and staff requirements. For example, alarms could be set to highlight that someone has tried to gain access to a restricted room. It's even possible to use Amadeo to monitor staff time and attendance.

PASSPORT Amadeo is a powerful combination of great hardware and practical software and is sure to make the management of mental healthcare facilities easier and safer.

#### Specification:

Passport Amadeo - Proximity Access Lockset - With user credentials (wristbands/cards/fobs) software, and programming devices as required.



Differentiation of Lockset and Door



Swipe Card Access



Wrist Fob Access



Auto-Locking Night Latch

### PINCH GRIP PULL HANDLES

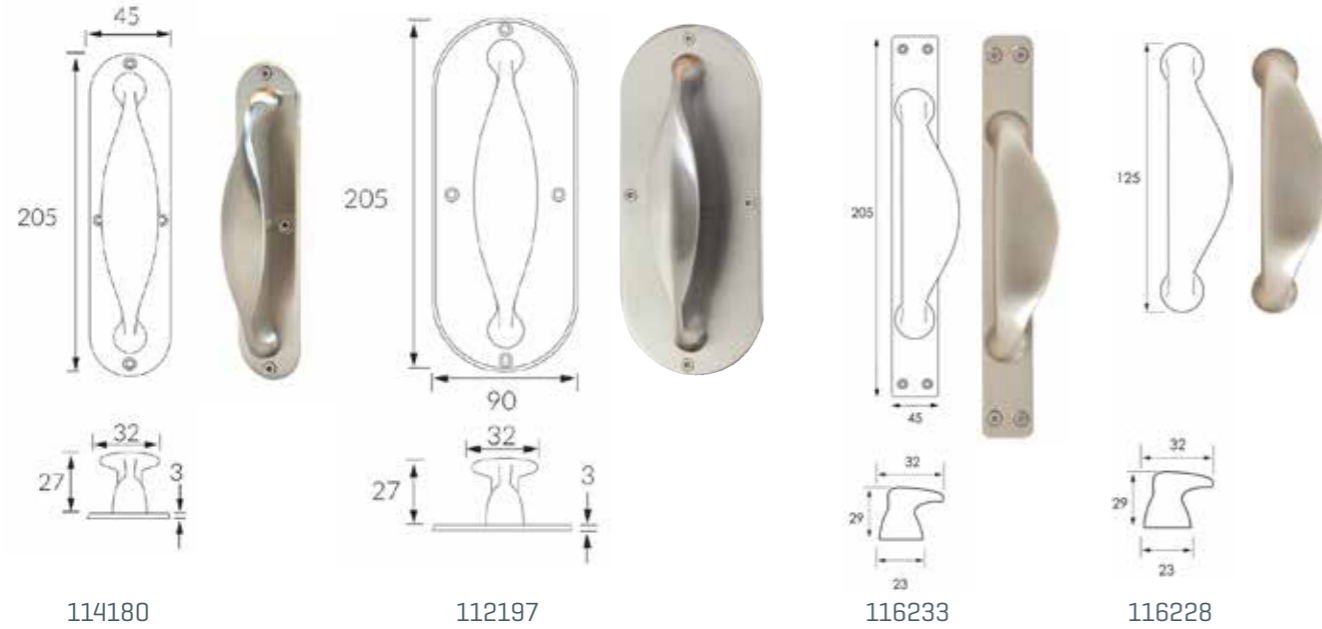

**CODE:**

- 114180 729 Pinch Grip Pull Handle on Narrow Radius Plate 45mm x 205mm
- 112197 Pinch Grip Pull Handle on 90mm x 205mm Backplate
- 116233 727 Pinch Grip Pull Handles on Square Plate 45 x 205mm
- 116228 727 Pinch Grip Pull Handle without Backplate



### ELEPHANTS TRUNK PULL HANDLE



**CODE:**

- 116118 730 Elephants Trunk Handle on 90 x 205mm Radius Backplate
- 141312 730 Elephant Trunk Handle on Recessed Dish
- 117155 730 Elephants Trunk Handle on Narrow Radius Plate 65 x 205mm

USE WITH CAUTION



### SURE GRIP PULL HANDLE

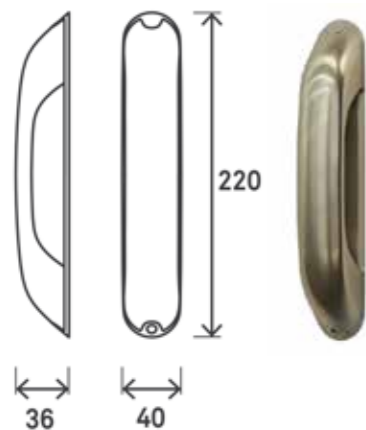

**CODE:**

- 142949 732 Sure Grip Pull Handle on Invisible Backplate, 40 x 220mm



### RECESSED PULL HANDLE

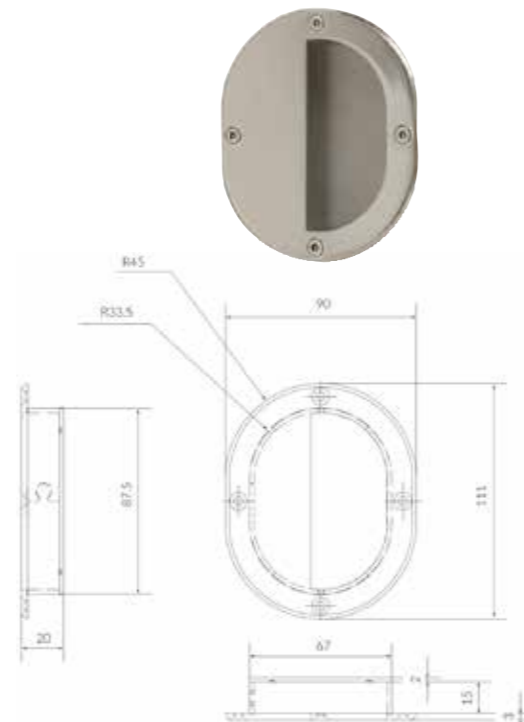

**CODE:**

- 117072 726 Recessed Flush Pull Handle, 90 x 111mm



### GRAB (RECESSED OR FLAT PLATE) ANTI-LIGATURE DOOR HANDLES

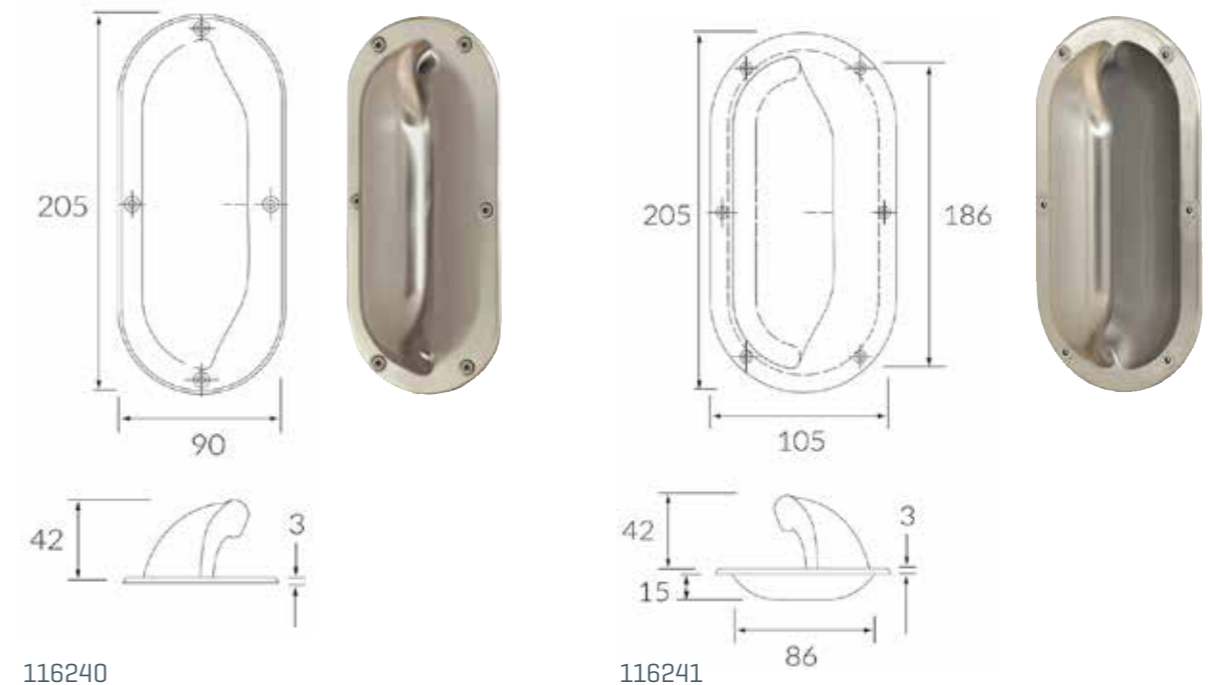

**CODE:**

- 116240 731 Grab Pull Handle on 90mm x 205mm Backplate
- 116241 731 Grab Pull Handle on Recessed Dish



**DOUBLE SWING FULL LENGTH GEARED HINGE**



The double swing hinge is a full length continuous geared hinge that provides a solution for doors that are required to swing 90 degrees in either direction. It is predominantly used in conjunction with a removable/detachable door stop, as where barricading is a risk it allows the door to swing in either direction [refer page 27]. As it is continuous it removes the ligature risks that are associated with the gaps between door and frame that are left by pivots and traditional hinges. These hinges can also be used on doors as a more durable alternative to pivots. This Double Swing Hinge can also be used in conjunction with the Floor Mounted Door Closer [refer page 32].

**CODE:**

- 114616 Double Swing Geared Hinge Full Length 2100mm [To Suit 44mm Door]
- 119211 Double Swing Geared Hinge Full Length 2400mm [To Suit 44mm Door]



**DOUBLE SWING SHROUDED HINGE**



The shrouded double swing hinge, like the standard double swing hinge, is a full length continuous geared hinge that provides a solution for doors that are required to swing 90 degrees in either direction. The unique shrouded design adds additional protection against ligature attempts, tampering, and finger entrapment. It is predominantly used in conjunction with a removable/detachable door stop where barricading is a risk as it allows the door to swing in either direction as required [refer page 27]. As it is continuous it removes the ligature risks that are associated with the gaps between door and frame that are left by pivots and traditional hinges. These hinges can also be used on doors as a more durable alternative to pivots. This Shrouded Double Swing Hinge can also be used in conjunction with the Floor Mounted Door Closer [refer page 32].

**CODE:**

- 142837 Shrouded Double Swing Geared Hinge Full Length 2100mm
- 142838 Shrouded Double Swing Geared Hinge Full Length 2400mm



**MOVASTOP DETACHABLE DOOR STOP**

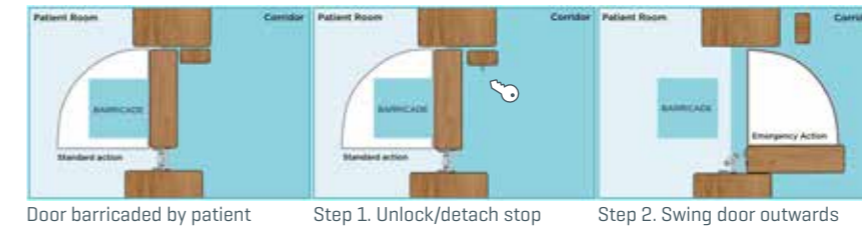

Door barricaded by patient Step 1. Unlock/detach stop Step 2. Swing door outwards

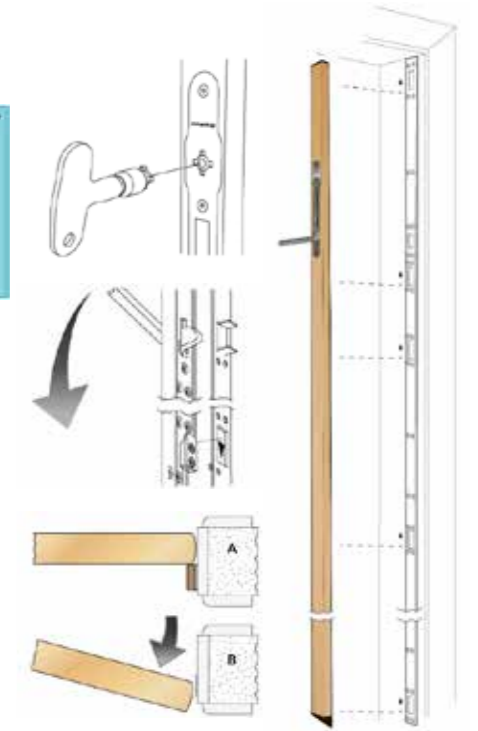

The Movastop detachable door stop, in conjunction with a double swing hinge is another effective solution to help overcome a barricade situation. During normal use the stop remains locked to the door frame to act as a traditional stop and prevents the door from swinging outward. In the event of a barricade, staff can fully detach the Movastop from the door frame, using a Lifeline key. This allows the door to swing in an outward direction and away from the barricade. The Movastop blends in well with the door frame and is robust and resistant to abuse and tampering.

**CODE:**

- 119120 Movastop Detachable Door Stop up to 2100mm - White [Requires Lifeline Key]
- 119122 Movastop Parking Facility - White



**REMOVABLE DOOR STOP, ALUMINIUM**

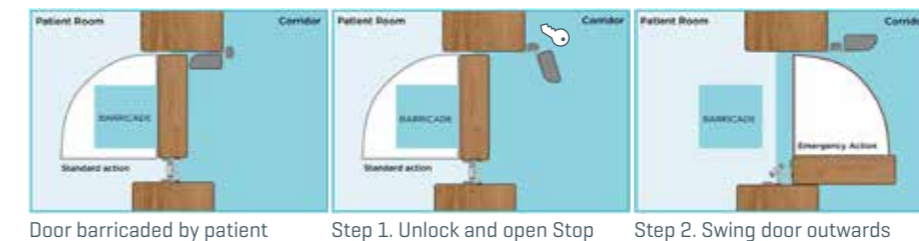

Door barricaded by patient Step 1. Unlock and open Stop Step 2. Swing door outwards



The removable door stop, in conjunction with a double swing hinge is an effective solution to overcoming barricade attempts. During normal use the stop remains locked to the door frame to act as a traditional stop and prevents the door from swinging outward. In the event of a barricade, the removable stop can be unlatched from the frame [using a key] and opened outward, allowing the door to swing away from the barricade.

**CODE:**

- 116994 Removable Door Stop, Right Handed, 2100mm [Requires 4mm Key]
- 116995 Removable Door Stop, Left Handed, 2100mm [Requires 4mm Key]
- 138642 Removable Door Stop Right Handed, 2400mm [Requires 4mm Key]
- 138643 Removable Door Stop Left Handed, 2400mm [Requires 4mm Key]



**SINGLE SWING FULL LENGTH ANTI-LIGATURE GEARED SECURAHINGE**



The Securahinge is a full length continuous geared hinge fitted with a sloping cap and specially designed bearings to overcome the risks of ligature and self-harm. As it runs the full length of the door it removes the ligature risks associated with the gaps between the door leaf and frame left by butt or piano style hinges. The Securahinge opens up to 180 degrees in one direction so is suitable for applications in which the door is required to fold back against the wall. The Securahinge can be installed in conjunction with the Floor Mounted Door Closer or the Concealed Door Closer [refer page 32].

**CODE:**

- 111916 Securahinge, Standard Duty - up to 125kg, 32mm leaf, 2100mm
- 117090 Securahinge, Heavy Duty - up to 245kg, 32mm leaf, 2100mm
- 116479 Securahinge, Extreme Duty - up to 245kg, 43mm leaf, 2100mm
- 113638 Securahinge, Standard Duty - up to 125kg, 32mm leaf, 2400mm
- 117091 Securahinge, Heavy Duty - up to 245kg, 32mm leaf, 2400mm
- 117092 Securahinge, Extreme Duty - up to 245kg, 43mm leaf, 2400mm



**FINGER PROTECTIVE DOUBLE SWING HINGE**



In addition to all the benefits of the standard Double Swing Hinge, this product allows for greater than 90 degrees opening in both directions, whilst retaining a clearance gap that prevents fingers being trapped, even in the event of the door being slammed shut. With this unique design ensuring a clearance gap, this hinge provides permanent finger protection and will not wear out.

Like the Double Swing Hinge, the Finger Protective Double Swing Hinge can also be used in conjunction with a concealed floor mounted door closer [refer page 32].

**CODE:**

- 117159 Double Swing Finger Protective Geared hinge 2100mm
- 138623 Double Swing Finger Protective Geared Hinge 2400mm



**ELECTRICALLY MODIFIED HINGE SECTION**



The electrically modified hinge section provides a concealed and anti-ligature method of transferring power between the door frame and door. This is designed to be installed in conjunction with a full length hinge and can be fitted at the required height by cutting the full length hinge and butting the sections together. This allows the electrically modified hinge section to be serviced or replaced, without removing the door from the frame. Hinge sections come with 1.5m and 3m extension cables to suit.

**CODE:**

- 119151 Double Swing Geared Hinge Full Length, 200mm Section, 4 Wire
- 136766 Double Swing Geared Hinge Full Length, 200mm Section, 8 Wire
- 136767 Double Swing Geared Hinge Full Length, 200mm Section, 12 Wire
- 117630 Single Swing Geared SECURAHinge Full Length, 200mm Section, 4 Wire
- 117767 Single Swing Geared SECURAHinge Full Length 200mm Section, 8 Wire
- 117768 Single Swing Geared SECURAHinge Full Length 200mm Section, 12 Wire
- 142841 Shrouded Double Swing Electrically Modified Hinge 200mm, 4 Wire
- 142842 Shrouded Double Swing Electrically Modified Hinge 200mm, 8 Wire
- 142843 Shrouded Double Swing Electrically Modified Hinge 200mm, 12 Wire

\*Special versions available to suit Door top Alarm.

**MOULDED HEAVY DUTY DOOR STOP**

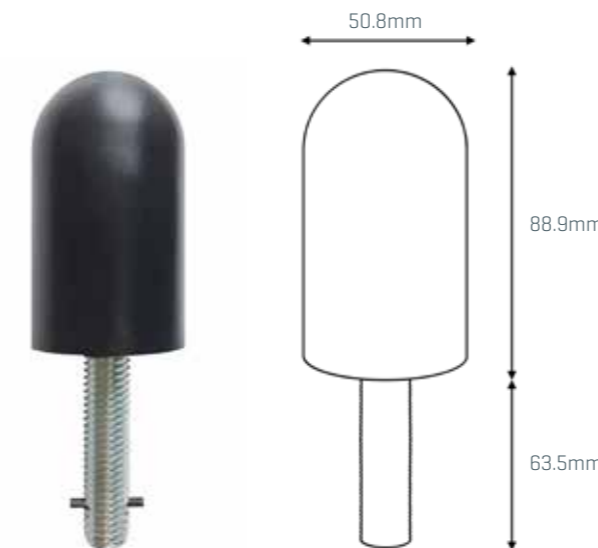

Heavy duty moulded rubber stop designed to restrict the opening angle of the door and/or prevent the door impacting the wall. Vandal resistant, no exposed fasteners, resistant to patient tampering, and is flame resistant. It is suitable for floor or wall mounting.

**CODE:**

- 119400 Heavy Duty Moulded Door Stop

**DOME WALL STOP**

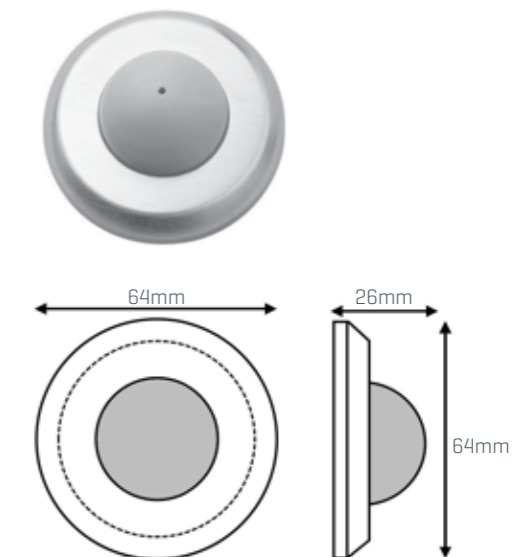

Dome bumper constructed from soft rubber with 304 stainless steel surround. Sloped design with no ligature points. Fixing screw is concealed to prevent patient tampering.

**CODE:**

- 120433 Dome Wall Stop

### DOOR TOP ALARM



The Door Top Alarm (DTA) is a technology and hardware product that is integrated into the head (top) of a timber door, to alert staff of a potential ligature attempt.

It sends a signal to the staff attack system to alert the clinical team when a patient has attempted to jam an item between the head of the door and the door frame.



The DTA has a discreet sensor which is installed across the full width of the door leaf, which detects if weight has been applied e.g. the weight from a ligature attempt using the top of the door, or if something is jammed between the top of the door and head of the frame. To minimise false alarms, the system has a built in time delay that is adjustable between 5 and 30 seconds. This ensures that the alarm won't be triggered by accidental bumps or patients playing with the sensor, only a sustained applied weight (as would be the case in a ligature attempt) will trigger the alarm and alert staff to respond.

The door top alarm is compatible with most duress or staff attack systems. When the alarm is triggered, a signal is sent to the designated system which then alerts staff via whichever means are currently in use by the facility and clinical team. This could be an audible alarm, staff indicator panel, pager, handsets, or main nurse station computer.

#### CODE:

- 120120 Door Top Alarm Kit to suit 44mm Width Door
- 136399 Door Top Alarm Kit to suit 54mm Width Door

### HOW THE DOOR TOP ALARM SYSTEM WORKS

1. Ligature Attempt in Patient Room.



2. Alarm on door top activates and a signal is sent from the electronic control box housed in the ceiling, to the staff attack system.

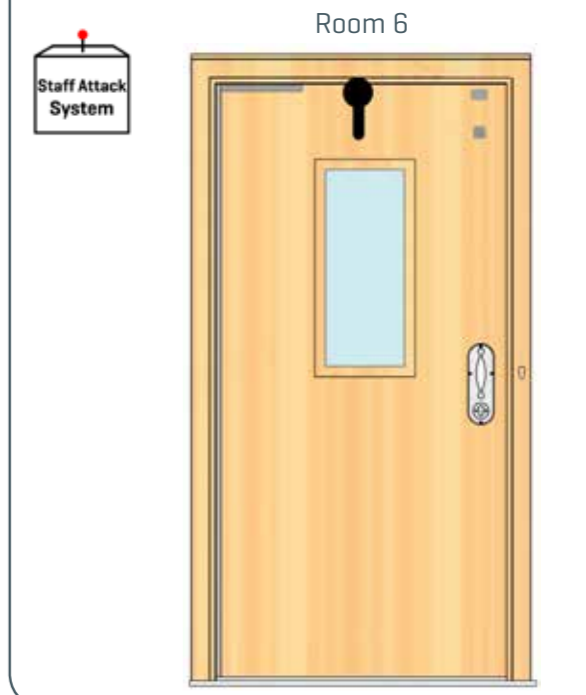

3. The staff attack system alerts the clinical team via an audible alarm, visible light, staff indicator panel, staff pagers/handsets, main nurse station computer or any other method employed by the system/facility.



Room 1	Room 2	Room 3
Room 4	Room 5	<b>Room 6 ALERT</b>
Room 7	Room 8	Room 9

4. Staff attend the patient room.





**CONCEALED DOOR CLOSER**



The requirements of anti-ligature installations and those of door closers invariably contradict each other. The necessity of a linkage between door and frame always creates a ligature point when the door is open. One of the best compromises is the Perko Powermatic concealed door closer. Operating at power size 3, with adjustable closing and latching speeds, this unit has a concealed jam mounted configuration making it a less obvious ligature risk. While a ligature risk will always be present with this model of door closer, it can be minimised by installing it at as little as 300mm above floor level.

**CODE:**  
117162 Perko Powermatic Concealed Door Closer

**FLOOR MOUNTED DOUBLE ACTION DOOR CLOSER**



The floor mounted double action door closer can be used in conjunction with the double or single swing hinge. This door closer is a discrete solution that can be used in areas of high risk to minimise ligature points. This closer can be supplied with an optional mechanical hold back feature. When the door is opened to the required hold back point, it will latch in position and remain open until manually pulled, to disengage the hold back.

**CODE:**  
116578 Floor Mounted Door Closer  
119152 Floor Mounted Door Closer - With 85 degree Hold Back  
137325 Floor Mounted Door Closer - With 90 Degree Hold Back (Not suitable for use with Double Swing Hinge)  
142668 Floor Mounted Door Closer - To suit full time dual swing door

**RHINO MORTICE BOLT WITH REINFORCEMENT KIT**

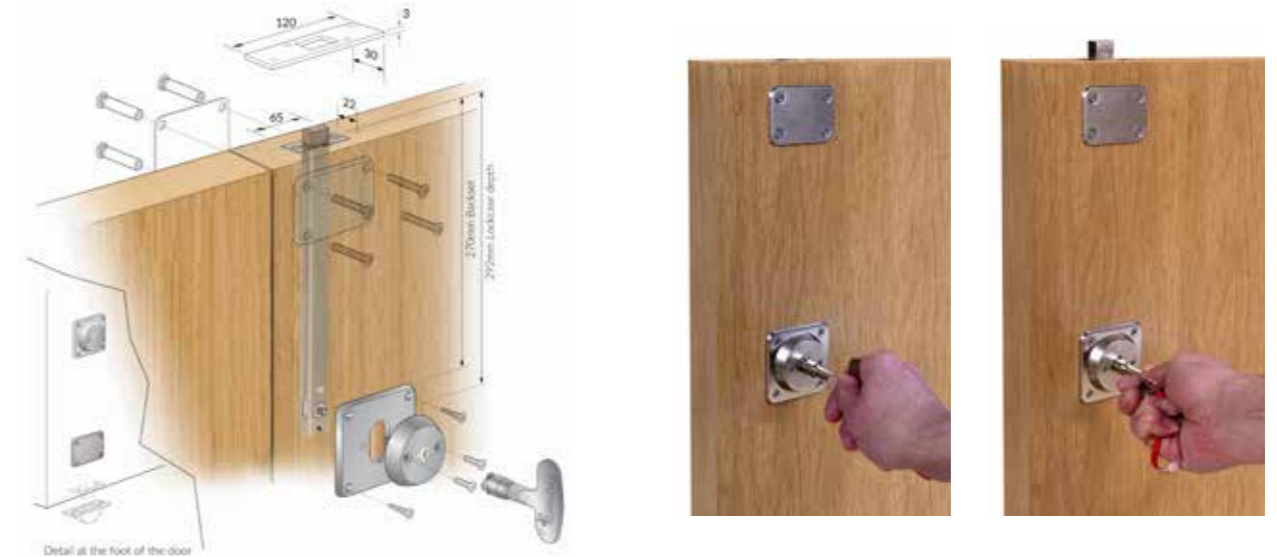

The Rhino Mortice Bolt is designed to secure second leaf doors in mental health environments. It can be fitted at the top and the bottom of a door (or both), and can also be installed horizontally for applications such as seclusion rooms where reinforced locking is required. An extended length bolt allows easy reach to the keyway, when locking and unlocking the door. The Rhino is supplied with reinforcing plates and bolt through fixings for higher levels of impact resistance and operates on the universal Lifeline Key platform (Requires Lifeline Key, refer page 82)

**CODE:**  
119150 Rhino-Lock Extended Rack Bolt c/w Reinforcing Kit (Requires Lifeline Key)

**RHINO JUNIOR BOLT**



The Rhino Junior Bolt is designed to secure second leaf doors in mental health environments. It can be fitted at the top and bottom of the door (or both). This product operates on the universal Lifeline Key platform (Requires Lifeline Key, refer page 82)

**CODE:**  
136354 Junior Rhino Bolt with Lifeline (Requires Lifeline Key)

### INTAGLAZE VISION PANEL



Optional Stainless Steel Surround  
(refer page 37)

254mm x 804mm

404mm x 404mm

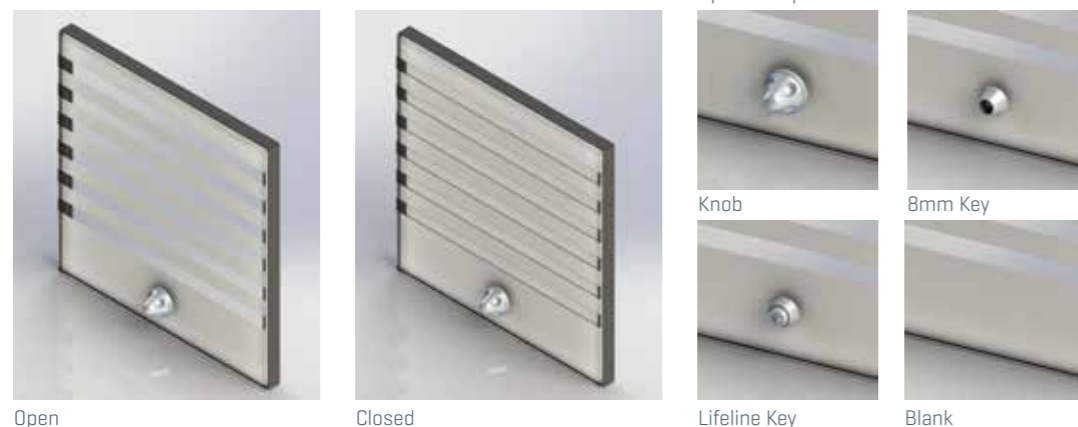

Operator Options

Open

Closed

Lifeline Key

Blank

The INTAGLaze is a tried and tested vision panel that ensures the security and dignity of both staff and patients. The quiet, manually operated panel requires no wiring or mains power. It is constructed using three panes of glass, the middle pane of glass moves up and down as required to align or misalign the stripes on the glass. When the stripes are aligned visibility is achieved through the gaps left between stripes. When the stripes are misaligned, this closes off the gaps to achieve privacy. This is an ideal solution for doors where visibility is required periodically however privacy is required the rest of the time. For example a patient bedroom door where privacy is required however regular observations need to be made by staff. The vision panels can be controlled by either a knob or key, depending on requirements.

#### INTAGLaze Benefits

- Monitor patients easily and safely whilst allowing a level of privacy
- Can be keyed to match other items at the facility to minimise the number of keys carried by staff (Lifeline and 8mm Key available)
- Omni-Directional Operator Design - easy to use whether right or left-handed

Standard Sizes: Rectangular 254 x 804mm, Square 404 x 404mm [Custom sizes available].

Standard Glass Options: 6mm, 10mm and 19mm Toughened Glass [Other glass options available].

Operator Options: Anti-Ligature Knob, Blank, 8mm Key, Lifeline Key.

Surround Options: Stainless Steel or Timber Beading.

Testing: Cycle tested to greater than 40,000 cycles [10 years typical use].

### IVISION VISION PANEL



Optional Stainless Steel Surround  
(refer page 37)

254mm x 804mm

404mm x 404mm

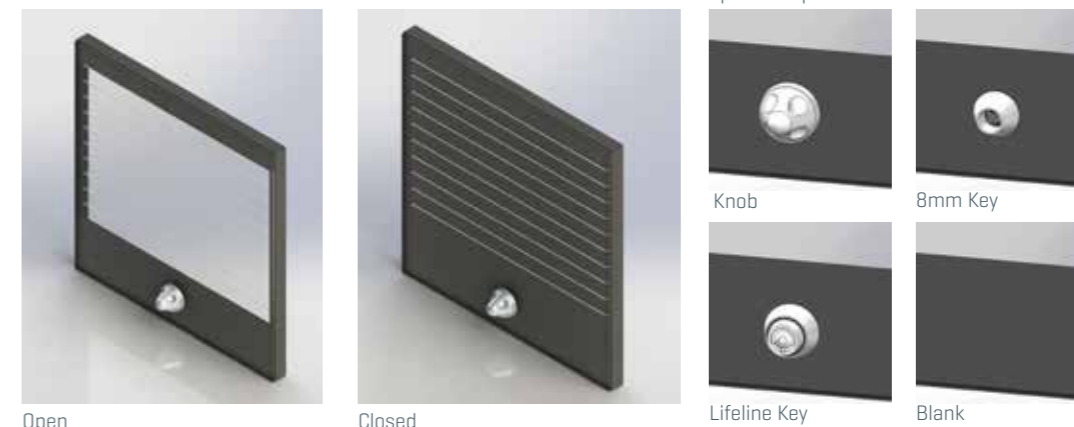

Operator Options

Open

Closed

Lifeline Key

Blank

The IVision panel is a unique design that allows up to twice the open area compared to other similar vision panels available on the market. This new and revolutionary product has an open and closed state. In the open state it provides up to 67% visibility on the 404 x 404mm panel, up to 80% visibility on a 254 x 804mm panel and blackout in its closed state. It is a quiet, manually operated panel requiring no wiring or mains power. This is an ideal solution for doors where visibility is required periodically however privacy is required the rest of the time. For example a patient bedroom door where privacy is required however regular observations need to be made by staff. The vision panels can be controlled by either a knob or key, depending on requirements.

#### IVision Benefits

- Monitor patients easily and safely whilst still allowing a level of privacy
- Can be keyed to match other items at the facility to minimise the number of keys carried by staff (Lifeline and 8mm Key available)
- Omni-Directional Operator Design - easy to use whether right or left-handed
- Quiet operation [controlled closing of glass and optional plastic key]

Standard Sizes: Rectangular 254 x 804mm, Square 404 x 404mm [Custom sizes available].

Standard Glass Options: 6mm, 10mm and 19mm Toughened Glass [Other glass options available].

Operator Options: Anti-Ligature Knob, Blank, 8mm Key, Lifeline Key.

Surround Options: Stainless steel or timber beading.

Testing: Cycle tested to greater than 40,000 cycles [10 years typical use].

### SECURA PRIVACY VISION PANELS

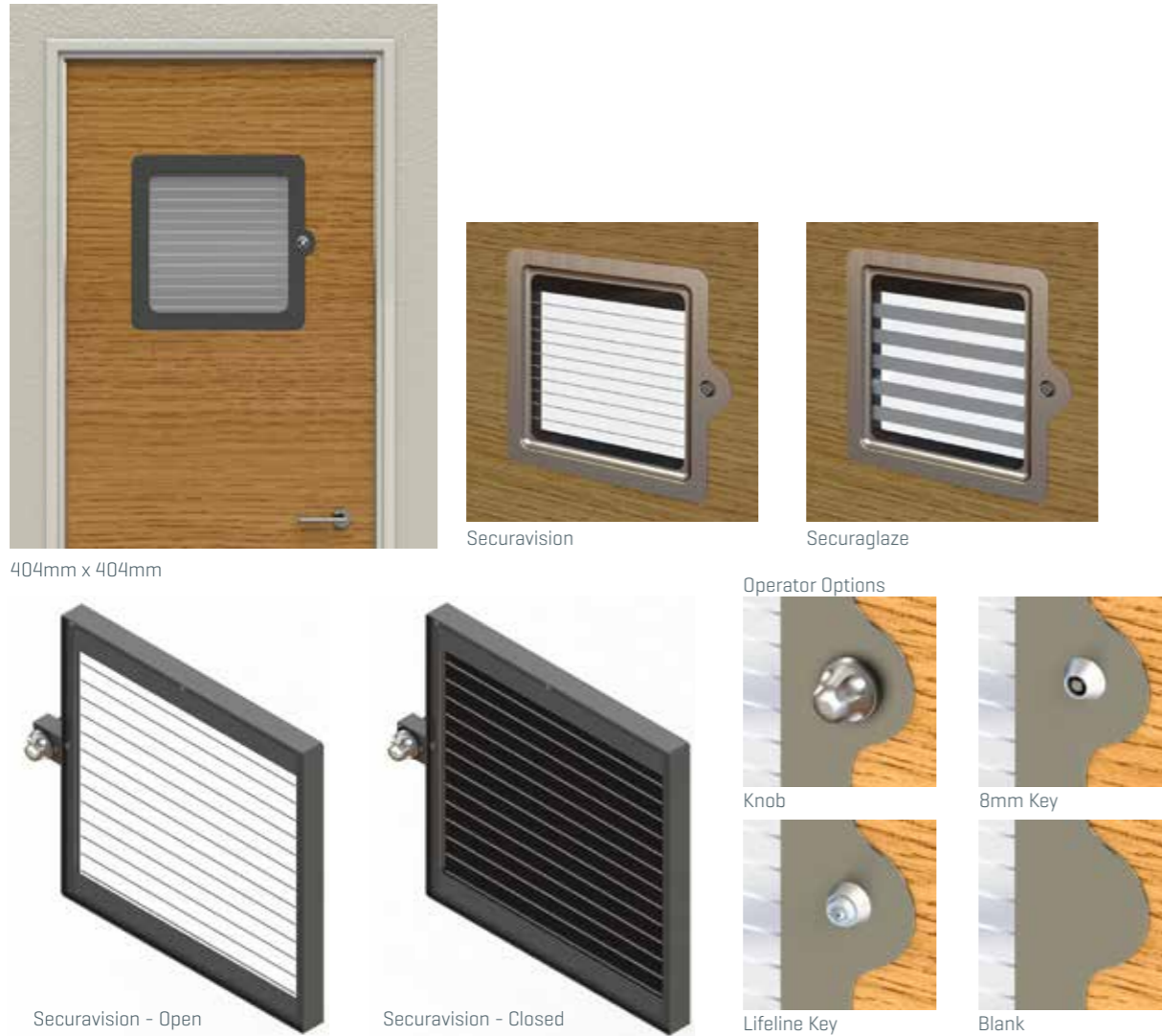

SECURA Glaze and SECURA Vision are upgraded versions of the Intaglaze and IVision panels. These are built into an integral pressed stainless-steel surround, and the operator is located in the surround rather than in the glass itself for added durability and abuse resistance. It is an ideal solution for applications such as seclusion rooms or other areas in which high levels of impact and abuse are expected. These are quiet, manually operated panels and require no wiring or mains power.

#### SECURA Features

- Provides 92% Visibility [SECURA Vision]
- Tested to the Medium Secure Abuse Standard

#### SECURA Benefits

- Monitor patients easily and safely whilst still allowing a level of privacy
- Can be keyed to match other items at the facility to minimise the number of keys carried by staff [Lifeline and 8mm Key available]
- Omni-Directional Operator Design - easy to use whether right or left handed
- Quiet operation [Controlled closing of glass and optional plastic key]

Standard Sizes: Rectangular 254 x 804mm, Square 404 x 404mm [Custom sizes available]

Standard Glass Options: 6mm, 10mm, 19mm Toughened Glass [Other glass options available]

Operator Options: Anti-Ligature Knob, Blank, 8mm Key, Lifeline Key,

Testing: Cycle tested to greater than 40,000 cycles [10 years typical use].

### STAINLESS STEEL SURROUND FOR INTAGLAZE AND IVISION PANELS



Designed specifically to suit the Intaglaze and Ivision Panels, these stylish 2mm thick brushed stainless steel surrounds provide maximum durability and are easy to maintain. They feature no visible fixings on the patient side of the panel and the pressed countersunk fixing holes help reduce the risk of the fixings pulling through the surround under the force of abuse. Security fixing screws included.

#### Stainless Steel Surround Features

- No visible fixings on patient side
- Softened inner and outer edges
- Security fasteners

#### Stainless Steel Surround Benefits

- Reduces risk of self-harm
- Helps eliminate ligature attachments
- Helps reduce infection control risks

Standard Sizes: Suits Rectangular 254 x 804mm and Square 404 x 404mm Vision Panels [Custom sizes available].

Standard Finish: Brushed stainless steel.

Designed to suit the Intaglaze and IVision Panels only.

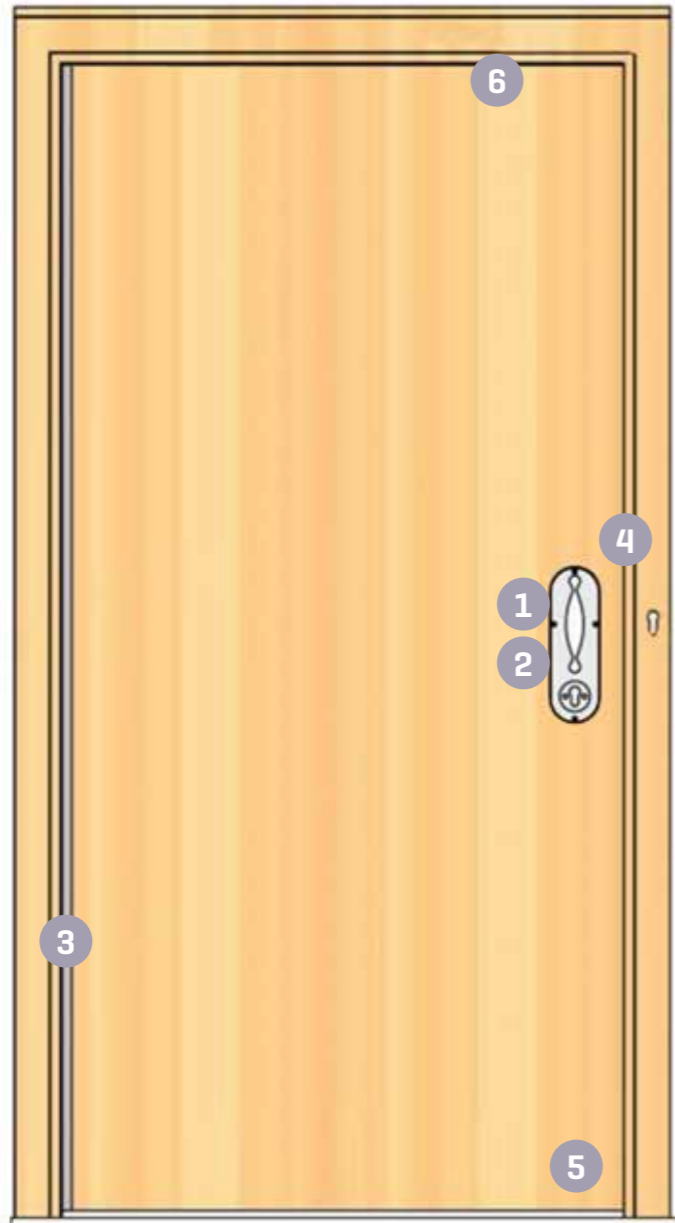

En-suite Door Sets	40
01. Locksets	42
02. Handles	46
03. Hinges	48, 50
04. Removable Door Stops	49
05. Door Stops	51
06. Door Top Alarm	52

### ANTI-LIGATURE EN-SUITE DOOR SET



The anti-ligature en-suite door set is a revolutionary architectural product for mental health environments, providing a practical solution for en-suite doors, that is completely free from any ligature points. The door set features two lightweight door leaves that attach to magnetic pivot points located on the frame. These magnetic pivot points allow for normal opening and closing of the doors however will release if an abnormal load is applied, such as a ligature attempt. These doors are waterproof and durable, their lightweight and flexible nature make them very ineffective weapons, minimising the risk that these could be used against staff or other patients. If fitted with the optional staff-only reset, once released, the door leaves require a staff key to reinstate them meaning that an attempted ligature attempt won't go unnoticed. This can provide invaluable feedback to staff as to the mindset of patients, who can then use this information to determine if additional care or observation is required. These door sets are designed to be quickly and easily retrofitted meaning that patient rooms should not need to be shut down for more than a couple of hours to enable installation.

#### Features

- Lightweight door leaves
- Magnetic load release pivots
- Optional staff only door reset
- Interchangeable door leaves with multiple designs available

#### Benefits

- No known ligature points
- Provides privacy and dignity without compromising on safety
- Interchangeable door leaves can allow users to customise the decor in their room potentially aiding recovery
- Quick install means minimal disturbance to use of patient rooms
- Restricted reset provides invaluable feedback to staff to prevent 'ligature learning'

#### CODE:

- 138150 En-suite Door Set with Staff Only Reset (Requires Lifeline Key)
- 141288 En-suite Door Set with Unrestricted Reset

### ANTI-LIGATURE SAFEDOOR



#### Suggested Graphic Options

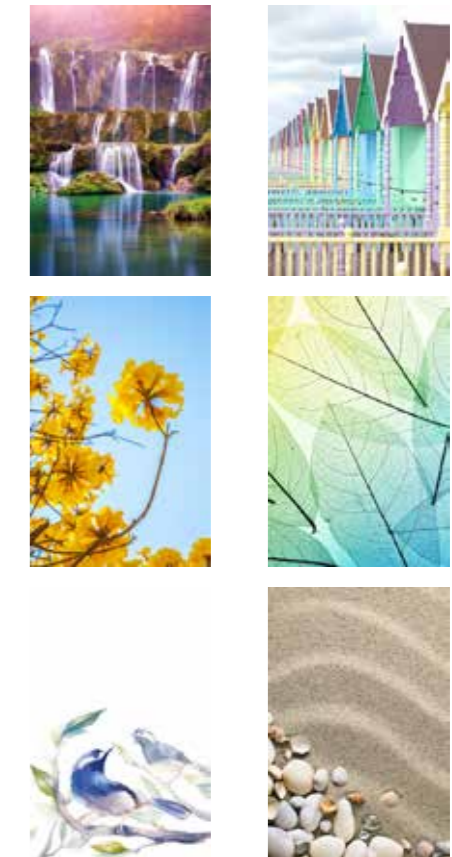

The SafeDoor has been designed to replace a traditional en-suite door and eliminates ligature risks associated with traditional doors and related hardware. It is a single piece, made to measure, lightweight door that attaches to the door frame using magnets built into the fabric hinge. It has been developed to be lightweight and durable, manufactured from a lightweight flexible core, wrapped in vinyl material with an anti-microbial formula to reduce hygiene risks and ensure it can withstand vigorous daily use. It is very easy to install, and in most cases will simply attach to a new or existing metal door frame without the need for tools.

#### Features

- Magnetic load release hinge
- Light-weight flexible door
- Stain and tear resistant material
- Self-extinguishing flame-retardant fabric
- Available in any colour or print

#### Benefits

- No known ligature points
- Provides privacy and dignity without compromising on safety
- Customisable design allows users to customise the decor in their room potentially aiding recovery
- Simple to install resulting in minimal disturbance to use of patient rooms
- Easy to clean

#### CODE:

- 138884 Anti-Ligature En-suite Door with Magnetic Hinge

### PR-1-56 INDICATOR LOCKSET



Level A4  
TS001 Grade



1 Way  
Override



Euro Profile  
Key Cylinder

TO LOCK		TO UNLOCK	
Internal Handle	External Key	Internal Handle	External Key

### PR-3S-56 INDICATOR LOCKSET



Level A4  
TS001 Grade



5 Way  
Override



Euro Profile  
Key Cylinder

TO LOCK		TO UNLOCK	
Internal Handle	External Key	Internal Handle	External Key

### PR-LL-56 INDICATOR LOCKSET



Level A4  
TS001 Grade



1 Way  
Override

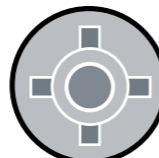

Lifeline  
Key Cylinder

TO LOCK		TO UNLOCK	
Internal Handle	External Key	Internal Handle	External Key

### COMMON HANDLE OPTIONS

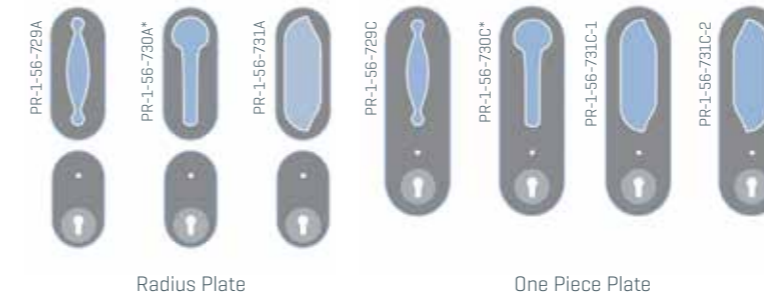

Square plate options available to order.  
\*All 730 Elephants Trunk Handles become TS001 Level B4, rather than A4.

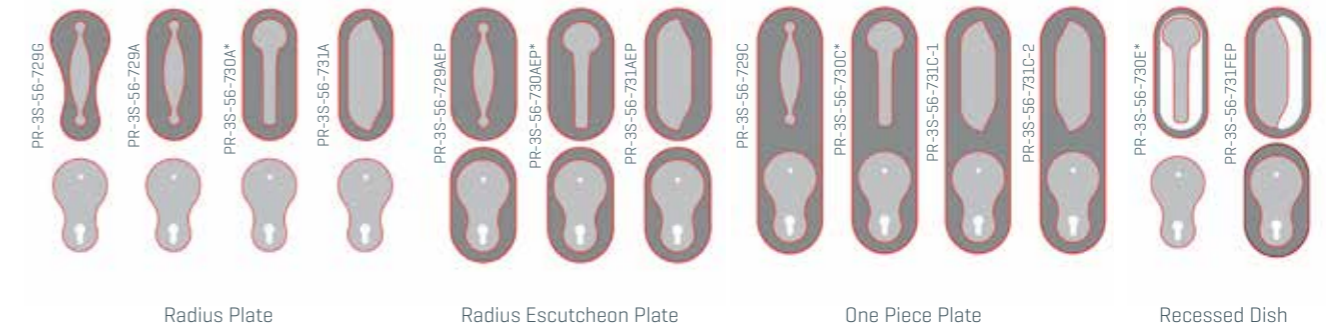

Square plate options available to order, for some handles.  
\*All 730 Elephants Trunk Handles become TS001 Level B4, rather than A4.

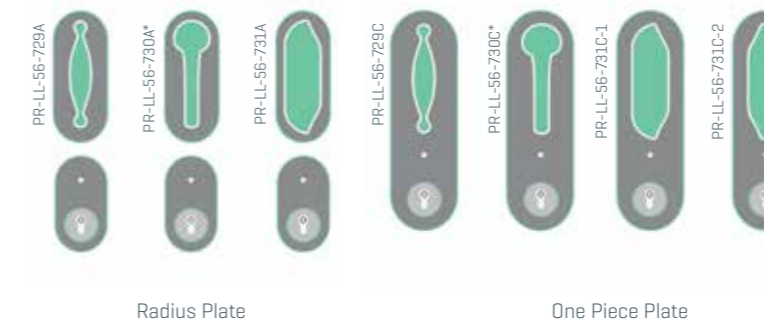

Square plate options available to order, for some handles.  
\*All 730 Elephants Trunk Handles become TS001 Level B4, rather than A4.

# Bathroom/En-suite Door Products

## Locksets

### PR-1-76 EN-SUITE LOCKSET



Level A4  
TS001 Grade



1 Way  
Override



Euro Profile  
Key Cylinder

TO LOCK		TO UNLOCK	
Internal N/A	External Key	Internal N/A	External Key

### PR-3S-76 EN-SUITE LOCKSET



Level A4  
TS001 Grade



5 Way  
Override



Euro Profile  
Key Cylinder

TO LOCK		TO UNLOCK	
Internal N/A	External Key	Internal N/A	External Key

### PR-LL-76 EN-SUITE LOCKSET



Level A4  
TS001 Grade



1 Way  
Override

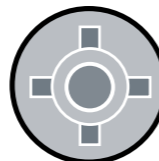

Lifeline  
Key Cylinder

TO LOCK		TO UNLOCK	
Internal N/A	External Key	Internal N/A	External Key

### COMMON HANDLE OPTIONS

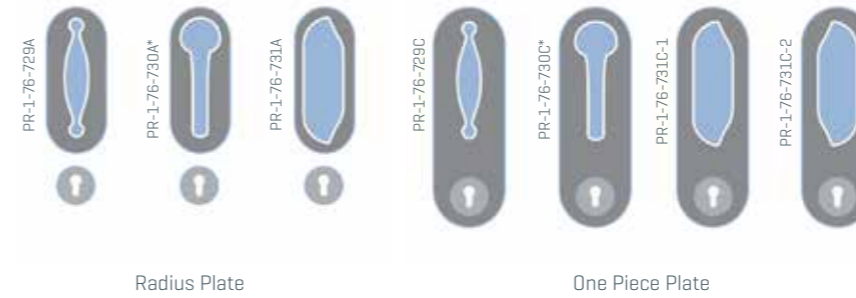

Square plate options available to order.  
\*All 730 Elephants Trunk Handles become TS001 Level B4, rather than A4.

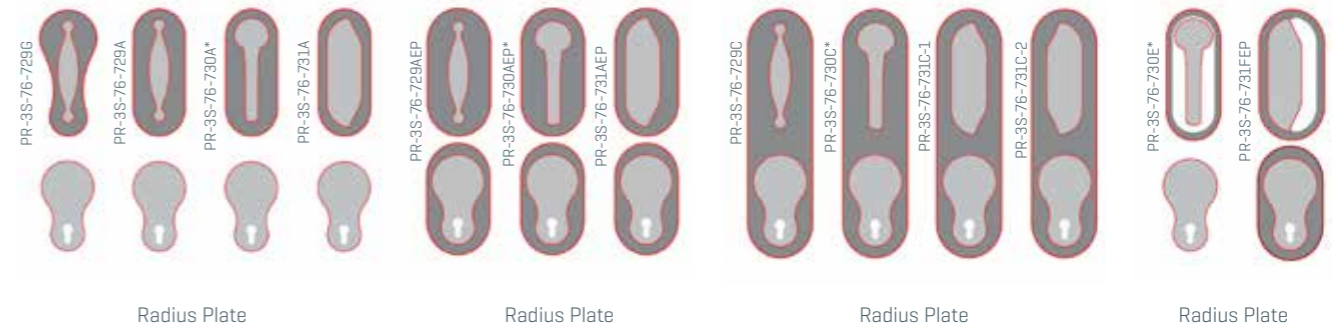

Square plate options available to order, for some handles.  
\*All 730 Elephants Trunk Handles become TS001 Level B4, rather than A4.

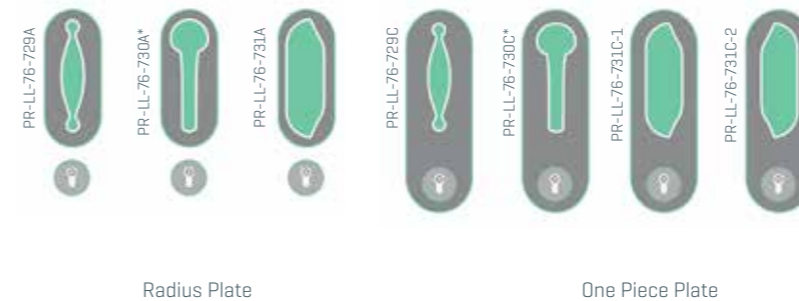

Square plate options available to order, for some handles.  
\*All 730 Elephants Trunk Handles become TS001 Level B4, rather than A4.

### PINCH GRIP PULL HANDLES

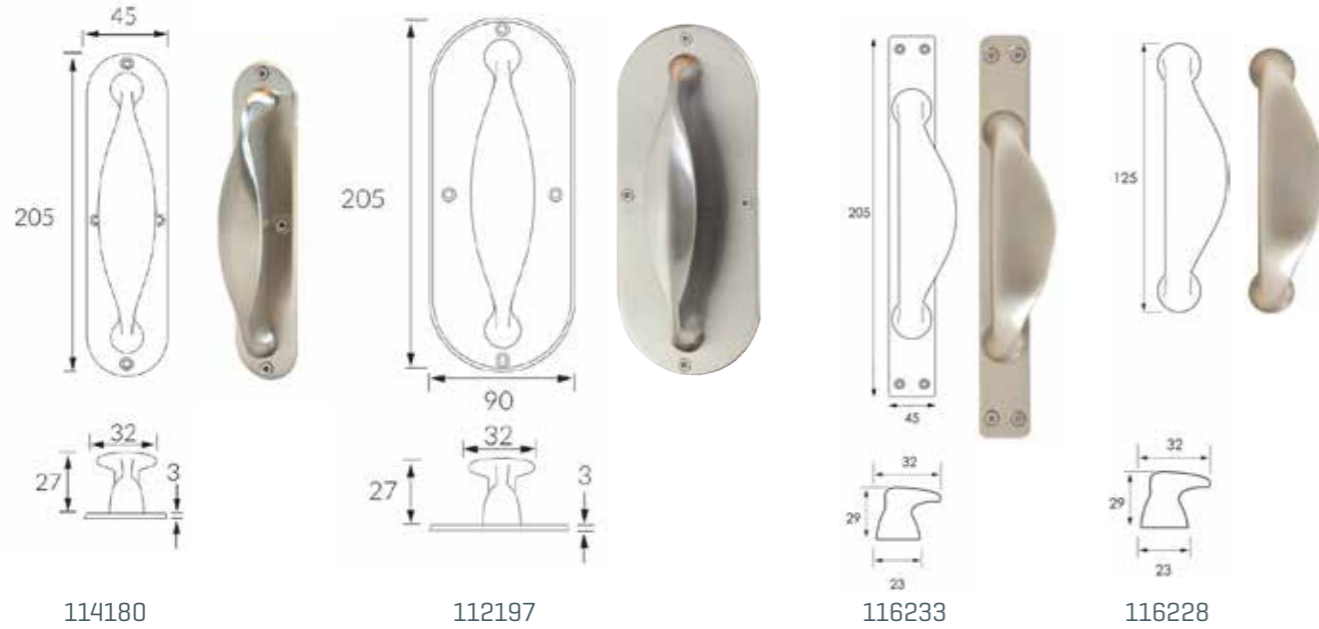

**CODE:**

- 114180 729 Pinch Grip Pull Handle on Narrow Radius Plate 45mm x 205mm
- 112197 Pinch Grip Pull Handle on 90mm x 205mm Backplate
- 116233 727 Pinch Grip Pull Handles on Square Plate 45 x 205mm
- 116228 727 Pinch Grip Pull Handle without Backplate



### ELEPHANTS TRUNK PULL HANDLE

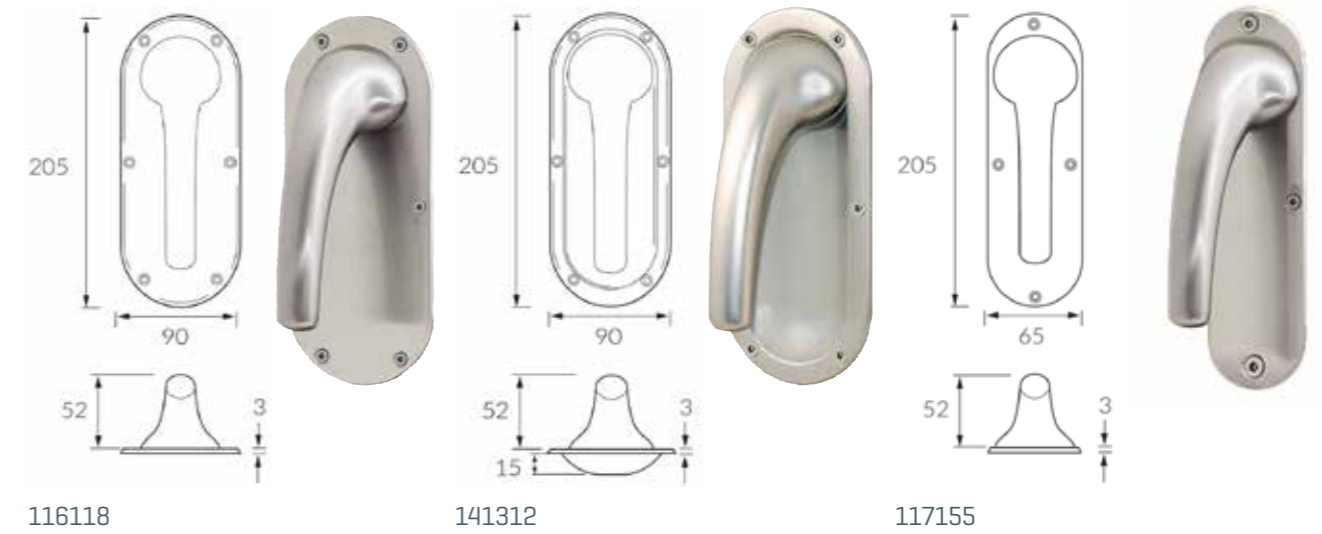

**CODE:**

- 116118 730 Elephants Trunk Handle on 90 x 205mm Radius Backplate
- 141312 730 Elephant Trunk Handle on Recessed Dish
- 117155 730 Elephants Trunk Handle on Narrow Radius Plate 65 x 205mm

USE WITH CAUTION



### SURE GRIP PULL HANDLE

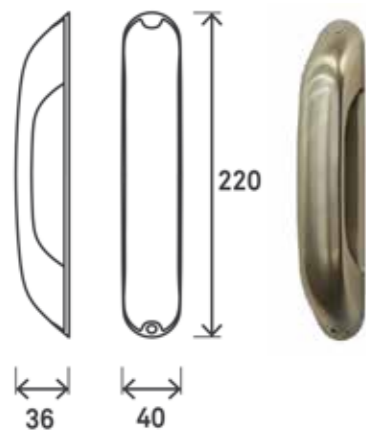

**CODE:**

- 142949 732 Sure Grip Pull Handle on Invisible Backplate, 40 x 220mm



### RECESSED PULL HANDLE

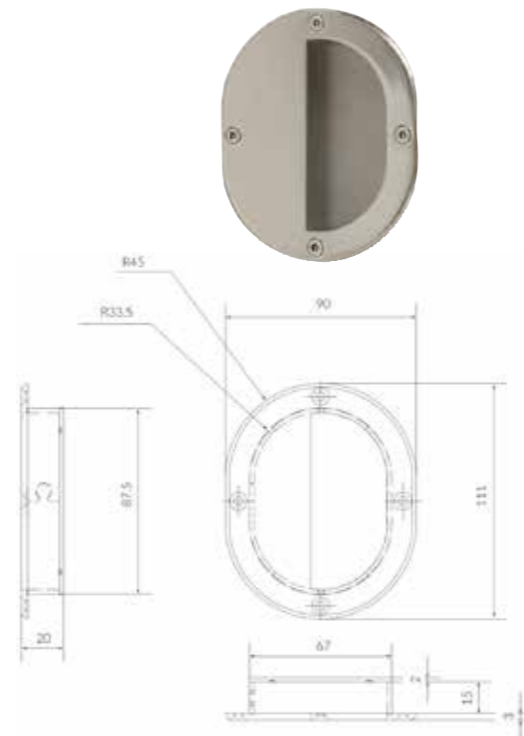

**CODE:**

- 117072 726 Recessed Flush Pull Handle, 90 x 111mm



### GRAB (RECESSED OR FLAT PLATE) ANTI-LIGATURE DOOR HANDLES

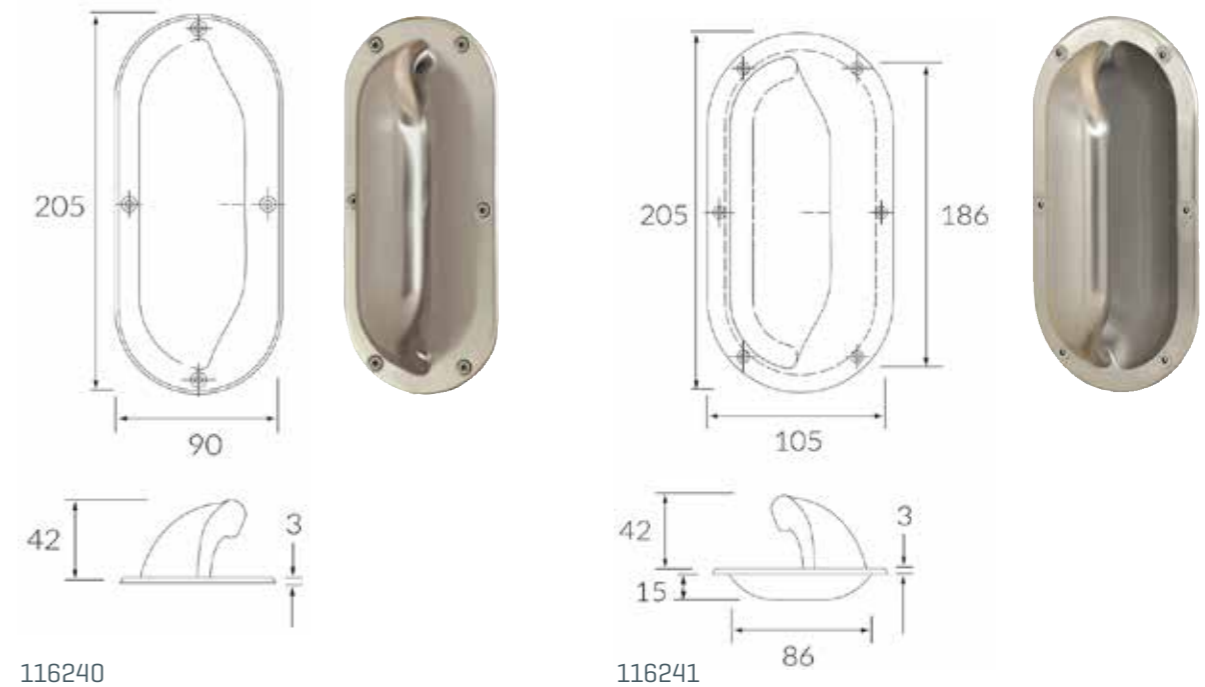

**CODE:**

- 116240 731 Grab Pull Handle on 90mm x 205mm Backplate
- 116241 731 Grab Pull Handle on Recessed Dish





**DOUBLE SWING FULL LENGTH GEARED HINGE**



The double swing hinge is a full length continuous geared hinge that provides a solution for doors that are required to swing 90 degrees in either direction. It is predominantly used in conjunction with a removable/detachable door stop, as where barricading is a risk it allows the door to swing in either direction [refer page 49]. As it is continuous it removes the ligature risks that are associated with the gaps between door and frame that are left by pivots and traditional hinges. These hinges can also be used on doors as a more durable alternative to pivots. This Double Swing Hinge can also be used in conjunction with the Floor Mounted Door Closer [refer page 32].

**CODE:**

- 114616 Double Swing Geared Hinge Full Length 2100mm [To Suit 44mm Door]
- 119211 Double Swing Geared Hinge Full Length 2400mm [To Suit 44mm Door]



**DOUBLE SWING SHROUDED HINGE**



The shrouded double swing hinge, like the standard double swing hinge, is a full length continuous geared hinge that provides a solution for doors that are required to swing 90 degrees in either direction. The unique shrouded design adds additional protection against ligature attempts, tampering, and finger entrapment. It is predominantly used in conjunction with a removable/detachable door stop where barricading is a risk as it allows the door to swing in either direction as required [refer page 49]. As it is continuous it removes the ligature risks that are associated with the gaps between door and frame that are left by pivots and traditional hinges. These hinges can also be used on doors as a more durable alternative to pivots. This Shrouded Double Swing Hinge can also be used in conjunction with the Floor Mounted Door Closer [refer page 32].

**CODE:**

- 142837 Shrouded Double Swing Geared Hinge Full Length 2100mm
- 142838 Shrouded Double Swing Geared Hinge Full Length 2400mm



**MOVASTOP DETACHABLE DOOR STOP**

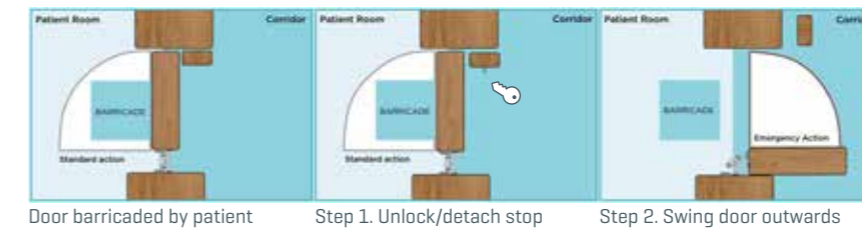

Door barricaded by patient Step 1. Unlock/detach stop Step 2. Swing door outwards

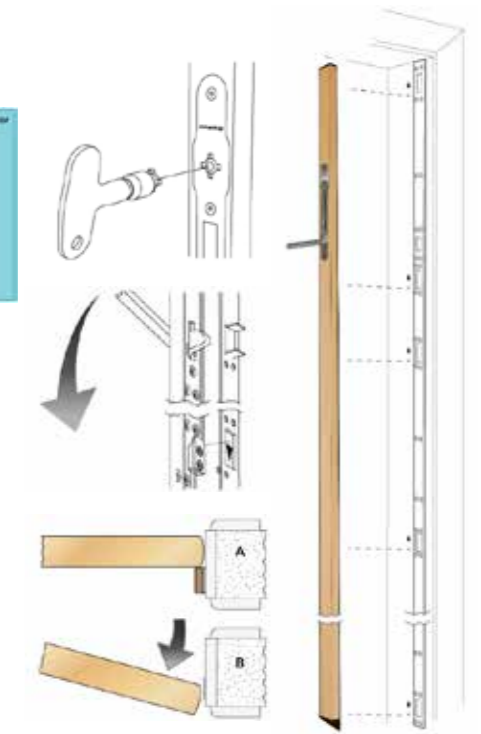

The Movastop detachable door stop, in conjunction with a double swing hinge is another effective solution to help overcome a barricade situation. During normal use the stop remains locked to the door frame to act as a traditional stop and prevents the door from swinging outward. In the event of a barricade, staff can fully detach the Movastop from the door frame, using a Lifeline key. This allows the door to swing in an outward direction and away from the barricade. The Movastop blends in well with the door frame and is robust and resistant to abuse and tampering.

**CODE:**

- 119120 Movastop Detachable Door Stop up to 2100mm - White [Requires Lifeline Key]
- 119122 Movastop Parking Facility - White



**REMOVABLE DOOR STOP, ALUMINIUM**

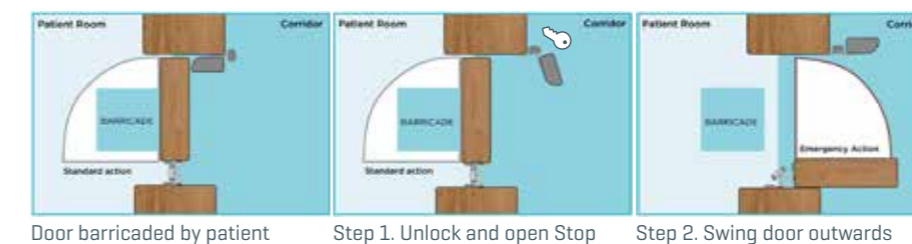

Door barricaded by patient Step 1. Unlock and open Stop Step 2. Swing door outwards



The removable door stop, in conjunction with a double swing hinge is an effective solution to overcoming barricade attempts. During normal use the stop remains locked to the door frame to act as a traditional stop and prevents the door from swinging outward. In the event of a barricade, the removable stop can be unlatched from the frame (using a key) and opened outward, allowing the door to swing away from the barricade.

**CODE:**

- 116994 Removable Door Stop, Right Handed, 2100mm [Requires 4mm Key]
- 116995 Removable Door Stop, Left Handed, 2100mm [Requires 4mm Key]
- 138642 Removable Door Stop Right Handed, 2400mm [Requires 4mm Key]
- 138643 Removable Door Stop Left Handed, 2400mm [Requires 4mm Key]



**SINGLE SWING FULL LENGTH ANTI-LIGATURE GEARED SECURAHINGE**



The Securahinge is a full length continuous geared hinge fitted with a sloping cap and specially designed bearings to overcome the risks of ligature and self-harm. As it runs the full length of the door it removes the ligature risks associated with the gaps between the door leaf and frame left by butt or piano style hinges. The Securahinge opens up to 180 degrees in one direction so is suitable for applications in which the door is required to fold back against the wall. The Securahinge can be installed in conjunction with the Floor Mounted Door Closer or the Concealed Door Closer [refer page 32].

**CODE:**

- 111916 Securahinge, Standard Duty - up to 125kg, 32mm leaf, 2100mm
- 117090 Securahinge, Heavy Duty - up to 245kg, 32mm leaf, 2100mm
- 116479 Securahinge, Extreme Duty - up to 245kg, 43mm leaf, 2100mm
- 113638 Securahinge, Standard Duty - up to 125kg, 32mm leaf, 2400mm
- 117091 Securahinge, Heavy Duty - up to 245kg, 32mm leaf, 2400mm
- 117092 Securahinge, Extreme Duty - up to 245kg, 43mm leaf, 2400mm



**FINGER PROTECTIVE DOUBLE SWING HINGE**



In addition to all the benefits of the standard Double Swing Hinge, this product allows for greater than 90 degrees opening in both directions, whilst retaining a clearance gap that prevents fingers being trapped, even in the event of the door being slammed shut. With this unique design ensuring a clearance gap, this hinge provides permanent finger protection and will not wear out.

Like the Double Swing Hinge, the Finger Protective Double Swing Hinge can also be used in conjunction with a concealed floor mounted door closer [refer page 32].

**CODE:**

- 117159 Double Swing Finger Protective Geared hinge 2100mm
- 138623 Double Swing Finger Protective Geared Hinge 2400mm



**ELECTRICALLY MODIFIED HINGE SECTION**



The electrically modified hinge section provides a concealed and anti-ligature method of transferring power between the door frame and door. This is designed to be installed in conjunction with a full length hinge and can be fitted at the required height by cutting the full length hinge and butting the sections together. This allows the electrically modified hinge section to be serviced or replaced, without removing the door from the frame. Hinge sections come with 1.5m and 3m extension cables to suit.

**CODE:**

- 119151 Double Swing Geared Hinge Full Length, 200mm Section, 4 Wire
- 136766 Double Swing Geared Hinge Full Length, 200mm Section, 8 Wire
- 136767 Double Swing Geared Hinge Full Length, 200mm Section, 12 Wire
- 117630 Single Swing Geared SECURAHinge Full Length, 200mm Section, 4 Wire
- 117767 Single Swing Geared SECURAHinge Full Length 200mm Section, 8 Wire
- 117768 Single Swing Geared SECURAHinge Full Length 200mm Section, 12 Wire
- 142841 Shrouded Double Swing Electrically Modified Hinge 200mm, 4 Wire
- 142842 Shrouded Double Swing Electrically Modified Hinge 200mm, 8 Wire
- 142843 Shrouded Double Swing Electrically Modified Hinge 200mm, 12 Wire

\*Special versions available to suit Door top Alarm.

**MOULDED HEAVY DUTY DOOR STOP**

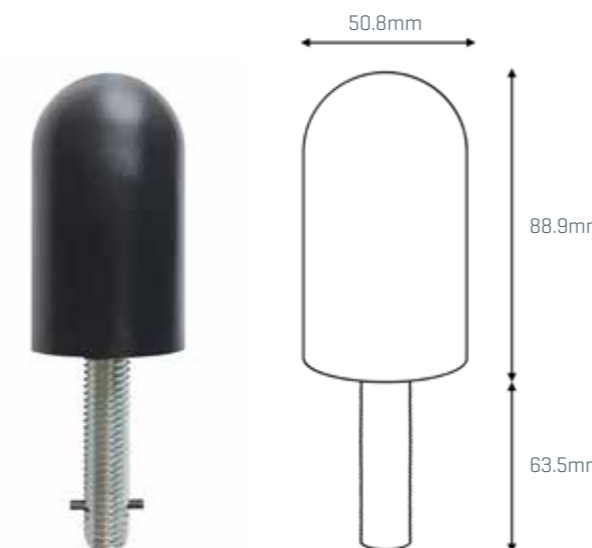

Heavy duty moulded rubber stop designed to restrict the opening angle of the door and/or prevent the door impacting the wall. Vandal resistant, no exposed fasteners, resistant to patient tampering, and is flame resistant. It is suitable for floor or wall mounting.

**CODE:**

- 119400 Heavy Duty Moulded Door Stop

**DOME WALL STOP**

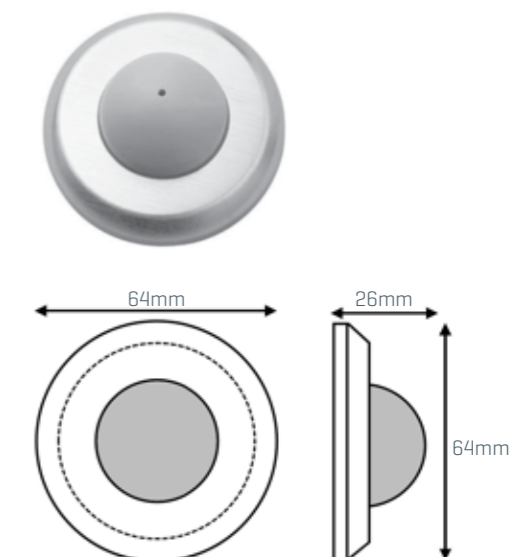

Dome bumper constructed from soft rubber with 304 stainless steel surround. Sloped design with no ligature points. Fixing screw is concealed to prevent patient tampering.

**CODE:**

- 120433 Dome Wall Stop

### DOOR TOP ALARM



The Door Top Alarm (DTA) is a technology and hardware product that is integrated into the head (top) of a timber door, to alert staff of a potential ligature attempt.

It sends a signal to the staff attack system to alert the clinical team when a patient has attempted to jam an item between the head of the door and the door frame.



The DTA has a discreet sensor which is installed across the full width of the door leaf, which detects if weight has been applied e.g. the weight from a ligature attempt using the top of the door, or if something is jammed between the top of the door and head of the frame. To minimise false alarms, the system has a built in time delay that is adjustable between 5 and 30 seconds. This ensures that the alarm won't be triggered by accidental bumps or patients playing with the sensor, only a sustained applied weight (as would be the case in a ligature attempt) will trigger the alarm and alert staff to respond.

The door top alarm is compatible with most duress or staff attack systems. When the alarm is triggered, a signal is sent to the designated system which then alerts staff via whichever means are currently in use by the facility and clinical team. This could be an audible alarm, staff indicator panel, pager, handsets, or main nurse station computer.

#### CODE:

- 120120 Door Top Alarm Kit to suit 44mm Width Door
- 136399 Door Top Alarm Kit to suit 54mm Width Door

### HOW THE DOOR TOP ALARM SYSTEM WORKS

1. Ligature Attempt in Patient Room.



2. Alarm on door top activates and a signal is sent from the electronic control box housed in the ceiling, to the staff attack system.

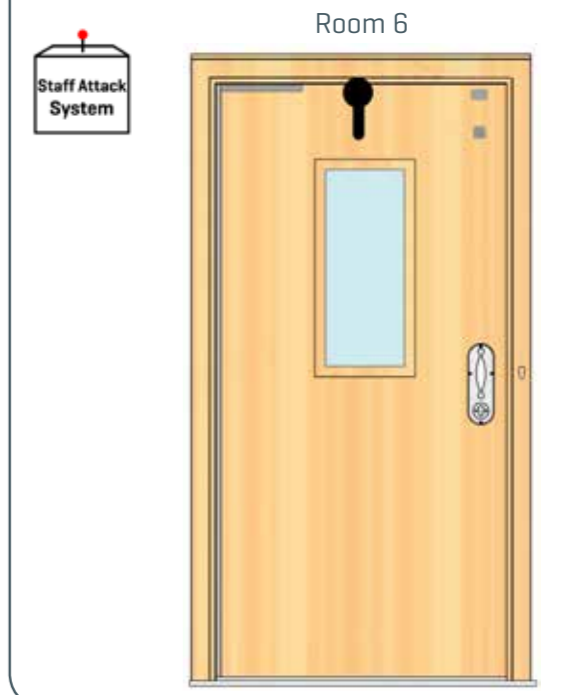

3. The staff attack system alerts the clinical team via an audible alarm, visible light, staff indicator panel, staff pagers/handsets, main nurse station computer or any other method employed by the system/facility.



Room 1	Room 2	Room 3
Room 4	Room 5	Room 6 ALERT
Room 7	Room 8	Room 9

4. Staff attend the patient room.



## PR-1-86 LATCH-LOCK (KEY/KEY) LOCKSET



Level A4  
TS001 Grade



1 Way  
Override



Euro Profile  
Key Cylinder

TO LOCK		TO UNLOCK	
Internal	External	Internal	External
Close Door	Close Door	Key/Swipe*	Key/Swipe*

\*If used in conjunction with electric strike 114086 - refer page 81.

## PR-3S-86 LATCH-LOCK (KEY/KEY) LOCKSET



Level A4  
TS001 Grade



5 Way  
Override



Euro Profile  
Key Cylinder

TO LOCK		TO UNLOCK	
Internal	External	Internal	External
Close Door	Close Door	Key/Swipe*	Key/Swipe*

\*If used in conjunction with electric strike 114086 - refer page 81.

## PR-LL-86 LATCH-LOCK (KEY/KEY) LOCKSET



Level A4  
TS001 Grade



1 Way  
Override

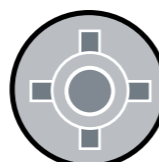

Lifeline  
Key Cylinder

TO LOCK		TO UNLOCK	
Internal	External	Internal	External
Close Door	Close Door	Key/Swipe*	Key/Swipe*

\*If used in conjunction with electric strike 114086 - refer page 81.

## COMMON HANDLE OPTIONS

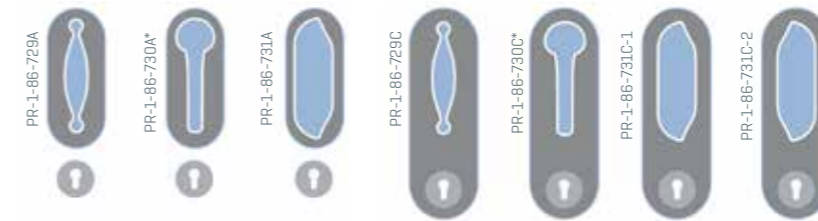

Radius Plate

One Piece Plate

Square plate options available to order.

\*All 730 Elephants Trunk Handles become TS001 Level B4, rather than A4.

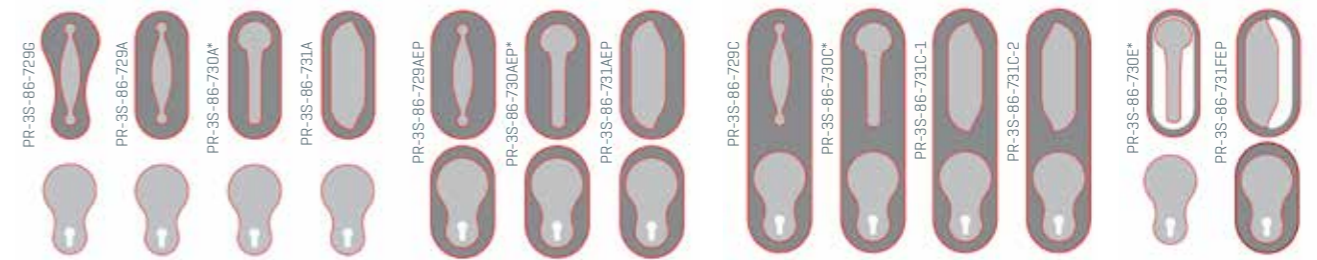

Radius Plate

Radius Escutcheon Plate

One Piece Plate

Recessed Dish

Square plate options available to order, for some handles.

\*All 730 Elephants Trunk Handles become TS001 Level B4, rather than A4.

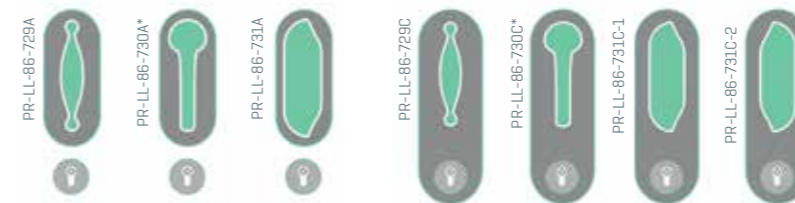

Radius Plate

One Piece Plate

Square plate options available to order, for some handles.

\*All 730 Elephants Trunk Handles become TS001 Level B4, rather than A4.

## PR-1-96 COMMUNAL LOCKSET



Level A4  
TS001 Grade



1 Way  
Override



Euro Profile  
Key Cylinder

TO LOCK		TO UNLOCK	
Internal Key	External Key	Internal Key	External Key

## COMMON HANDLE OPTIONS

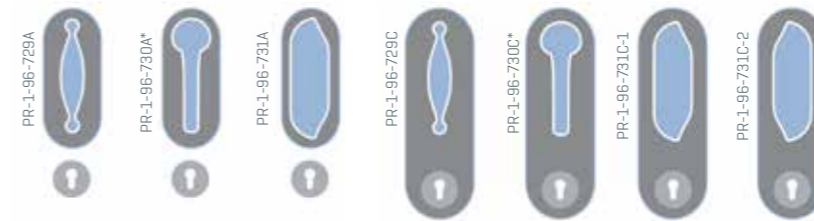

Radius Plate

One Piece Plate

Square plate options available to order.  
\*All 730 Elephants Trunk Handles become TS001 Level B4, rather than A4.

## PR-3S-96 COMMUNAL LOCKSET



Level A4  
TS001 Grade



5 Way  
Override



Euro Profile  
Key Cylinder

TO LOCK		TO UNLOCK	
Internal Key	External Key	Internal Key	External Key

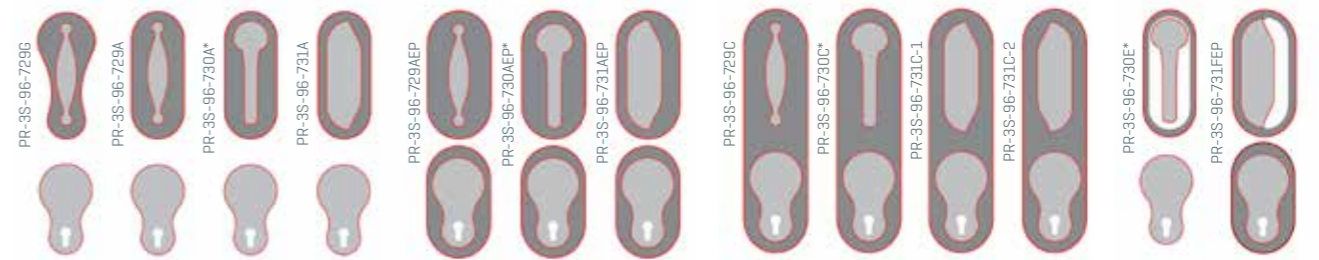

Radius Plate

Radius Escutcheon Plate

One Piece Plate

Recessed Dish

Square plate options available to order, for some handles.  
\*All 730 Elephants Trunk Handles become TS001 Level B4, rather than A4.

## PR-LL-96 COMMUNAL LOCKSET



Level A4  
TS001 Grade



1 Way  
Override

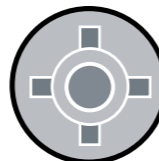

Lifeline  
Key Cylinder

TO LOCK		TO UNLOCK	
Internal Key	External Key	Internal Key	External Key

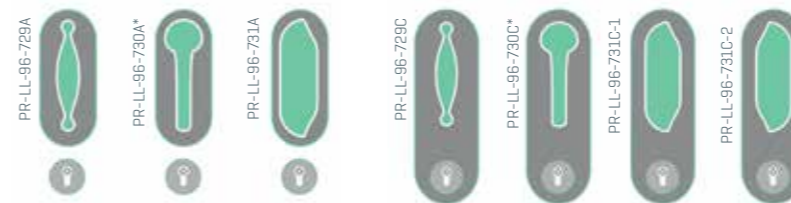

Radius Plate

One Piece Plate

Square plate options available to order, for some handles.  
\*All 730 Elephants Trunk Handles become TS001 Level B4, rather than A4.

## PR-1-16 SERVICE RISER DEADBOLT LOCKSET



Level A4  
TS001 Grade



1 Way  
Override



Euro Profile  
Key Cylinder

TO LOCK		TO UNLOCK	
Internal N/A	External Key	Internal N/A	External Key

## COMMON HANDLE OPTIONS

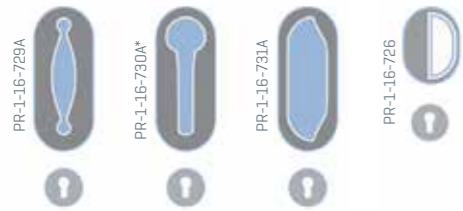

Radius Plate

Flush Fit Handle

Square plate options available to order, for some handles.  
\*All 730 Elephants Trunk Handles become TS001 Level B4, rather than A4.

## WINDOW PUSH/PULL HANDLE WITH ROLLER LATCHING DEADLOCK



A robust narrow backset mortise deadbolt with roller bolt latching. This lock brings a high level of security and flexibility of operation, to top and side hung sash windows. The roller catch enables patients to be able to latch the window closed however the locking function is restricted to staff key for security. The lock requires a standard euro cylinder which enables master keying.

### CODE:

141334 PR-8PHS5-CML Window Push/Pull Handle on Backplate c/w Narrow Roller Bolt Deadlock



## WINDOW PUSH/PULL HANDLE WITH LIFELINE KEY LOCKING



This anti-ligature window handle is ideal for hinged windows and utilises the Lifeline key system for its locking mechanism, enabling staff to stay in full control of the window use at all times. The Lifeline key is the same universal key that is used on a wide range of products including door locksets, vision panels and anti-barricade stops and systems. The use of a staff-only key reduces the risk of stolen or lost keys, and limits the potential for service users to block keyways, keeping windows operational and reducing maintenance issues and costs.

### CODE:

137552 PR-8PHS6-LL - Window Push/Pull Handle on 6mm Backplate [Requires Lifeline Key]



## WINDOW PUSH/PULL HANDLE WITH CAMLOCK



This anti-ligature window handle is ideal for hinged windows and incorporates a cam lock with solid 3mm cam arm for security and maintaining control of the window opening. It is supplied as standard with keyed-alike keys so that all windows will operate with the same keys for convenience however, is also available with keys unique to each window, known as keyed-to-differ.

### CODE:

142882 PR-8PHS4-CAM - Window Push/Pull Handle with Camlock c/w 2 Keys



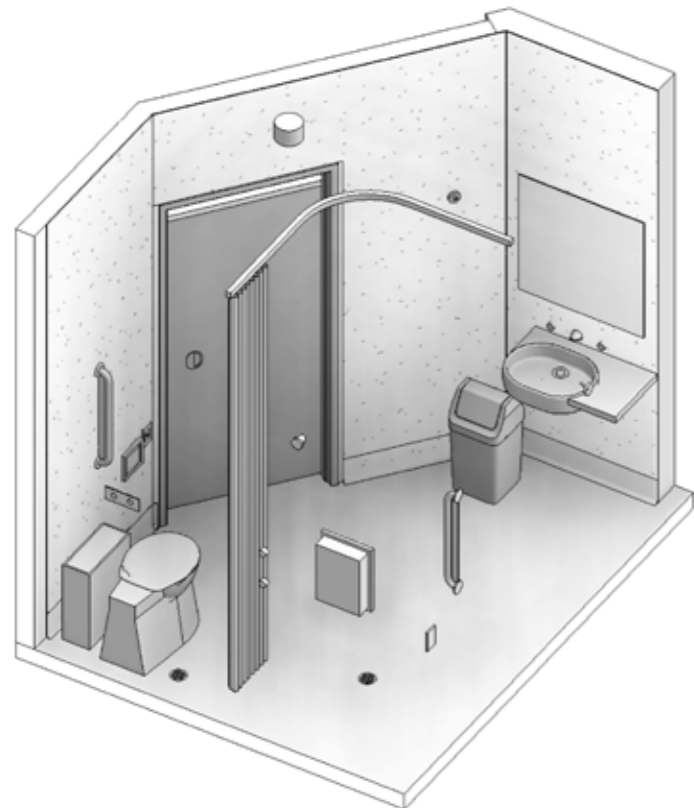
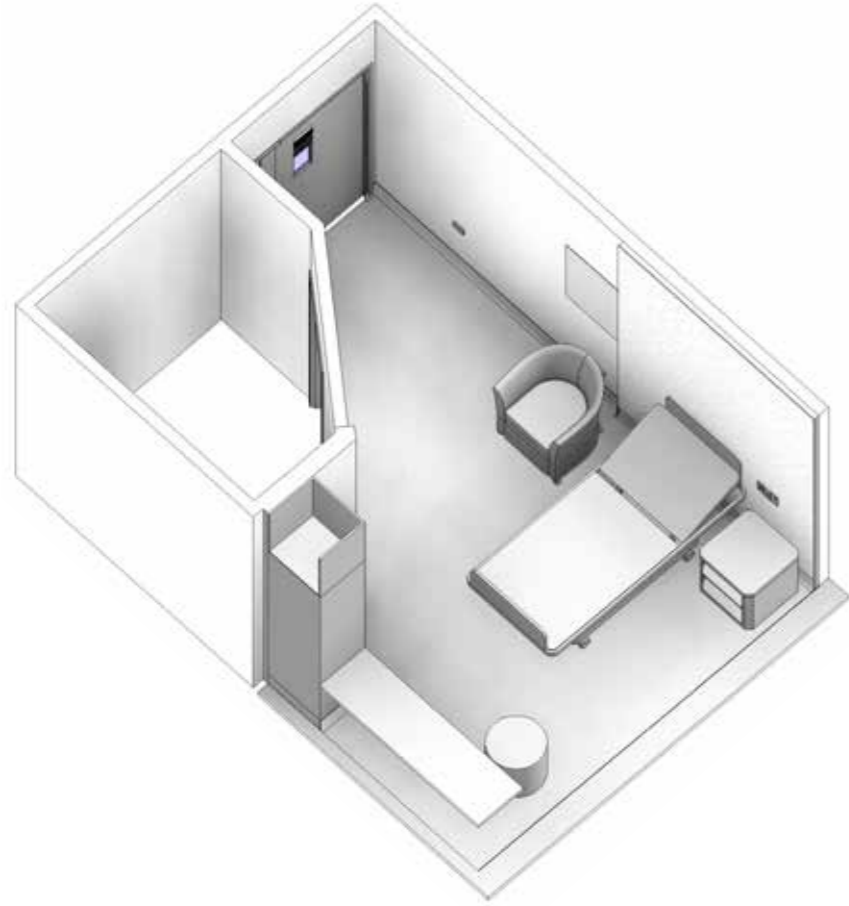

Curtains & Blinds	62
Mirrors	65
Towel & Wardrobe Rails	66
Coat & Towel Hooks	68
Toilet Roll Holders	69
Shelves & Dispensers	70
Tapware & Sanitaryware	74
Grab/Hand Rails	78

### KESTREL ANTI-LIGATURE SLOW-RISE SPRING ROLLER BLIND



The Kestrel anti-ligature slow rise spring roller blind operates on the slow-rise principle, to ensure that when the blind is released from its ratchet-stop, it will glide slowly and smoothly up to its fully open position. It is fitted with Kestrel magnetic suspension brackets that will release if an abnormal load, such as an attempted ligature, is applied to the blind, removing any ligature points. After the event, the blind can easily be refitted by simply placing it back onto the magnetic brackets. Available as standard with the following fabrics from the Hunter Douglas range: Plaza, Optimaplus and Elements.

**Specification:** Kestrel anti-ligature slow-rise spring roller blind fitted with magnetic wall-fix or top-fix brackets as necessary, spaced in accordance with manufacturers recommendations.

### KESTREL VITESSE K6200 ANTI-LIGATURE WINDOW CURTAIN TRACKING



The Vitesse K6200 is a high performance, lightweight, hand drawn window curtain tracking system. It is fitted with roller runners which makes it ideally suited to most applications. The K6200 tracking system becomes anti-ligature when it is installed in conjunction with Kestrel magnetic load release brackets. This ensures that if an abnormal load, such as an attempted ligature, is applied to the track, it will release, removing any ligature points. After the event the tracking can easily be refitted by simply placing the track back onto the magnetic brackets.

**Specification:** Vitesse K6200 hand drawn curtain track with Kestrel Magnetic Suspension System. White aluminium track complete with 16 roller runners per metre, and magnetic wall-fix or top-fix brackets as necessary, spaced in accordance with the manufacturers recommendations.

### KESTREL VITESSE K9500 ANTI-LIGATURE FLEXIBLE CURTAIN TRACKING



The Vitesse K9500 is an anti-ligature flexible curtain tracking system that is manufactured from a special plastic formulation, which is designed to be flexible enough to prevent its use as a weapon by prisoners or violent psychiatric patients. It is shatterproof and will not produce sharp edges, if deliberately broken. It is attached to the ceiling or wall with Kestrel magnetic load release brackets, to ensure that if an abnormal load, such as an attempted ligature, is applied to the track, it will release, removing any ligature points. After the event, the tracking can easily be refitted by simply placing it back onto the magnetic brackets. It is recommended for use only with lightweight curtains and where the risk of violence precludes the use of Vitesse K6200 aluminium track.

**Specification:** Vitesse K9500 Flexible hand drawn curtain track with Kestrel Magnetic Suspension System. White plastic track complete with 16 gliders per metre, and magnetic wall-fix or top-fix brackets as necessary, spaced in accordance with the manufacturers recommendations.

### J-TRAC ANTI-LIGATURE WINDOW CURTAIN TRACKING



The J-Trac anti-ligature curtain rail is a unique design which has been developed to help meet the challenges faced when creating a caring and safe mental health environment. Being able to furnish a room with curtains allows patients to control the amount of daylight let into the room, which is an important factor to increase the patient's experience of autonomy, independence and normalisation. Curtains also add the option of colour customisation, and assist in improved acoustics within the room.

Unlike ordinary rails, the patented design of the J-Trac does not allow anything to be attached to the rail, and is designed with an open angle to hinder jamming of contraband behind the rail. It is designed to be mounted tightly against the wall or ceiling, preventing it from being broken and used as a weapon or tool for self-harm. The curtain hangs from the rail with specially designed runners which release under an abnormal load and can easily be refitted.

**Specification:** J-Trac ceiling or wall mount curtain track system including rail, end stops and runners spaced in accordance with manufacturers recommendations.

### J-TRAC ANTI-LIGATURE SHOWER CURTAIN TRACKING



The J-Trac anti-ligature shower curtain rail utilises the same unique rail design as the J-Trac Window Curtain Rail, however is shaped with a 90 degree curved bend and can be cut to size prior to installation. Please note, as this product is securely fixed directly to the ceiling in a wet area, the curtain fabric should be breathable to allow airflow. As with the window tracking, the patented design of the J-Trac Shower Curtain Tracking does not allow anything to be attached to the rail, and is designed with an open angle to hinder jamming of contraband behind the rail.

**Specification:** J-Trac ceiling mount, 90 degree shower curtain track system including rail, end stops and runners spaced in accordance with manufacturers recommendations.



### KESTREL MOVATRACK K100 ANTI-LIGATURE SHOWER CURTAIN TRACKING SYSTEM



The Kestrel anti-ligature shower curtain tracking system is made from a rigid, high grade white or silver aluminium track with maintenance free, wheeled roller hooks. It uses magnetic wall-fix brackets [refer page 81] where the tracks meet the wall, and magnetic top-fix brackets [refer page 81] where suspension hangers meet the ceiling. This ensures that, under abnormal load, the suspension hanger separates from the ceiling bracket leaving no remaining ligature points - a highly essential safety feature, as it is surprisingly easy to attach a cord to a fixed vertical rod and use it as a ligature point. 90 degree curtain tracking can also be directly fixed to the ceiling utilising magnetic top-fix brackets [refer page 81], however curtains should include breathing mesh if used in a shower or other wet area.

The shower curtain tracking kits are supplied with all required components and can be trimmed to fit, during installation.

**CODE:**

- 116580 Anti-Ligature Shower Curtain Tracking 1200 x 1200mm, White, Suspended System, 90° Bend
- 115065 Anti-Ligature Shower Curtain Tracking 1200 x 1200mm, Silver, Suspended System, 90° Bend
- 116581 Anti-Ligature Shower Curtain Tracking 1200 x 1200mm, White, Direct Fix System, 90° Bend
- 116189 Anti-Ligature Shower Curtain Tracking 1200 x 1200mm, Silver, Direct Fix System, 90° Bend

### KESTREL MOVATRACK K100 ANTI-LIGATURE CURTAIN DIVIDER TRACKING



The Kestrel cubicle divider tracking system is a rigid, high-grade aluminium track section, with maintenance-free, wheeled roller hooks. Designed to give years of trouble-free service and designed specifically for mental health environments, this curtain divider track system uses magnetic wall-fix brackets [refer page 81] where the tracks meet the wall, and magnetic top-fix brackets [refer page 81] where suspension hangers meet the ceiling. This ensures that, under abnormal load, the suspension hanger separates from the ceiling bracket, leaving no remaining ligature points. This tracking system can also be directly fixed to the ceiling utilising magnetic top-fix brackets [refer page 81], however curtains should include breathing mesh to maintain airflow throughout the patient area.

**Specification:** Kestrel Movatrack K100 magnetic anti-ligature curtain divider track system. Track manufactured from premium quality aluminium with silver anodised / white powder-coated finish, complete with roller runner hooks at 10 per metre and magnetic wall-fix / top-fix brackets, spaced in accordance with manufacturers recommendations.

### HIPAC HIGH DURABILITY MIRROR

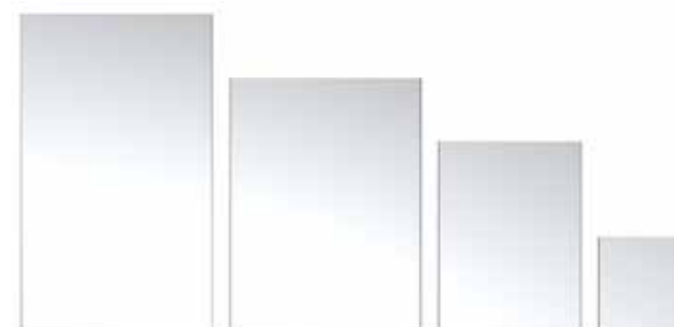

Hipac's range of high durability mirrors are made from a virtually unbreakable polycarbonate material with a specially formulated scratch resistant coating. They are an ideal solution for a mirror, in an environment such as a mental health facility, where glass is not suitable. The mirror is supplied as standard in 6mm thickness, which ensures it has sufficient rigidity to maintain a flat surface and not distort the reflected image. We recommend that these are fixed with adhesive to a flat substrate but can also be supplied with fixing holes for security screw fixings if required. Standard sizes are detailed below, however custom sizes and shapes are available on request.

**CODE:**

- 142749 Hipac High Durability Mirror, 6mm, 300x300mm, Quarter Round Edges, Square Corners
- 120176 Hipac High Durability Mirror, 6mm, 360x495mm, Quarter Round Edges, Square Corners
- 142747 Hipac High Durability Mirror, 6mm, 450x600mm, Quarter Round Edges, Square Corners
- 142748 Hipac High Durability Mirror, 6mm, 450x1000mm, Quarter Round Edges, Square Corners
- 142680 Hipac High Durability Mirror, 6mm, 600x800mm, Quarter Round Edges, Square Corners
- 141344 Hipac High Durability Mirror, 6mm, 600x1000mm, Quarter Round Edges, Square Corners
- 142746 Hipac High Durability Mirror, 6mm, 600x1200mm, Quarter Round Edges, Square Corners

### HEALSAFE ANTI-LIGATURE FRAMED MIRROR



The Healsafe Anti-ligature Framed Mirror is designed just like a regular mirror, with a frame and extra high quality rip-resistant, non-crushable polycarbonate. Unlike mirrors that are glued directly to a wall, the polycarbonate in this mirror can easily be replaced. These mirrors are suitable for use in bathrooms, patient rooms and entry halls for aesthetic purposes and to create a sense of space and light.

The frame is available in several laminate options, such as birch, ash or walnut, to order.

Frame dimensions: 600[H] x 380[W] x21[D]mm

Exposed reflective surface dimensions: 490[H] x 270mm[W]

**CODE:**

- 142858 Healsafe Framed Polycarbonate Mirror 380x600mm - White

**HEALSAFE ANTI-LIGATURE WARDROBE RAIL KIT AND CLOTHES HANGERS**



The Healsafe anti-ligature wardrobe rail and clothes hanger has been designed to prevent anything other than the related hangers from being attached to it. The clothes hangers are constructed from a very robust and elastic material which cannot be broken and are designed to hang on the wardrobe rail and the Healsafe coat hook [refer page 68]. This rail can not be removed and used as a weapon when fastened in place with security fasteners. It is also designed to prevent patients jamming or hiding contraband in or behind it. Wardrobe rail kits are supplied with all required components and can be trimmed to fit, during installation.

**CODE:**

- 142866 J-Trac Wardrobe Rail Kit, 560mm, c/w 4 Standard Coat Hangers
- 142867 J-Trac Wardrobe Rail Kit, 1000mm, c/w 8 Standard Coat Hangers
- 142868 J-Trac Coat Hanger, Cardboard
- 142869 J-Trac Coat Hanger, Standard
- 142870 J-Trac Coat Hanger, Premium

**KESTREL POLYCARBONATE WARDROBE RAIL    CLIK LOAD RELEASE WARDROBE RAIL**

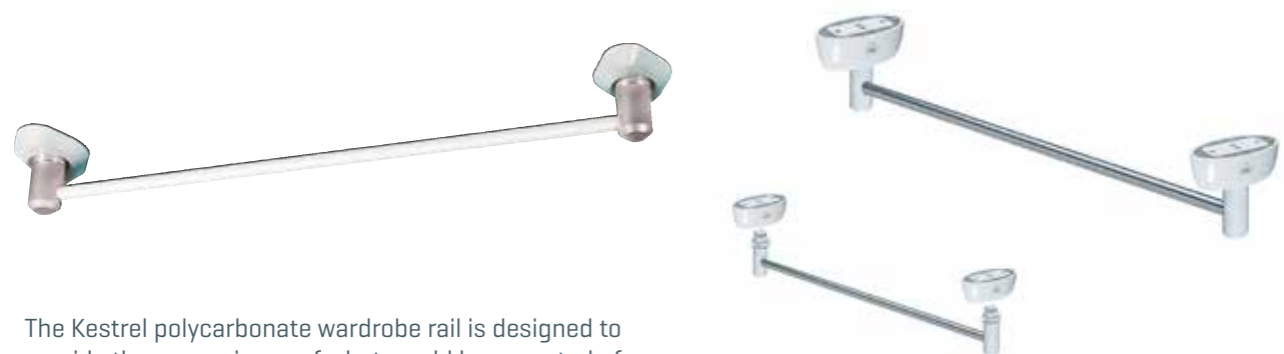

The Kestrel polycarbonate wardrobe rail is designed to provide the convenience of what would be expected of a traditional wardrobe rail however when an abnormal load is applied, such as an attempted ligature, the magnetic brackets will allow the rail to release and drop away, thus preventing a successful ligature. After the event, the rail can simply be reattached to the magnetic brackets. The rail itself is a lightweight clear polycarbonate tube which minimises the risk of it being used as a weapon or as a means of hiding contraband.

**CODE:**

- 113637 Kestrel Polycarbonate Wardrobe Rail, 500mm
- 114229 Kestrel Polycarbonate Wardrobe Rail, 1000mm, with intermediate support
- 114230 Kestrel Polycarbonate Wardrobe Rail, 1500mm, with two intermediate supports

The Cltik load release wardrobe rail is designed to provide the convenience of what would be expected of a traditional wardrobe rail however when an abnormal load is applied, such as an attempted ligature, the brackets are designed to release so that the rail can drop away, thus preventing a successful ligature. After the event the rail can be reinstated simply by pushing the rail holders back into the corresponding brackets. The brackets incorporate heat-treated stainless-steel spring clips that allow the product to release and reattach repeatedly without any decline in performance or safety.

**CODE:**

- 119909 CLIK Load Release Wardrobe Rail, 500mm
- 119911 CLIK Load Release Wardrobe Rail, 1000mm

**CLIK LOAD RELEASE CONVENTIONAL TOWEL RAIL**



The Cltik load release towel rail is designed to provide the convenience of what would be expected of a traditional towel rail however when an abnormal load is applied, such as an attempted ligature, the brackets are designed to release so that the rail can drop away, thus preventing a successful ligature. After the event, the rail can be refitted to the brackets by simply pushing the rail holders back into the corresponding brackets. The brackets incorporate heat-treated stainless-steel spring clips that allow the product to release and reattach repeatedly without any decline in performance or safety.

**CODE:**

- 119904 CLIK Load Release Conventional Towel Rail Set, 500mm

**KESTREL LOAD RELEASE POLYCARBONATE TOWEL RAIL SET    CLIK LOAD RELEASE TOWEL RING HOLDER**



The Kestrel polycarbonate towel rail is designed to provide the convenience of what would be expected of a traditional towel rail however when an abnormal load is applied, such as an attempted ligature, the magnetic brackets will allow the rail to release and drop away, thus preventing a successful ligature. After the event, the rail can simply be reattached to the magnetic brackets. The rail itself is a lightweight clear polycarbonate tube which minimises the risk of it being used as a weapon or as a means of hiding contraband.

**CODE:**

- 113639 Kestrel Load Release Polycarbonate Towel Rail Set, 500mm

Clik towel rings are designed to handle rough treatment without compromising on style and aesthetics. The product is designed to provide the convenience of what would be expected of a traditional towel ring holder however when an abnormal load is applied, such as an attempted ligature, the bracket is designed to release so that the towel ring can drop away, thus preventing a successful ligature. After the event the towel ring can be reinstated simply by pushing the towel ring holder back into the corresponding bracket. The bracket incorporates a heat-treated stainless-steel spring clip that allows the product to release and reattach repeatedly without any decline in performance or safety.

**CODE:**

- 119900 CLIK Load Release Towel Ring Holders

**CLIK LOAD RELEASE COAT HOOK**



The Clik load release coat hook is designed to provide the convenience of what would be expected of a traditional coat hook however when an abnormal load is applied, such as an attempted ligature, the bracket is designed to release so that the hook can drop away, thus preventing a successful ligature. After the event, the hook component can be reattached by pushing it back into the bracket. The bracket incorporates a heat-treated stainless steel spring clip that allows the product to release and reattach repeatedly without any decline in performance or safety.

**CODE:**  
119908 Clik Load Release Coat Hook, Polycarbonate/  
White

**KESTREL COAT HOOK**



The Kestrel coat hook is designed to provide the convenience of what would be expected of a traditional coat hook however when an abnormal load is applied, such as an attempted ligature, the magnetic bracket will allow the hook to release and drop away, removing all ligature points. After the event the hook can simply be reattached to the magnetic bracket. The hook is made from pliable material which makes it ineffective if used as a weapon or for self-harm.

**CODE:**  
114179 Kestrel Coat Hook

**HEALSAFE ANTI-LIGATURE COAT HOOK**



The Healsafe anti-ligature hook is designed to flex and release its load when abnormal weight is applied, but will return to its original shape when the load is released. No sharp edges or loose parts and tested to 1000 overloads.

**CODE:**  
142871 Healsafe Anti-Ligature Hook, White  
142872 Healsafe Anti-Ligature Hook, Black  
142873 Healsafe Anti-Ligature Hook, Red  
142874 Healsafe Anti-Ligature Hook, Grey  
142875 Healsafe Anti-Ligature Hook, Blue

**ANTI-LIGATURE COAT AND TOWEL HOOK**



The Anti-Ligature Coat and Towel Holder contains a flexible yet durable rubber hook component, which is fixed within a stainless steel collar and has a low load release threshold. The hook and shroud are held in place by two security screws that pass through both the stainless steel collar and the rubber. The collar is chamfered and the hook is flexible in all directions making the product suitable for use on a door without risk of a ligature.

**CODE:**  
119387 Anti-Ligature Coat and Towel Holder, Black Rubber

**ANTI-LIGATURE STAINLESS STEEL COAT HOOK**



This stainless-steel coat hook provides an effective hook for coats or towels. It has a pivoting ball joint that allows the hook to drop or swivel when an excessive load is applied - this changes the angle and causes the attempted ligature to drop or slide off. This product is fastened to the wall with stainless steel security fasteners, three of which are supplied with each unit.

**CODE:**  
119773 Anti-Ligature Stainless Steel Coat Hook

**CLIK LOAD RELEASE TOILET ROLL HOLDER**



The Clik load release toilet roll holder is designed to provide the convenience of what would be expected of a traditional toilet roll holder however when an abnormal load is applied, such as an attempted ligature, the bracket is designed to release so that the holder can drop away, thus preventing a successful ligature. After the event, the holder component can be reattached by pushing it back into the bracket. The bracket incorporates a heat-treated stainless steel spring clip that allows the product to release and reattach repeatedly without any decline in performance or safety.

**CODE:**  
119898 Clik Load Release Toilet Roll Holder

**HEALSAFE TOILET ROLL HOLDER**



The Healsafe Toilet Roll Holder consists of a wall bracket and flexible hook unit. The hook is constructed from strong flexible material with smooth edges to prevent it from being used as a weapon or for self-harm, and does not compromise on safety or practicality. The hook will release from the bracket under an abnormal load, but is simply and easily clicked back into place following an incident.

**CODE:**  
142876 Healsafe Toilet Roll Holder

**KESTREL TOILET ROLL HOLDER, WHITE PLASTIC**



The Kestrel Toilet Roll Holder is designed to provide the convenience of what would be expected of a traditional Toilet Roll Holder, however when an abnormal load is applied, such as an attempted ligature, the magnetic bracket will allow the holder to release and drop away, removing all ligature points. After the event the holder can simply be reattached to the magnetic bracket.

**CODE:**  
111629 Kestrel Toilet Roll Holder, White Plastic

**RECESSED TOILET PAPER HOLDER**



The Recessed Toilet Paper Holder is manufactured in stainless steel and is designed to hold one standard roll of toilet paper. This product is fastened to the wall with stainless steel security fasteners, four of which are supplied with each unit.

**CODE:**  
141298 Recessed Toilet Paper Holder, Exposed Mount

**ANTI-LIGATURE STAINLESS STEEL TOILET ROLL HOLDER**



A stainless steel toilet roll holder that provides an effective method of storing a toilet paper roll in close proximity to a toilet. It has a pivoting ball joint that allows the holder to drop or swivel when an excessive load is applied, this changes the angle and causes the attempted ligature to drop or slide off. This product is fastened to the wall with stainless steel security fasteners, three of which are supplied with each unit.

**CODE:**  
119770 Anti-Ligature Stainless Steel Toilet Roll Holder

### CLIK LOAD RELEASE SHELF



119906



119073



119907

The Klik Load Release Shelf has been designed to provide the convenience of what would be expected of a traditional shelf however when an abnormal load is applied, such as an attempted ligature, the brackets are designed to release so that the shelf can drop away, preventing a successful ligature. After the event the shelf can be simply reattached by pushing it back into the corresponding brackets. The brackets incorporate heat-treated stainless steel spring clips that allow the product to release and reattach repeatedly without any decline in performance or safety. The shelf itself is made of 8mm polycarbonate with chamfered edges and rounded corners.

**CODE:**

- 119906 CLIK Load Release Corner Shelf, Clear Polycarbonate/White
- 119073 CLIK Load Release 500mm Straight Shelf, Clear Polycarbonate/White
- 119907 CLIK Load Release Semi Circular Shelf, Clear Polycarbonate/White

### HEALSAFE SHELF SET



The Healsafe Shelf is an anti-ligature shelf-set that incorporates a proprietary mounting bracket that is fastened to the wall with security fasteners and a shelf that falls away from the bracket under an abnormal load. The shelf is simply clicked back into place following an incident. It is constructed from strong durable plastic with smooth corners to withstand abuse and to reduce the risk of patient/staff injury.

**CODE:**

- 142877 Healsafe Shelf Set, White

### HEALSAFE PAPER TOWEL HOLDER



The Healsafe Paper Towel Holder is an anti-ligature product that incorporates a proprietary mounting bracket that is fastened to the wall with security fasteners and a dispenser that falls away from the bracket under an abnormal load. The dispenser is simply clicked back into place following an incident.

**CODE:**

- 142878 Healsafe Paper Towel Holder - PP Plastic
- 142879 Healsafe Paper Towel Holder, with lid - PP Plastic

### HEALSAFE ANTI-LIGATURE WASTE BIN



The Healsafe Waste Bin is an anti-ligature product that incorporates a proprietary mounting bracket that is fastened to the wall with security fasteners and a bin that falls away from the bracket under an abnormal load. The bin component is simply clicked back into place following an incident.

**CODE:**

- 142880 Healsafe Wall Mounted Waste Bin - PP Plastic

### STAINLESS STEEL SHELF



A durable shelf constructed entirely of 304 grade stainless steel. Easy to clean, robust and designed to limit the potential for ligature risks, it is fixed to the wall with stainless steel security fasteners, which are supplied with the unit.

**CODE:**

- 141300 Stainless Steel Shelf, 457mm

### KESTREL CLEAR POLYCARBONATE SHELF SET



The Kestrel Clear Polycarbonate Shelf Set is designed to provide the convenience of what is expected of a traditional shelf however when an abnormal load is applied, such as an attempted ligature, the magnetic wall mounted bracket will allow the shelf to release and drop away. After the event, the shelf can simply be reattached to the magnetic bracket. The shelf is manufactured from polycarbonate with chamfered edges and rounded corners to prevent self harm.

**CODE:**

111635 Kestrel Clear Polycarbonate Shelf Set  
300mm[W] x 140mm[D].

### KESTREL SOAP DISH, WHITE PLASTIC



The Kestrel Soap Dish is designed to provide the convenience of what is expected of a traditional soap dish however when an abnormal load is applied, such as an attempted ligature, the magnetic wall mounted bracket will allow the shelf to release and drop away. After the event the hook can simply be reattached to the magnetic bracket.

**CODE:**

111633 Kestrel Soap Dish - White Plastic

### CLIK LOAD RELEASE SOAP DISH



The Klik Load Release Soap Dish is designed to provide the convenience of what would be expected of a traditional soap dish, however when an abnormal load is applied, such as an attempted ligature, the bracket is designed to release so the shelf can drop away, preventing a successful ligature. After the event the shelf can be reinstated by simply pushing it back into the corresponding brackets. The bracket incorporates a heat-treated stainless steel spring clip that allows the product to release and reattach repeatedly without any decline in performance or safety.

**CODE:**

119903 CLIK Load Release Soap Dish

### RECESSED SOAP DISH, CONCEALED REAR MOUNT WITHOUT LIP



A stainless steel soap dish without lip, containing a concealed rear mount.

**CODE:**

120164 Recessed Soap Dish - Concealed, Rear Mount without lip  
141299 Heavy Duty Recessed Soap Dish without Lip - Concealed, Rear Mount

### KESTREL LOAD RELEASE MOUNTING PLATE

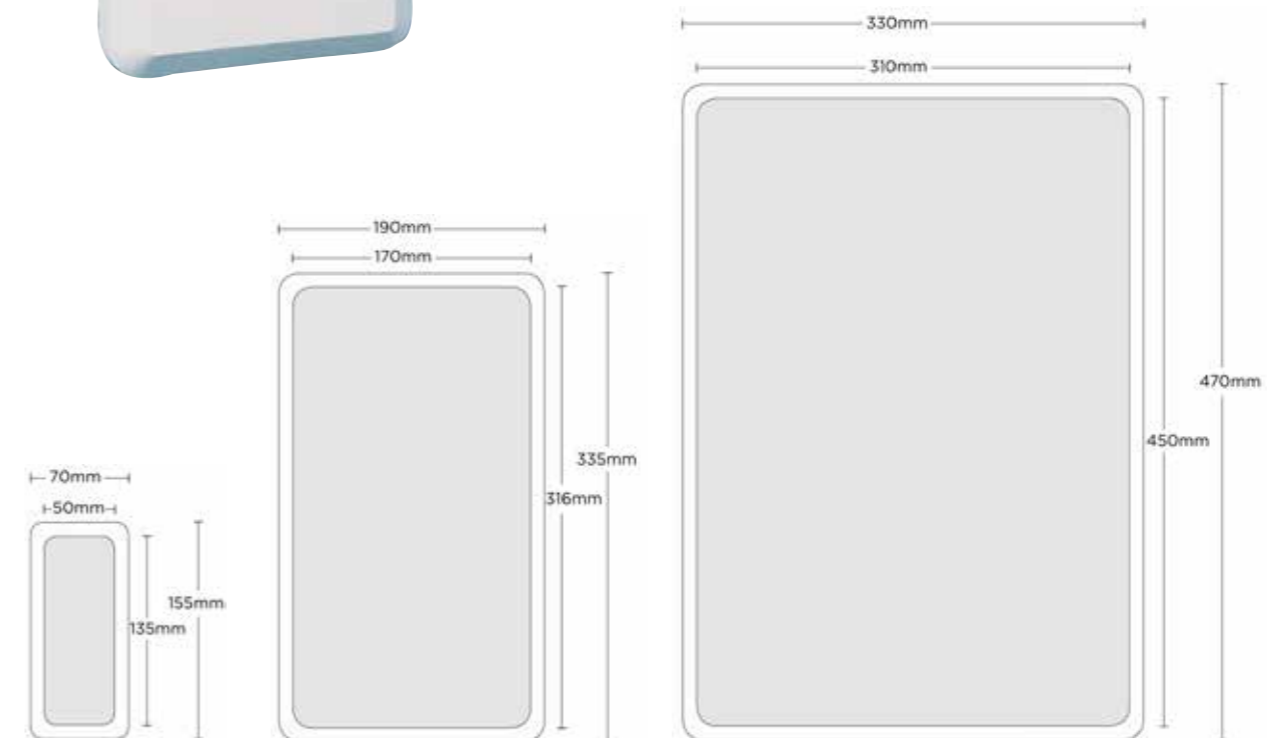

Many items may be converted to anti-ligature status by mounting them on a Kestrel Load Release Mounting Plate. Available in three sizes, the plates are held vertically against the wall by the magnetic attraction of the Kestrel brackets hidden behind them. The sleek design of these mounting plates means that they almost seamlessly blend into any given environment. These plates are ideal for mounting products such as soap dispensers, paper towel dispensers and toilet roll holders, however consideration should be given to the product that is to be mounted to ensure it is free from elements that could cause staff or patient injury.

**CODE:**

111735 Kestrel Load Release Mounting Plate, 70 x 155mm, Fixing Face 50 x 135mm  
111734 Kestrel Load Release Mounting Plate 190 x 335mm, Fixing Face 170 x 316mm  
111616 Kestrel Load Release Mounting Plate 330 x 470mm, Fixing Face 310 x 450mm

### EZY-GRIP SHOWER SET

The WaterMark approved Safe-Cell® Ezy-Grip Shower Set incorporates a smooth chrome finish with handles that feature an anti-ligature design to minimise the risk of self-harm.

#### Features

- Complies with AS/NZS 3718
- Anti-ligature design
- Anti-rotation pin
- Chrome plate finish
- Concealed 7LPM constant flow regulator
- Easy grip handle
- Front or rear fixing
- Machined identification button
- Designed to reduce the ability of patients to conceal contraband
- Vandal resistant design



#### CODE:

141365 50151C - Safe-Cell CP-BS Prison Ezy-Grip Shower Set Complete w/ Vandal Resistant Shower

### DIVERTER ASSEMBLY WITH ASSISTED PADDLE



The shower diverter assembly has been designed to suit behavioral health showering facilities to enable carers or patients to divert the water flow from one shower outlet to another. For example, divert water flow from a fixed shower head to a removable hand held shower assembly, providing greater flexibility for both patients and carers.

#### Features

- Anti-ligature and vandal resistant design
- Unique design concept eliminates institutional appearance
- Easy operation allows the diverter to be activated with your palm or fingers
- Chrome plate for easy cleaning and added durability
- Anti-rotation pin

#### CODE:

119992 Clinisafe Mental Health diverter assembly with assisted paddle

### SAFE-CELL (CRR) PRISON FLOOR DRAIN ASSEMBLY



The Safe-Cell® Crocodile Roll Resistant (CRR) floor drain has been designed to minimise the risk of self-harm and suicide using a technique called the "Crocodile Roll" and is designed to help provide protection against the concealing of contraband.

#### Features

- Complies with AS 3996 to Class B and EN1253 R50
- Anti-ligature design
- Designed to reduce the ability of patients to conceal contraband
- Unique dial ring designed to maximise drainage of water supply
- Specially designed for vinyl flooring with a lock-down flange to mechanically clamp down the vinyl to increase the longevity of the flooring provided, and reduce any trip hazard in the bathroom environment

#### CODE:

142457 Polished Stainless Steel Safe-Cell (CRR) Prison Floor Drain Ass Vinyl 100x80BSP

### VANDAL RESISTANT ANTI-LIGATURE SHOWER ROSE

The Safe-Cell® chrome plated brass shower rose is a WaterMark and WELS 4\* approved product with a bolting plate, providing both anti-vandalism and anti-ligature features.

#### Features:

- Complies with AS/NZS 3662
- High grade commercial quality
- 7LPM Constant Flow Restrictor
- Chrome plate finish for easy cleaning and added durability, vandal resistant
- Complies to DPW - NSW Specification
- Front or rear fixing
- Designed to reduce the ability of patients to conceal contraband
- Designed to minimise risk of self-harm



#### CODE:

133060 40691 - Vandal Resistant Anti-Ligature Shower Rose

### SAFE-CELL WALL OUTLET



The Safe-Cell® Wall Outlet is designed to minimise the risk of self-harm by providing a smooth, angled conical shape body, anti-tamper screws and anti rotation locating pin. The outlet is supplied with a flow regulating aerator that incorporates a swivel to provide flow direction adjustment when required.

#### Features

- Anti-ligature design
- Vandal resistant design
- Designed to reduce the ability of patients to conceal contraband
- 20 degree flow direction adjustment
- Anti-rotation pin
- Chrome plate finish

#### CODE:

138172 40684 - Safe-Cell Wall Outlet

### EZY-GRIP WALL TOP ASSEMBLY TAP



138170

138171

The WaterMark approved Safe-Cell® Wall Top Assembly Tap incorporates a smooth chrome finish and an anti-ligature handle design to minimise the risk of self harm.

#### Features

- Complies with AS/NZS 3718
- Anti-ligature design
- Anti-rotation pin
- Chrome plate finish
- Easy grip handle
- Machined identification button
- Vandal resistant design

#### CODE:

138170 50117C - CP Safe-Cell Ezy-Grip Wall Top Assem Complete 'Cold' Ceramic

138171 50133C - CP Safe-Cell Ezy-Grip Wall Top Assem Complete 'Hot' Ceramic

### ANTI-LIGATURE WALL CONNECTOR AND QUICK DISCONNECT ADAPTER WITH HAND HELD SHOWER



Designed for assisted shower applications in behavioral health facilities, this unique shower connector allows carers the option of bathing the patient with a hand held shower. Once finished, the carer can simply disconnect the adaptor and hand held shower leaving a safe bathroom environment once again.

#### Features

- Anti-Ligature designed hand held shower adaptor, allows easy removal of the hand shower after use
- Durable chrome finish for easy cleaning and a non institutional appearance
- Utilises a quick connect fitting for a safe and reliable shut off and ease of attachment and release
- Able to be adapted to existing hose and hand held showers

#### CODE:

- 119991 Clinisafe Mental Health Anti-ligature wall connector and quick disconnect adapter with hand held shower  
142044 42016 - GalvinCare Mental Health Detachable Hand Shower for Safe-Connect Shower Head

### SAFE-CONNECT SHOWER HEAD



The GalvinCare® Mental Health Anti-Ligature Safe-Connect Shower Head incorporates an additional hand held shower connection where carers can easily connect a hand-held shower, if assisted showering is required. The hand held shower then can easily be removed when not in use.

#### Features

- Anti-vandalism design
- Anti-ligature
- Enables assisted and unassisted showering
- Promotes a normalised environment
- Chrome plate finish for easy cleaning and added durability
- Australian patent no. AU 2017100421. International patents pending

#### CODE:

- 142042 42020 - GalvinCare CP-BS Mental Health Anti-Ligature Safe-Connect Shower Head w/ Hand Shower  
142043 42013 - GalvinCare CP-BS Mental Health Anti-Ligature Safe-Connect Shower Head

### WALLGATE ANTI-LIGATURE, ANTI-VANDAL SOLID SURFACE BASIN

The Wallgate Anti-Ligature, Anti-Vandal Solid Surface Basin is a robust solid surface product designed for use in mental health facilities. It features a single outlet and the ability to incorporate infra-red tap activation.

#### Features

- Anti-ligature design
- Electronic or pneumatic activation
- Highly robust
- Made as one piece without joins
- Highly polished finish for ease of cleaning
- Easily renewable surface without a gel coat layer
- Assists with environment normalisation
- Range of control options available
- Features concealed through-wall services and fixings
- Retains appearance over long life span
- Hygienic and easily cleaned
- Proven 25 years+ product life



#### CODE:

- 142859 Wallgate Anti-Ligature, Anti-Vandal S/Surface Basin w/ Single Outlet N/T/H White

### ANTI-LIGATURE, ANTI-VANDAL SOLID SURFACE BACK TO WALL TOILET PAN - INTEGRATED SEAT

The anti-ligature, anti-vandal solid surface back to wall WC pan is a highly robust product with a shrouded waste and integral, anti-ligature, solid surface seat. It is designed specifically to withstand the rigours of behavioral health and secure facilities.

#### Features

- Concealed through-wall services and fixings
- Highly robust
- Contrasting seat colour available
- WC pan made as one piece without joins
- Highly polished finish for ease of cleaning
- Easily renewable surface without a gel coat layer
- Assists with environment normalisation
- Range of activation and control options available
- Matching urinal basin and hand wash dryer available
- Anti-ligature design to reduce potential for self-harm
- Retains appearance over long life span
- Shrouded waste enables use of S or P trap waste



#### CODE:

- 142459 Anti-Ligature, Anti-Vandal Solid Surface Back To Toilet Wall Pan S&P with Grey Integrated Seat 446x702 - Wh

### CONTOUR ANTI-LIGATURE GRAB RAIL

The Contour Anti-Ligature Grab Rail is designed in such a way to be free of ligature points whether installed horizontally or vertically. It features a sloping cap on one end to ensure nothing can be looped completely around the rail without slipping it off. It also features an open end that allows for easy drainage which overcomes hygiene and infection control risks associated with traditional infilled rails.

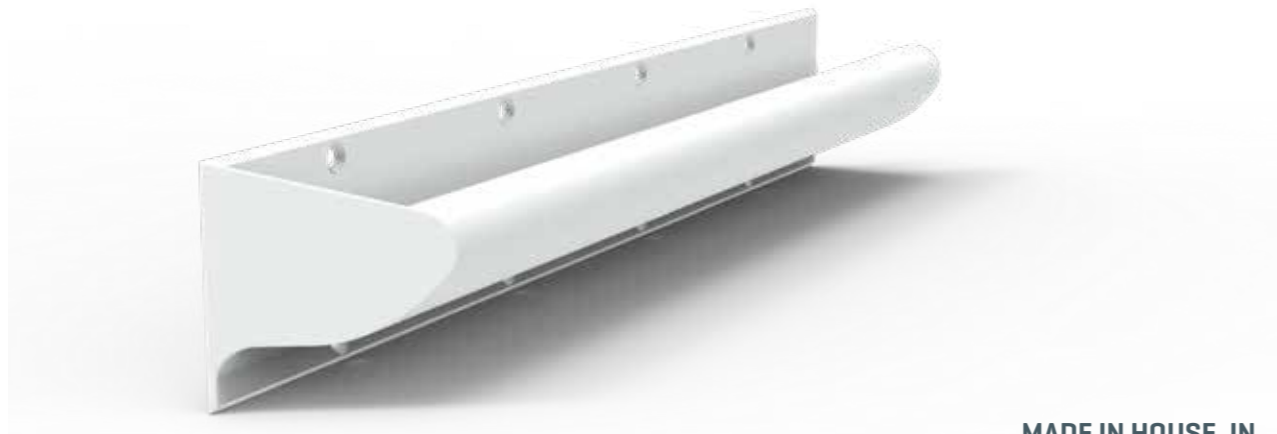

MADE IN HOUSE, IN AUSTRALIA, BY  
 Hipac

#### CODE:

- 116597 90 Degree, 700mm x 900mm, Left Handed
- 116598 90 Degree, 700mm x 900mm, Right Handed
- 116975 30 Degree, 700mm x 900mm, Left Handed
- 116976 30 Degree, 700mm x 900mm, Right Handed
- 116593 Straight, 700mm, Left Handed
- 116594 Straight, 700mm, Right Handed
- 116595 Straight, 900mm, Left Handed
- 116596 Straight, 900mm, Right Handed
- 120047 90 Degree, 450mm x 450mm, Left Handed
- 120048 90 Degree, 450mm x 450mm, Right Handed
- 117587 Straight, 300mm, Left Handed
- 117596 Straight, 300mm, Right Handed

#### Common Colour Options:

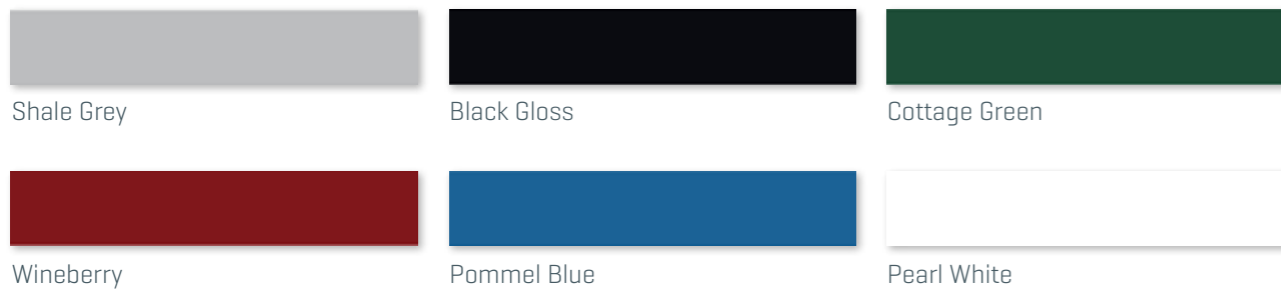

Colours shown are as accurate as printing processes allow. Consult a Dulux Powder Coatings Colour Selector or call Customer Care on 1800 759 393 to obtain an accurate colour swatch. Other powder coat colours are available - call Customer Care on 1800 759 393 for more information.



116597  
700mm x 900mm - Left Handed

116598  
700mm x 900mm - Right Handed

116975  
700mm x 900mm - Left Handed



116976  
700mm x 900mm - Right Handed

116593  
700mm - Left Handed

116594  
700mm - Right Handed



116595  
900mm - Left Handed

116596  
900mm - Right Handed

120047  
450mm x 450mm - Left Handed

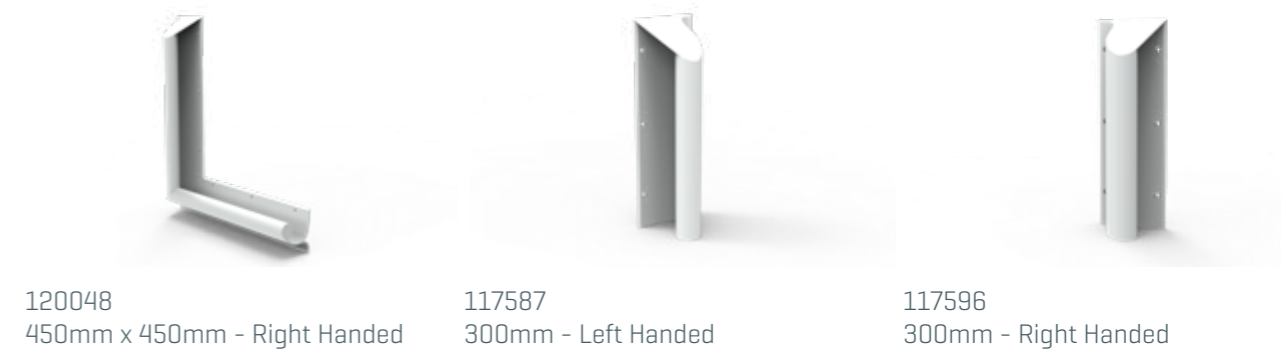

120048  
450mm x 450mm - Right Handed

117587  
300mm - Left Handed

117596  
300mm - Right Handed



## ANTI-LIGATURE ESCUTCHEONS

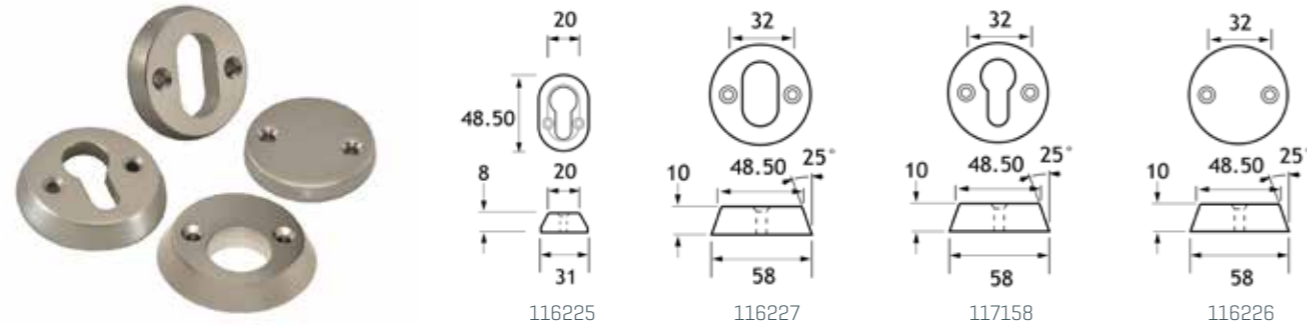

Hipac's lockset escutcheon products are designed with a chamfered edge to limit the potential to attach a ligature to a keyway. Available in Euro and Oval profiles to accommodate most cylinder types.

**CODE:**

- 116225 Escutcheon 22mm Face Fix Narrow Euro Profile
- 116227 Escutcheon 58mm Oval Profile
- 117158 Escutcheon 58mm Swiss Profile
- 116226 Escutcheon 58mm Blind Profile



## REBATE KIT



Rebate kits to complement installation of our range of locksets for doors with rebated lips. Available to suit both night latch and roller bolt deadlock configurations. Supplied as standard to suit a 13mm rebate.

Custom size rebate options available on request. Contact Customer Care with specific requirements.

**CODE:**

- 114227 Rebate Set for Roller Bolt Deadlock 13mm SSS
- 114228 Rebate Set for Nightlatch 13mm SSS

## BUTT HINGES



These butt hinges have chamfered tips at the top and bottom as an effective way to minimise the ligature risk associated with standard butt hinges. Suitable for doors that remain closed and locked when accessible by patients or under supervision when open.

**CODE:**

- 141373 100 x 100mm Butt Hinge - Chamfered Tips - 3mm 304 Stainless Steel
- 141374 100 x 75mm Butt Hinge - Chamfered Tips - 3mm 304 Stainless Steel
- 142776 100 x 75mm Butt Hinge - Chamfered Tips - 2.5mm 304 Stainless Steel
- 142777 100 x 100mm Butt Hinge - Chamfered Tips - 2.5mm 304 Stainless Steel

## ELECTRIC STRIKE



Specifically modified and designed to work with night-latch PR-6103/6104 function 66 & 86 locksets and intended for use in hard wired access control systems. This rugged and durable electric strike can be configured to either 12vDC or 24vDC. Similarly, with nothing other than a simple screwdriver this electric strike can be adapted to operate in either a fail-safe [open] or fail-secure [locked] mode for full onsite flexibility.

**CODE:**

- 114086 Electric release 12/24v DC with Bespoke Faceplate, to suit 44mm door

## FLUSH PULL HANDLE

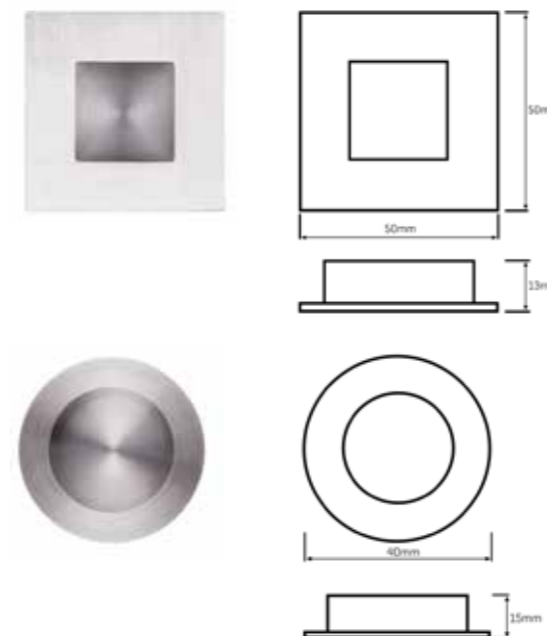

Recessed Flush Pull Handle in satin stainless steel finish. Fixed in place by concealed screws.

**CODE:**

- 142454 Flush Pull Square 50mm - SSS
- 142453 Flush Pull Round 40mm - SSS

## KESTREL BRACKETS



Top fix: 82[L] x 57[W] x 12mm[H]  
Wall fix: 48[L] x 37[W] x 60mm[H]

**CODE:**

- 111640 Top Fix Bracket
- 111638 Wall Fix Bracket
- 114602 KD4 Disc

## RECTANGLE PULL HANDLE, FLUSH

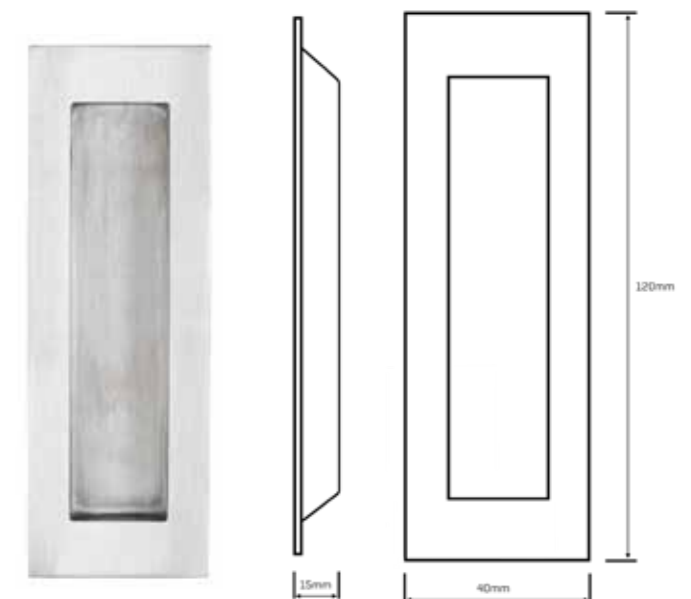

Recessed Flush Pull Handle in satin stainless steel finish. Fixed in place by concealed screws.

**CODE:**

- 142455 Flush Pull Rectangular 120x40mm

## LIFELINE BUTTERFLY KEY

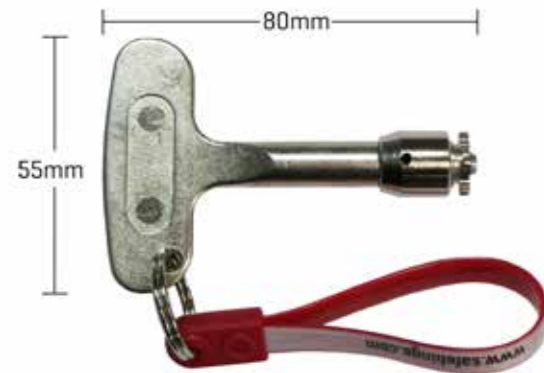

**CODE:**

- 120337 Lifeline Butterfly Key - Zero Position
- 137322 Lifeline Butterfly Key - Zero Position, Small Version

## VISION PANEL AND REMOVABLE DOOR STOP KEY



138254



117166

**CODE:**

- 138254 Vision Panel Standard Key - 8mm Square
- 117166 Removable Door Stop Key - 4mm Square

## SECURITY FASTENERS AND DRIVER BITS



**CODE:**

- 138812 8G Hinge Security Screw Pack: 24x Metal Screws, 24x Timber Screws and 1x Driver
- 142947 8G Hinge Security Screw Pack: 28x Metal Screws, 28x Timber Screws and 1x Driver
- 138811 10G Hinge Security Screw Pack: 14x Metal Screws, 14x Timber Screws and 1x Driver
- 120193 Screws to suit Contour Grabrail - 12G x 2 Pin Hex Csk Self Tap. 304 [H40]
- 116180 H40 - Pin Hex Insert Bit, 1/4 HEX x 70mm
- 117145 Resytork Insert Bit T-15 1/4 HEX x 25mm
- 115325 Resytork Insert Bit T-20 1/4 HEX x 25mm
- 117180 Resytork insert Bit T-20 1/4 HEX x 75mm
- 139056 Resytork insert Bit T-20 1/4 HEX x 100mm
- 117146 Resytork Insert Bit T-25 1/4 HEX x 25mm
- 117147 Resytork Insert Bit T-27 1/4 HEX x 25mm
- 120876 Resytork Insert Bit T-30 1/4 HEX x 25mm

## EMERGENCY SLIDE OVER PULL HANDLE

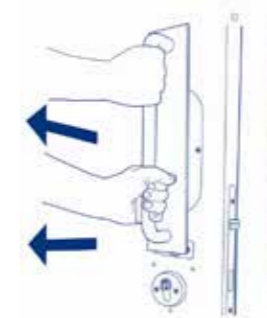

Anti-barricade doors are purposely designed to enable clinical staff to open the door in an outward direction in a barricade scenario. However, if the patient holds the handle on the inside of the door to prevent clinical staff access, the Emergency Pull Handle can be used to provide additional grip to help overcome the contrary, patient generated, internal force.

Simply slide the Emergency Pull Handle over the pinch grip handle and pull to open the door in an outward direction. The length of the Emergency Pull Handle is deliberately designed to enable more than one member of the clinical team to participate in pulling the door ensuring a swift entry to the barricaded room. Suitable for use with 729 handles only [refer page 24].

**CODE:**

- 113695 Emergency Slide Over Pull Handle

## EMERGENCY OVERRIDE TOOL KIT



The Emergency Override Tool Kit contains all the items required to operate the 5-Way Staff Override System on PR-3S and Passport locksets [refer page 10-11]. The kit includes a screwdriver for the removal of the anti-tamper screw and a multi-tool which is used to unlock the door, which also acts as an aid to the clinical staff, providing more than adequate pulling force and leverage from the outside of the door to ensure the door can be opened in an outward direction. The kit also includes the Lifeline Butterfly key suitable for use for any products keyed to this system e.g. Movastop, Locksets, Vision Panels, etc.

This is an essential accessory for facilities with PR-3S or Passport Locksets and should be available to the fitter during installation. Typically one kit per ward is sufficient. Clinical staff must be fully aware of its location and trained in the use of this essential equipment. Clear signage advising of storage location is also recommended.

**CODE:**

- 133048 Unified Emergency Override Kit c/w Kit Holder & LL Key

# Index

## By Product Name

Product Name	Page	Product Name	Page	Product Name	Page	Product Name	Page
16 Service Riser Deadbolt Lockset	58	Coat Hook, Kestrel	68	Fasteners and Driver Bits, Security	82	J-Trac Anti-Ligature Shower Curtain Tracking	63
46 Bedroom Lockset	16	Communal Lockset	56	Finger Protective Double Swing Hinge	28, 50	J-Trac Anti-Ligature Window Curtain Tracking	63
56 Indicator Lockset	42	Concealed Door Closer	32	Flexible Curtain Tracking, Kestrel Vitesse K9500 Anti-Ligature	62	Kestrel Anti-Ligature Slow-Rise Spring Roller Blind	62
66 Latch-Lock [Key/Turn] Lockset	18	Contour Anti-Ligature Grab Rail	78	Floor Mounted Double Action Door Closer	32	Kestrel Brackets	81
76 En-Suite Lockset	44	Curtain Divider Tracking, Kestrel Movatrack K100 Anti-Ligature	64	Flush Pull Handle	81	Kestrel Clear Polycarbonate Shelf Set	72
86 Latch-Lock [Key/Key] Lockset	54	Curtain Tracking, Flexible, Kestrel Vitesse K9500 Anti-Ligature	62	Grab [Recessed or Flat Plate] Anti-Ligature Door Handles	25, 47	Kestrel Coat Hook	68
96 Communal Lockset	56	Deadbolt Lockset, 16 Service Riser	58	Grab Rail, Contour Anti-Ligature	78	Kestrel Load Release Mounting Plate	73
AMADEO, Passport Proximity Lockset	22	Detachable Door Stop, Movastop	27, 49	Handle, Elephants Trunk Pull	25, 47	Kestrel Load Release Polycarbonate Towel Rail Set	67
Anti-Ligature Coat and Towel Hook	68	Diverter Assembly with Assisted Paddle	74	Handle, Flush Pull	81	Kestrel Movatrack K100 Anti-Ligature Curtain Divider Tracking	64
Anti-Ligature En-suite Door Set	40	Dome Wall Stop	29, 51	Handle, Pinch Grip Pull	24, 46	Kestrel Movatrack K100 Anti-Ligature Shower Curtain Tracking System	64
Anti-Ligature Escutcheons	80	Door Closer, Concealed	32	Handle, Recessed Pull	24, 46	Kestrel Polycarbonate Wardrobe Rail	66
Anti-Ligature SafeDoor	41	Door Closer, Floor Mounted Double Action	32	Handle, Rectangle Pull, Flush	81	Kestrel Soap Dish, White Plastic	72
Anti-Ligature Stainless Steel Coat Hook	68	Door Set, En-Suite, Anti-Ligature	40	Handle, Sure Grip Pull	24, 46	Kestrel Toilet Roll Holder, White Plastic	69
Anti-Ligature Stainless Steel Toilet Roll Holder	69	Door Stop, Dome Wall Stop		Handles, Grab [Recessed or Flat Plate] Anti-Ligature	25, 47	Kestrel Vitesse K6200 Anti-Ligature Window Curtain Tracking	62
Anti-Ligature Wall Connector and Quick Disconnect Adapter with Hand Held Shower	76	Door Stop, Heavy Duty, Moulded	29, 51	Healsafe Anti-Ligature Coat Hook	68	Kestrel Vitesse K9500 Anti-Ligature Flexible Curtain Tracking	62
Anti-Ligature, Anti-Vandal Solid Surface Back to Wall Toilet Pan - Integrated Seat	77	Door Stop, Movastop Detachable	27, 49	Healsafe Anti-Ligature Framed Mirror	65	Key, Lifeline Butterfly	82
Basin, Wallgate Anti-Ligature, Anti-Vandal Solid Surface	77	Door Stop, Removable, Aluminium	27, 49	Healsafe Anti-Ligature Wardrobe Rail Kit and Clothes Hangers	66	Key, Removable Door Stop and Vision Panel	82
Bedroom Lockset	16	Door Top Alarm	30, 52	Healsafe Anti-Ligature Waste Bin	71	Latch-Lock [Key/Key] Lockset	54
Bin, Healsafe Anti-Ligature	71	Double Swing Full Length Geared Hinge	26, 48	Healsafe Paper Towel Holder	71	Latch-Lock [Key/Turn] Lockset	18
Bolt, Rhino Junior	33	Double Swing Shrouded Hinge	26, 48	Healsafe Shelf Set	71	Lifeline Butterfly Key	82
Butt Hinges	80	Drain Assembly, Safe-Cell [CRR] Prison Floor	74	Healsafe Toilet Roll Holder	69	Ligature Alarm, Door Top	30, 52
CLIK Load Release Coat Hook	68	Driver Bits and Fasteners, Security	82	Hinge, Double Swing Full Length Geared	26, 48	Lockset, 46 Bedroom	16
CLIK Load Release Conventional Towel Rail	67	Electric Strike	81	Hinge, Double Swing Shrouded	26, 48	Lockset, 56 Indicator	42
CLIK Load Release Shelf	70	Electrically Modified Hinge Section	29, 51	Hinge, Finger Protective Double Swing	28, 50	Lockset, 66 Latch-Lock [Key/Turn]	18
CLIK Load Release Soap Dish	72	Elephants Trunk Pull Handle	25, 47	Hinge, Single Swing Full Length Anti-Ligature Geared, SECURA	28, 50	Lockset, 76 En-Suite	44
CLIK Load Release Toilet Roll Holder	69	Emergency Override Tool Kit	83	Hinges, Butt	80	Lockset, 86 Latch-Lock [Key/Key]	54
CLIK Load Release Towel Ring Holder	67	Emergency Slide Over Pull Handle	83	Hipac High Durability Mirror	65	Lockset, 96 Communal	56
CLIK Load Release Wardrobe Rail	66	En-suite Door Set, Anti-Ligature	40	Hook, Coat and Towel, Anti-Ligature	68	Mirror, Healsafe, Anti-Ligature Framed	65
Coat and Towel Hook, Anti-Ligature	68	En-suite Door Set, SafeDoor, Anti-Ligature	41	Indicator Lockset	42	Mirror, Hipac High Durability	65
Coat Hook, Anti-Ligature Stainless Steel	68	En-Suite Lockset	44	INTAGlaze Vision Panel	34		
Coat Hook, CLIK Load Release	68	Escutcheons, Anti-Ligature	80	IVision Vision Panel	35		
Coat Hook, Healsafe Anti-Ligature	68	Ezy-Grip Shower Tap Set	74				
		Ezy-Grip Wall Top Assembly Tap	75				

<b>Product Name</b>	<b>Page</b>	<b>Product Name</b>	<b>Page</b>	<b>Product Name</b>	<b>Page</b>
Mortice Bolt, Rhino, with Reinforcement Kit	33	Shelf Set, Kestrel Clear Polycarbonate	72	Towel Rail Set, Kestrel Load Release	67
Moulded Heavy Duty Door Stop	29, 51	Shelf, CLIK Load Release	70	Towel Rail, CLIK Load Release	67
Mounting Plate, Kestrel Load Release	73	Shelf, Stainless Steel	71	Towel Ring Holder, CLIK Load Release	67
MovaStop Detachable Door Stop	27, 49	Shower Curtain Tracking System, Kestrel Movatrack K100 Anti-Ligature	64	Vandal Resistant Anti-Ligature Shower Rose	75
Outlet, Safe-Cell Wall	75	Shower Curtain Tracking, J-Trac Anti-Ligature	63	Vision Panel and Removable Door Stop Key	82
Override Tool Kit, Emergency	83	Shower Head, Safe-Connect	76	Vision Panel, INTAGlaze	34
Paper Towel Holder, Healsafe	71	Shower Rose, Vandal Resistant Anti-Ligature	75	Vision Panel, Ivision	35
Passport Proximity Lockset AMADEO	22	Shower Tap Set, Ezy-Grip	74	Vision Panels, SECURA Privacy	36
Passport Proximity Lockset SOLO	20	Shower, Hand Held, Anti-Ligature Wall Connector and Quick Disconnect Adapter	76	Wall Stop, Dome	29, 51
Perko, Concealed Door Closer	32	Single Swing Full Length Anti-Ligature Geared SECURAHinge	28, 50	Wallgate Anti-Ligature, Anti-Vandal Solid Surface Basin	77
Pinch Grip Pull Handles	24, 46	Slow-Rise Spring Roller Blind, Kestrel Anti-Ligature	62	Wardrobe Rail Kit and Clothes Hangers, Healsafe Anti-Ligature	66
Power Transfer Hinge, Electrically Modified Section	29, 51	Soap Dish, CLIK Load Release	72	Wardrobe Rail, CLIK Load Release	66
Pull Handle, Emergency Slide Over	83	Soap Dish, Kestrel	72	Wardrobe Rail, Kestrel Polycarbonate	66
Rebate Kit	80	Soap Dish, Recessed, Concealed Rear Mount without Lip	72	Waste Bin, Healsafe Anti-Ligature	71
Recessed Pull Handle	24, 46	SOLO, Passport Proximity Lockset	20	Window Curtain Tracking, J-Trac Anti-Ligature	63
Recessed Soap Dish, Concealed Rear Mount without Lip	72	Stainless Steel Shelf	71	Window Curtain Tracking, Kestrel Vitesse K6200 Anti-Ligature	62
Recessed Toilet Paper Holder	69	Stainless Steel Surround for INTAGlaze and Ivision Panels	37	Window Push/Pull Handle with Camlock Locking	59
Rectangle Pull Handle, Flush	81	Strike, Electric	81	Window Push/Pull Handle with Lifeline Key	59
Removable Door Stop and Vision Panel Key	82	Sure Grip Pull Handle	24, 46	Window Push/Pull Handle with Roller Latching Deadlock	58
Removable Door Stop, Aluminium	27, 49	Surround for INTAGlaze and Ivision Panels, Stainless Steel	37		
Rhino Junior Bolt	33	Tap, Ezy-Grip Wall Top Assembly	75		
Rhino Mortice Bolt with Reinforcement Kit	33	Toilet Paper Holder, Recessed	69		
Roller Blind, Kestrel Anti-Ligature Slow-Rise	62	Toilet Roll Holder, Anti-Ligature Stainless Steel	69		
Safe-Cell [CRR] Prison Floor Drain Assembly	74	Toilet Roll Holder, CLIK Load Release	69		
Safe-Cell Wall Outlet	75	Toilet Roll Holder, Healsafe	69		
Safe-Connect Shower Head	76	Toilet Roll Holder, Kestrel	69		
SafeDoor, Anti-Ligature	41	Toilet, Anti-Ligature, Anti-Vandal Solid Surface Back to Wall Pan - Integrated Seat	77		
SECURA Privacy Vision Panels	36				
SECURAHinge, Single Swing, Full Length Anti-Ligature Geared	28, 50				
Security Fasteners and Driver Bits	82				
Shelf Set, Healsafe	71				

# Index

## By Product Code

### Product Code Page

111616	73
111629	69
111633	72
111635	72
111638	81
111640	81
111734	73
111735	73
111916	28, 50
112197	24, 46
113637	66
113638	28, 50
113639	67
113695	83
114086	81
114179	68
114180	24, 46
114227	80
114228	80
114229	66
114230	66
114602	81
114616	26, 48
115065	64
115325	82
116118	25, 47
116180	82
116189	64
116225	80
116226	80
116227	80
116228	24, 46
116233	24, 46
116240	25, 47
116241	25, 47

### Product Code Page

116479	28, 50
116578	32
116580	64
116581	64
116593	78
116594	78
116595	78
116596	78
116597	78
116598	78
116975	78
116976	78
116994	27, 49
116995	27, 49
117072	24, 46
117090	28, 50
117091	28, 50
117092	28, 50
117145	82
117146	82
117147	82
117155	25, 47
117158	80
117159	28, 50
117162	32
117166	82
117180	82
117587	78
117596	78
117630	29, 51
117767	29, 51
117768	29, 51
119073	70
119120	27, 49
119122	27, 49

### Product Code Page

119150	33
119151	29, 51
119152	32
119211	26, 48
119387	68
119400	29, 51
119770	69
119773	68
119898	69
119900	67
119903	72
119904	67
119906	70
119907	70
119908	68
119909	66
119911	66
119991	76
119992	74
120047	78
120048	78
120120	30, 52
120164	72
120176	65
120193	82
120337	82
120433	29, 51
120876	82
133048	83
133060	75
136354	33
136399	30, 52
136766	29, 51
136767	29, 51
137322	82

### Product Code Page

137325	32
137552	59
138150	40
138170	75
138171	75
138172	75
138254	82
138623	28, 50
138642	27, 49
138643	27, 49
138811	82
138812	82
138884	41
139056	82
141288	40
141298	69
141299	72
141300	71
141312	25, 47
141334	58
141344	65
141365	74
141373	80
141374	80
142042	76
142043	76
142044	76
142453	81
142454	81
142455	81
142457	74
142459	77
142668	32
142680	65
142746	65

### Product Code Page

142747	65
142748	65
142749	65
142776	80
142777	80
142837	26, 48
142838	26, 48
142841	29, 51
142842	29, 51
142843	29, 51
142858	65
142859	77
142866	66
142867	66
142868	66
142869	66
142870	66
142871	68
142872	68
142873	68
142874	68
142875	68
142876	69
142877	71
142878	71
142879	71
142880	71
142882	59
142947	82
142949	24, 46

## Get in Touch

Looking for a solution to a particular problem, or trying to source a replacement for something you already have? Take a photo and text it through to **0499 372 662** or email it to **info@hipac.com.au**. Hipac's Customer Service Team will review your enquiry promptly and a consultant will be in contact with some options for you to consider.

## Project Services - Fitout and Installations

Have you seen the product or solution you need within this catalogue, however require assistance having it installed in your facility? Installers and tradespersons with experience working inside active mental health facilities can be hard to come by. Hipac has a network of experienced contractors and it's own installation teams that can be coordinated to facilitate installations at any health facility nationally. Hipac consultants can also provide technical support for in-house maintenance teams or third party contractors.

## Mental Health Facility Audits

Are you looking for some expert advice or to have your facility audited to assist you in identifying and resolving potential self-harm, ligature and barricade risks? Hipac's team of consultants have extensive experience in identifying risks and providing recommendations for the best ways to overcome these concerns in both new and existing facilities. This can be as simple as advice over the phone, a facility visit, or an audit report with recommended solutions to overcome risks. Hipac's product range is extensive however with experience in mental health facilities, Hipac's consultants can also provide guidance and advice beyond this and put you in touch with other industry experts.



## Product Changes

As we are continually innovating and developing our product range, designs and appearances of products may change without notice.

Colours shown in this catalogue are as accurate as design and printing process allow and may differ due to manufacturing processes.

Dimensions are accurate at time of printing and are subject to change without notice.

Hipac reserves the right to make changes in design, specifications, colours and models for the improvement of any product without notice. Images in this catalogue are for display purposes only and may not reflect the exact appearance of the product.

## Shipping and Claims

Goods are shipped via Hipac's preferred logistics provider whenever possible. Charges will be prepaid and included on the invoice, unless otherwise arranged. Merchandise should be inspected on receipt and contact made with Customer Care regarding any damage or discrepancies. Damaged shipments must be noted when signing for packages and damaged packaging retained.

## 30 Day Return Policy

If you are not fully satisfied with your purchase, or it is not fit for purpose, you can return it within 30 days and it will be credited on return, following assessment. Returns exceeding 30 days may be considered but are subject to a 20% restocking fee. All returns must be in new, saleable condition. Custom equipment is not returnable. Delivery charges are the responsibility of the purchaser. All returns must be accompanied by a return goods authority document. Please download and complete a Customer Returns Request Form from [www.hipac.com.au/downloads](http://www.hipac.com.au/downloads) before returning your product.

## Disclaimer

Hipac recommends that anyone intending to rely on or use any products displayed in this catalogue should satisfy themselves about the suitability of them for their intended use and that all applicable health and safety standards are met. No responsibility is assumed by Hipac for any incidental or consequential damages resulting from the use of any products sold by Hipac.

## How to Order

Official purchase orders must be placed via phone, fax or email. Contact details are as follows:

Email: [info@hipac.com.au](mailto:info@hipac.com.au)  
Phone: 1800 75 93 93  
Fax: +61 2 4822 7733

## Payment Terms

Account customers:  
Net 14 days on established accounts.

Non account customers:  
Payment required prior to dispatch.

## Payment Options

Pay by phone:  
Mastercard / Visa. Please phone 1800 75 93 93.



Electronic Funds Transfer:  
Account Name: Hipac Healthcare Pty Ltd  
Bank: Westpac  
BSB: 032 721  
Account No: 307 316

Please fax or email confirmation to:  
Fax: +61 2 4822 7733  
Email: [accounts@hipac.com.au](mailto:accounts@hipac.com.au)



Contact Customer Care with any questions you have about any of our products, services or ordering process.

1800 75 93 93  
[info@hipac.com.au](mailto:info@hipac.com.au)  
[hipac.com.au](http://hipac.com.au)

## **ABOUT HIPAC**

We are an Australian healthcare company that guarantees to stand behind all our medical products, both manufactured and imported, because we're here for the life of our products and clients.

PO Box 797, 36 Long St. Goulburn NSW 2580, Australia  
P. +61 2 4823 0000 or 1800 75 93 93  
E. [info@hipac.com.au](mailto:info@hipac.com.au)

SYDNEY | MELBOURNE | BRISBANE | ADELAIDE | PERTH

**[hipac.com.au](http://hipac.com.au)**

ABN 27 600 353 688

ARPPP2191112