

DRY PRESSED BRICKS & PAVERS

COLLECTION 2017

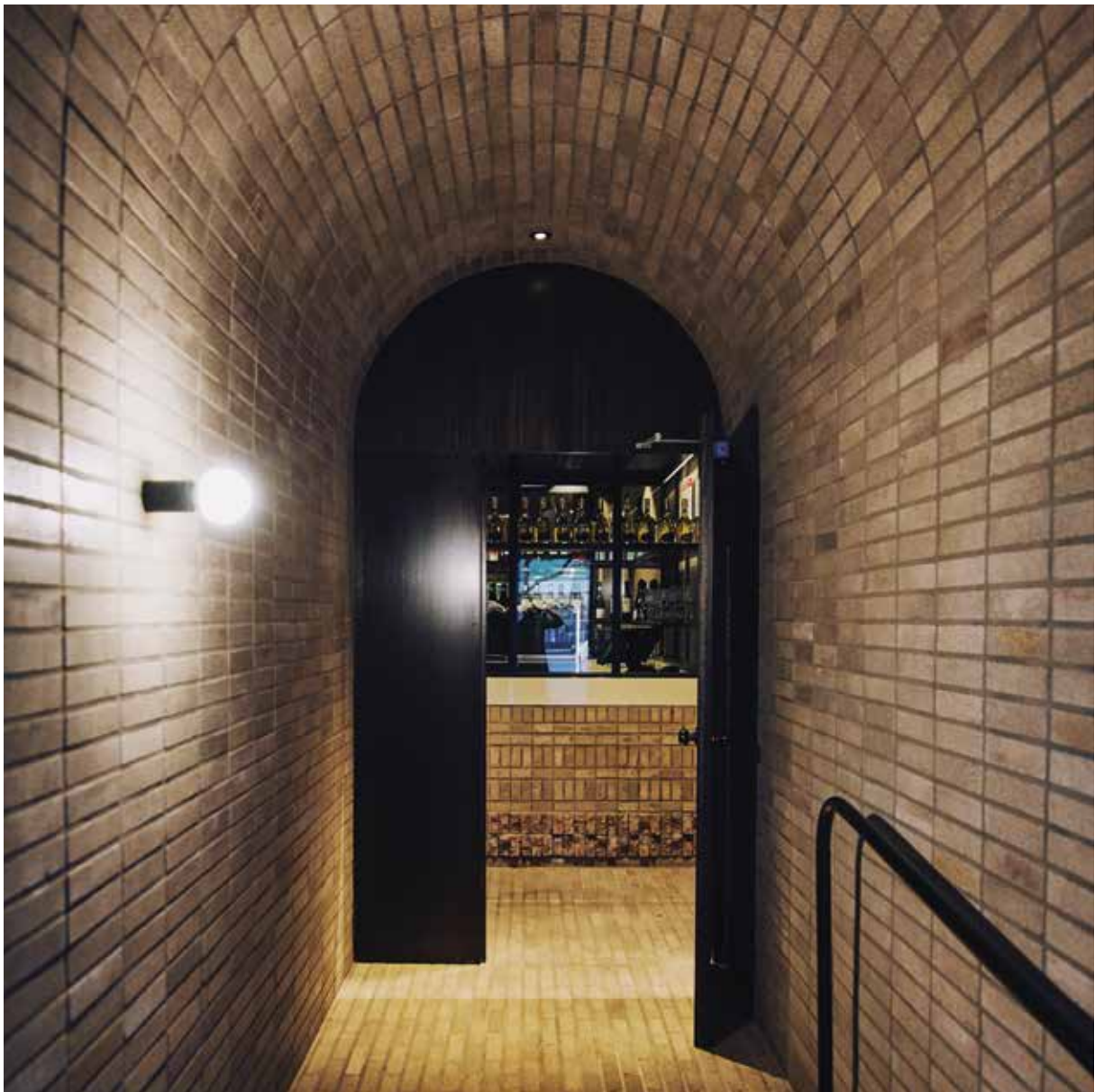

EVERYTHING WE
DO IS IN PURSUIT OF
THE PERFECT BRICK

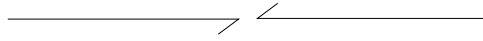

Brahman Granite /Architect: Kavellaris Urban Design (KUD) / Photography: Capital Images
Cover Image: Bowral50 Simmental Silver / Architect: Genesin Studio / Photographer: Brendan Homan

CONTENTS

About Bowral Bricks	5
Dry Pressed Bricks	6
Bowral50	12
Bowral300	16
Bowral Satin	18
Shapes	20
Dry Pressed Pavers	22
London Pavers	24
Hamlet Pavers	26
Technical details	28
We are Brickworks	30

ABOUT BOWRAL BRICKS

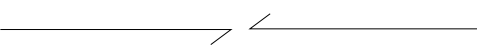

OUR TRADITION, EXPERIENCE AND FINANCIAL STRENGTH HAS MADE BOWRAL BRICKS THE FIRST CHOICE FOR ARCHITECTS, BUILDERS, DEVELOPERS AND HOME BUYERS. OUR CONTINUED COMMITMENT TO QUALITY ENSURES BOWRAL DRY PRESSED BRICKS WILL REMAIN THE BENCHMARK FOR EXCELLENCE FOR MANY YEARS TO COME.

Bowral dry pressed bricks

Bowral dry pressed bricks are the premium product for your building project. Proven in tough Australian conditions for more than a century, dry pressed bricks are renowned for their long lasting quality.

Bowral dry pressed bricks are made to last using time-honoured techniques and modern technology. Choose the Bowral Bricks range for their unsurpassed quality that only one of Australia's largest and most experienced brick makers can offer.

Tradition of timeless quality

Bowral dry pressed bricks have been delivering timeless style and quality throughout the years, Bowral Bricks first began producing this ever- popular range in the early 1900's. Many decades later, Bowral Bricks continues to manufacture dry pressed bricks using traditional craftsmanship techniques at the Bowral manufacturing facility.

The premium building product

Bowral Bricks selects the finest quality clays and shales to create a clay mix, which is compacted into individual moulds at high pressure to produce solid and dimensionally accurate dry pressed bricks. With their solid appearance and square arris, Bowral dry pressed bricks are suitable for face work, rendering, painting, bagging and are perfect for chasing requirements.

The nature of manufacturing provides them with extremely low moisture expansion, therefore offering a very stable building material. Modern technology helps meet nationwide demand for dry pressed bricks designed for today's residential and commercial building applications.

Unique colours for authentic appeal

Earthy terracotta tones. Creamy browns and beiges. Subtle golden shades. With such an extensive colour range available, Bowral Bricks are guaranteed to add a beautiful finish to your building project. The unique colour variations in each delivery of Bowral Bricks also ensures the authentic appeal that comes only with traditional manufacturing techniques.

Shapes to suit your building needs

Bowral dry pressed bricks are available in standard shapes as well as sculptured custom shapes, allowing you to add individuality to both the interior and exterior of your development. Endless design patterns and custom colours make Bowral dry pressed shapes the perfect solution to versatile building design.

Build on our award winning reputation for excellence

Bowral Bricks brings you more than 100 years brick making experience and an unrivalled investment in the brick making technology of tomorrow. Our continued commitment to quality ensures Bowral Bricks will remain the benchmark for excellence for many years to come. Winning the John Horbury Hunt Award for excellence in brickwork many times, emphasises the high standard and quality that is found when using Bowral dry pressed bricks.

Our tradition, experience and financial strength has made Bowral Bricks the first choice for architects, builders, developers and home buyers. For more information or to discuss an upcoming project, please call us on 13 BRICK (13 2742).



Chillingham White / Photographer: Alexander Mayes



BOWRAL DRY PRESSED BRICKS

Bowral50 Simmental Silver / Architect: Genesin Studio / Photographer: Brendan Homan

BOWRAL DRY PRESSED

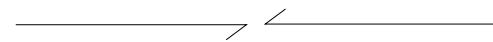

Proven in the harshest conditions, these bricks offer exceptional structural integrity and longevity, giving you the perfect material for a building that's built to last.



Chillingham White / Architect: Oof! Architecture / Photographer: Nick Granleese

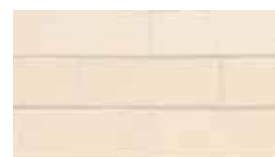

Chillingham White



Simmental Silver



St. Pauls Cream

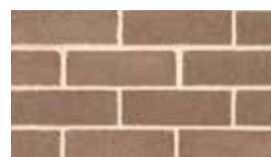

Murray Grey



Hereford Bronze



Capitol Red



Shorthorn Mix

Dimensions

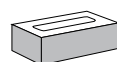

230 L x 110 W x 76 H mm

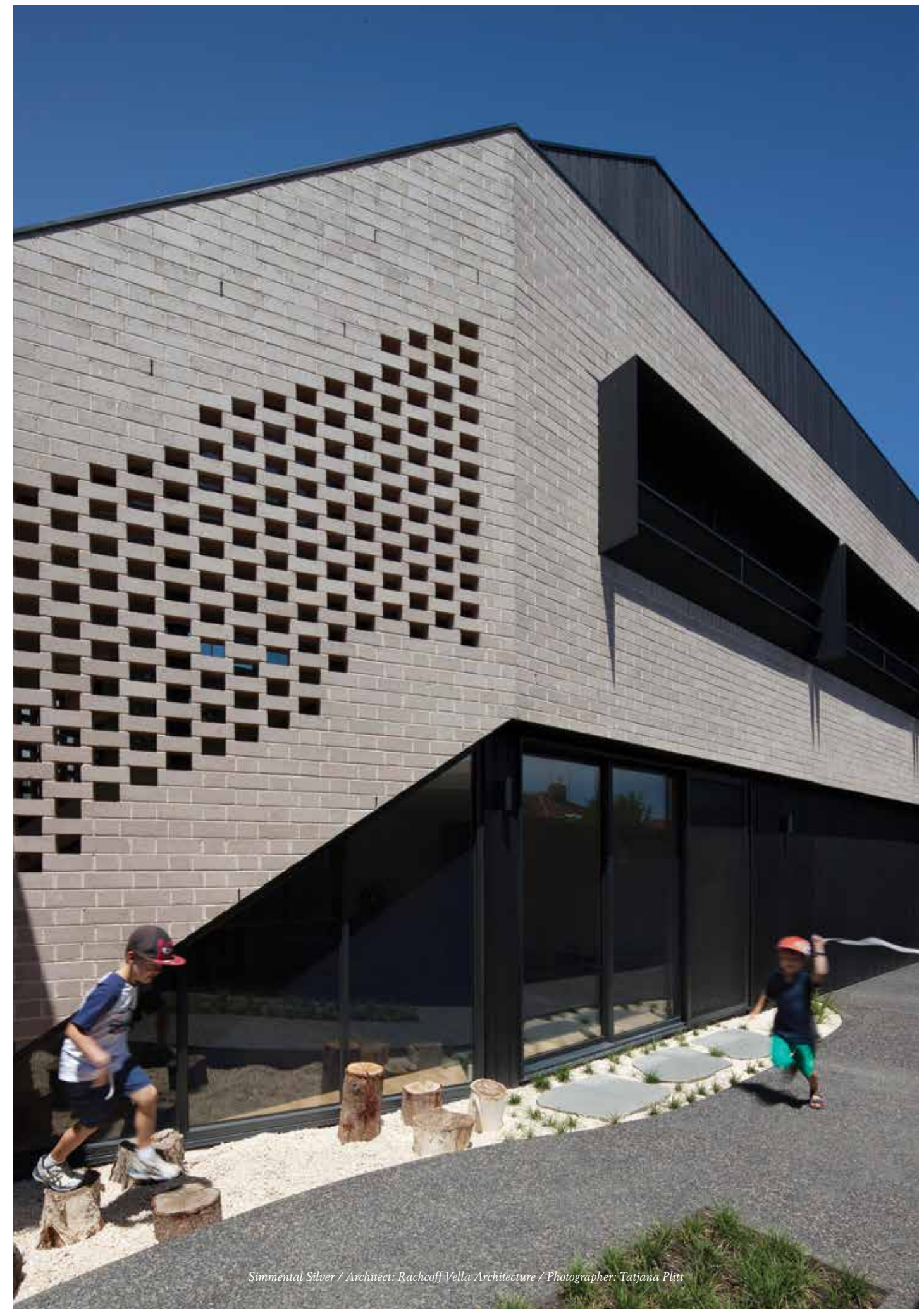

Simmental Silver / Architect: Rachcoff Vella Architecture / Photographer: Tatjana Plitt

BOWRAL DRY PRESSED



Bowral Brown / Photographer: Alexander Mayes



Limousin Gold



Bowral Brown



Gertrudis Brown



Renovation Gertrudis Brown



Brahman Granite



Bowral Blue

Dimensions

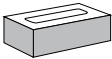

230 L x 110 W x 76 H mm



BOWRAL DRY
PRESSED
STANDARD BRICK
RANGE IS
ANYTHING BUT
ORDINARY

- 1. Brahman Granite / Architect: Kavellaris Urban Design (KUD) / Photography: Capital Images
- 2. Bowral Blue / Architect: Turner Studio / Photographer: Brett Boardman
- 3. Murray Grey / Architect: Smart Design Studio / Photography: Alexander Mayes

BOWRAL50

The sleek, low profile Bowral50 was our response to contemporary design trends and offers architects and builders a greater range of versatility.





Chillingham White



Simmental Silver



St. Pauls Cream



Murray Grey



Limousin Gold



Bowral Brown



Dimensions
230 L x 110 W x 50 H mm

1. Bowral50 Chillingham White / Architect: Grieve Gillet Andersen / Photographer: Sam Noonan
2. Bowral50 Chillingham White / Architect: Inarc Architects / Photographer: Peter Clarke Photography
3. Bowral50 Simmental Silver / Architect: Blight Rayner in collaboration with Twofold Studio / Photographer: Christopher Frederick Jones



Bowral50 Gertrudis Brown / Architect: Klopper and Davis Architects / Photographer: Dion Robeson

BOWRAL50

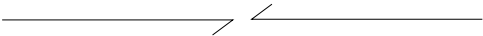

Bowral Blue and Bowral50 Blue / Architect: Wilson Architects



Shorthorn Mix



Gertrudis Brown



Capitol Red



Renovation Gertrudis Brown



Brahman Granite



Bowral Blue

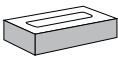

Dimensions
230 L x 110 W x 50 H mm

BOWRAL300

When your project deserves something even more special, the low profile and extra length of the Bowral300 range answers your needs.



Bowral300 Bowral Blue / Designer: Danny Ciarma / Photographer: Roger du Buisson

	
Chillingham White	Bowral Brown
	
Simmental Silver	Shorthorn Mix
	
St Pauls Cream	Gertrudis Brown
	
Murray Grey	Limousin Gold
	
Brahman Granite	Bowral Blue
	
Capitol Red	Renovation Gertrudis Brown

Dimensions
300 L x 110 W x 50 H mm
Note – This product is made to order

BOWRAL SATIN

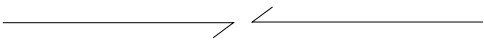

Bowral dry pressed bricks have been delivering timeless style and quality throughout the years. This style has now been raised to a new level with the arrival of the Bowral Satin collection. Available in the original brick size and in the full array of Bowral colours, this smooth, polished finish will offer your project a unique and stunning look.



Chillingham White



Simmental Silver



Hereford Bronze



Capitol Red



Brahman Granite



Bowral Blue

*Note – All Bowral Satin products are made to order.
The Bowral Satin finish is available in all Bowral colours. Above colours are for initial indication only.*



BOWRAL SHAPES

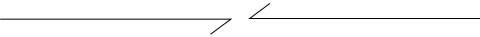

For the complete range of dry pressed shapes, please view our *Special Shapes brochure*
or visit us at www.bowralbricks.com.au

Bullnose Bricks

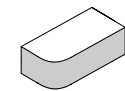

Single Bullnose

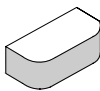

Double Bullnose

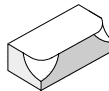

Double Bullnose Stop

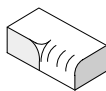

Single Bullnose Long
Internal Return Left

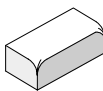

Double Bullnose
Internal Return

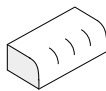

Bullnose Stretcher

Cant Bricks

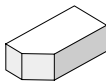

Single Cant
(Standard Shape)



Double Cant
(Standard Shape)

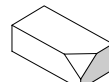

Single Cant Stop Left

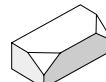

Double Cant Stop



162 Single Cant

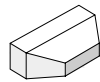

Double Cant Return

Plinth Bricks

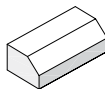

Plinth Stretcher

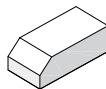

Plinth Header

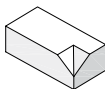

Plinth Short Internal
Return Left

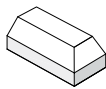

Single Plinth External
Return Left

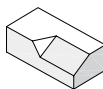

Plinth Long Splay
Stop Left

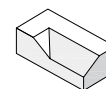

Plinth Long Internal
Return Left

Squints and Miscellaneous



Squint
(Standard Shape)

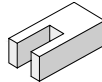

Conduit

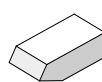

Squint 60 Degree



Pistol



BRK-2 Half Batt

Sculptured Bricks

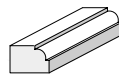

Sculptured Plinth
Ovolo Stretcher

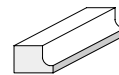

Sculptured Plinth
Scotia Stretcher

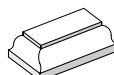

Sculptured Plinth
Double Return

Culverts and Radials



Plinth Stretcher

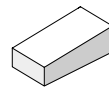

Plinth Header

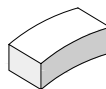

Plinth Short Internal
Return Left

Limousin Gold
UTS Dr Chau Chak Wing Building
Architect: Gehry Partners & Daryl Jackson Robin Dyke
Photographer: Jacqui Dean



BOWRAL DRY PRESSED PAVERS

London Brahman Granite, Chestnut, Maple, Regency Grey & Silver Sand / Architect: Rush Wright Associates / Photographer: John Collings

LONDON PAVERS

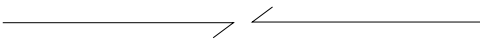

Make your outdoors a little greater. Bowral dry pressed pavers offer the quality and durability of our dry pressed bricks, to transform your outdoor courtyard or landscaping. This very versatile paving solution comes in an extensive colour palette, for endless design possibilities.



1. London Chestnut / Architect: PTW Architects / Photographer: Jacqui Dean
2. London Brahman Granite
3. London Maple / Architects: Marcus Collins Architects / Photographer: Jacqui Dean



Silver Sand Regency Grey Maple



Chestnut Brahman Granite

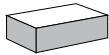

Dimensions
230 L x 114 W x 65 H mm

HAMLET PAVERS

The Hamlet paver collection will set your project apart. Whether they be used indoors or out, this architecturally inspired special sized paver produced in the renowned Bowral colours is in a class of its own.

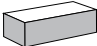

1 & 3. Hamlet Blue / Architect: Turf Design Studio with Jeppe Aagaard Andersen / Photographer: Alexander Mayes
2. Hamlet Sepia

 **Dimensions**
230 L x 76 W x 65 H mm
Note – This product is made to order

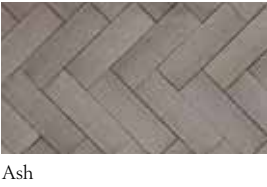

TECHNICAL

details

Mortar colour | Mortar finishes

Mortar Colour

Off-white mortar is currently the most popular colour. This is made by mixing light coloured cement and white sand and results in a traditional bricks and mortar look. Mortar can be coloured by adding powdered or liquid pigments to the mortar as it is being mixed by the bricklayer. It can also be tinted to match the brick colour, giving a very even wall colour. Please confirm with your bricklayer what their mortar colouring offering is before making your final decision.

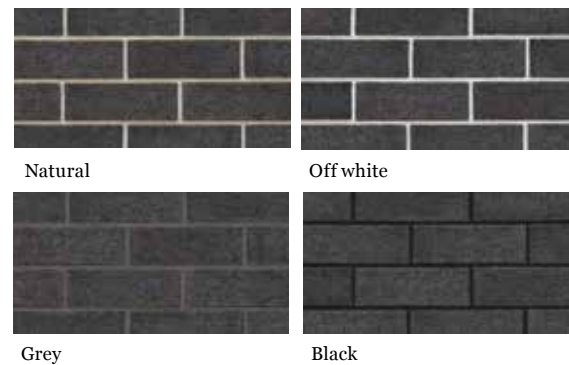

Mortar finishes

There are four common mortar finishes and these various finishes result in different shadow lines on the wall. A raked finish will create a deep shadow in the mortar joint. This brings out the horizontal lines of the brickwork (and the vertical lines to a lesser extent) and it is the most common finish. Ironed and rolled joints also create shadow lines, but these are much finer and more subtle. A flush joint doesn't allow shadow lines to form at all, giving the wall a flatter, more unified look. Using a mortar colour to match the brick will take this a step further.

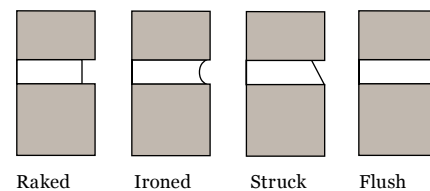

DURABILITY

and solar rating

Brick range durability

Bowral Bricks	Bowral Bricks	Bowral Bricks
Chillingham White EXP / L	Bowral Brown EXP / M	Shorthorn Mix EXP / M
St Pauls Cream EXP / L	Murray Grey EXP / M	Capitol Red EXP / M
Simmental Silver EXP / M	Hereford Bronze EXP / M	Brahman Granite EXP / D
Limousin Gold EXP / M	Bowral Blue EXP / D	Renovation Gertrudis Brown EXP / D
Gertrudis Brown EXP / D		

Paver range durability

London	Hamlet
Brahman Granite EXP	Blue EXP
Silver Sand EXP	Ash EXP
Regency Grey EXP	Sepia EXP
Maple EXP	
Chestnut EXP	

EXP = Exposure grade

Suitable for use in external walls exposed to aggressive environments, such as; areas subjected to salts in the soil, adjacent material or ground water, in coastal areas exposed to attack from windborne salt spray, or retaining walls subjected to fertilisers and ground salts.

GP = General purpose

Suitable for internal and external walls only when above a sheet or membrane damp-proof course and protected by an adequate coping, eaves, roof or similar top covering. These units should not be directly exposed to saline environments.

Solar absorbance rating

In the design of energy efficient buildings, the architects and consulting engineers need to be able to calculate the heat loss or gain of materials used to construct these buildings.

For this reason, our product range has been categorised into three colour groups –

Light (L) < 0.475 Light,

Medium (M) 0.475 - 0.70 Medium,

Dark (D) > 0.70 Dark

to assist architects and consulting engineers with their calculations.

All information was correct at time of printing. For current details, please visit australbricks.com.au



style with substance

WE ARE

Brickworks

Brickworks Building Products is one of Australia's largest and most diverse building material manufacturers. Under the Brickworks Building Products umbrella are some of Australia's best known building materials brands. Our products include bricks, pavers, masonry blocks, retaining wall systems, precast concrete panels, concrete and terracotta roof tiles, timber products, terracotta façades and specialised building systems.

With a broad product portfolio and manufacturing and sales facilities across Australia, Brickworks Building Products is uniquely placed to service the demands of the building industry.

With over 1200 staff across Australia and New Zealand, we pride ourselves on our commitment to product, service excellence and our leadership position.

BRICKWORKS
BUILDING PRODUCTS

australbricks
SINCE 1908

australmasonry

australprecast

auswesttimbers

bristiler roofing

BOWRAL BRICKS

nubrik
AUTHENTIC ENICKWORK



terracade
TERRACOTTA FAÇADE SYSTEMS

INEX > BOARDS

Pronto Panel

Proud Supporters



*Bowral50 Simmental Silver
Architect: Blight Rayner in collaboration with Twofold Studio
Photographer: Christopher Frederick Jones*



follow brickworks building products on



CAMPBELLFIELD: 1596 Sydney Rd
GREENSBOROUGH: 297 Diamond Creek Rd
MORDIALLOC: 80 Governor Rd
TAYLORS LAKES: 31A Melton Hwy

Ph: 9359-6028 Fax: 9359-6911
Ph: 9434-6744 Fax: 9434-6455
Ph: 9580-1080 Fax: 9580-1732
PH: 9390-8100 Fax: 9390-9180

DESIGN STUDIOS

Sydney CBD

Ground Floor
50 Carrington
Street, Sydney
NSW 2000

Melbourne

490 Swan Street
Richmond
VIC 3121

Adelaide

Ground Floor
70 Hindmarsh
Square, Adelaide
SA 5000

Brisbane

27 James Street
Fortitude Valley
QLD 4006

Perth

67 King Street
Perth
WA 6000

Hobart

9 Franklin Wharf
Hobart
TAS 7000

The product images in our brochures give a general indication of colour for your preliminary selection.
We also recommend you view current product samples before making your final decision.