

FACT SHEET

XCH-300 Series – Utility Cables

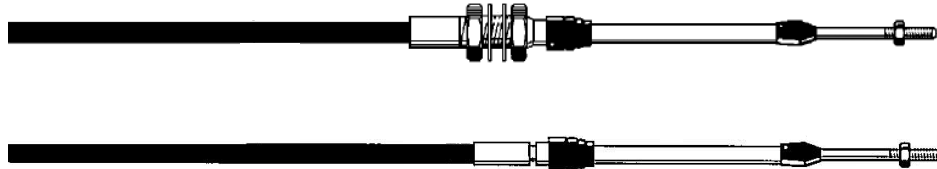
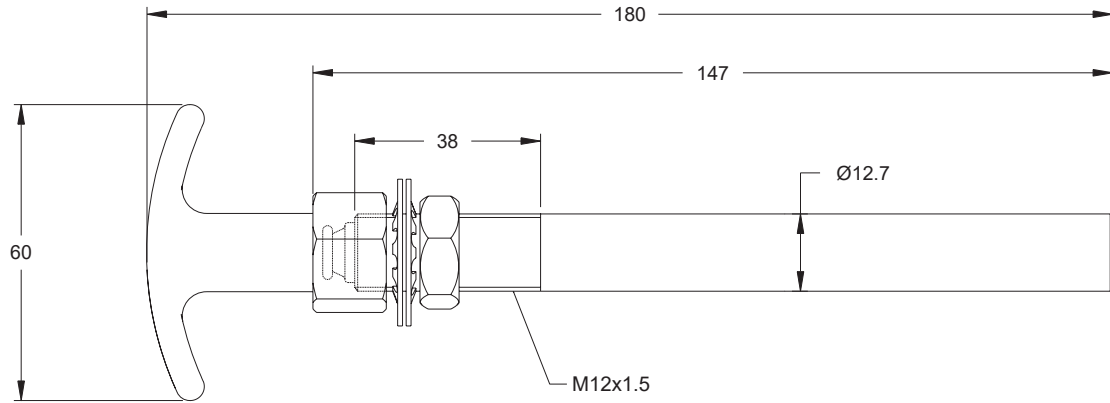

Please refer to Version 3 cable end dimensions for 50mm & 75mm cable travels on the bulkhead and clamp configurations

Cable Family	Cable Rod	End Type	Travel	Standard Base Part No.
XCH-300	10-32 unf	Threaded	50mm	366
XCH-300	10-32 unf	Grooved	50mm	368
XCH-300	10-32 unf	Threaded	75mm	366
XCH-300	10-32 unf	Grooved	75mm	368

XCH-300 Accessories	
Part Number	Product Identity
K3	Clamp and Shim Assembly
K10	Stainless Steel Pivot
21410	Clevis
21203	Stainless Steel Ball Joint

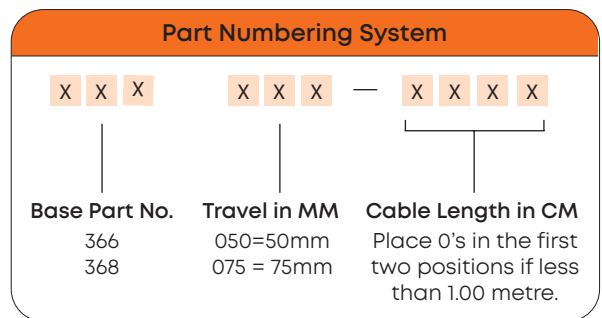

Key Features

- Uses Version 3 EDGE Conduit for more flexible cable
- Red 'T' handle for high visibility
- Built to custom lengths

Cable Measurement

- When measuring a XCH-300 cable with a rod and sleeve, measure from the base where the "T" handle mounts to the tip of the rod and round up to the nearest 250mm increment.
- Example 366075-0100 XCH-300 cable with clamp hub 75mm travel 1.00 overall length